

Utah Valley University

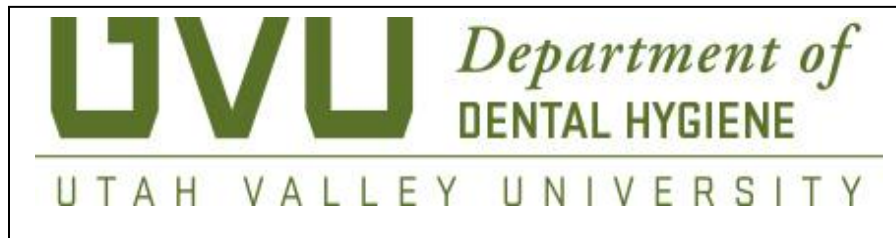

Exam Site Information for Candidates
Western Regional Examining Board (WREB)
2022 WREB Hygiene Examination

Utah Valley University
West Campus Health Professions Building
HP 141, 951 S. Geneva Road; Orem, Utah 84045
801-863-7608

Exam Site Information for Candidates
2022 WREB Dental Hygiene & Local Anesthesia Examinations

Table of Contents

1. School Facility and Services

- Clinic Address, Building Access and Hours
- Parking
- Security and Emergency Services
- ATM Machine
- Food Services Onsite

2. Preparing for the Exam

- Patient Screening
- Radiographs
- Administration of Local Anesthetic – Practitioner Availability
- Dental Operatory Units
- Equipment, Instruments and Expendable Materials
- Sterilization Services

3. During the Exam

- Infection Control (Surface Asepsis)
- Medical Emergencies and Equipment

4. Travel and Lodging Information

- Airport Information
- Ground Transportation
- Hotel Accommodation

5. Campus Map

6. Clinic Floor Plan

7. Required School-provided Expendable Dental Materials Appendices

1. School Facility and Services

- **Location, Building Access and Hours:** : UVU Dental Hygiene Clinic is located on the UVU West campus, in the Health Professions building, room 142. The address is 987 Geneva Road, Orem Utah. Directions to Clinic entrance; From HWY 1-15, take exit #269 - University Parkway in Orem. Go west to Geneva road, then turn right. Go to W 1000 S and into the parking lot of the HP Building. The Dental Hygiene Clinic is in the northwest corner of the building.
- **See Map**
<https://www.uvu.edu/maps/map.html?id=382#!ct/18632?mc/40.28060608317338,-%20%20%20%20111.72737896442413?z/18>
- For questions regarding the school and equipment, please contact Janele Williams: 801- 863-7536. Building will be open from 6:00am-6:00pm daily for duration of exam.
- **Parking:** You may park anywhere around the building, with a free pass that will be given you at the front desk of the UVU Clinic. Parking is available from 6am to 6pm.
- **Security and Emergency Services:** In case of an emergency, you may contact the UVU campus police at 801-863-5555, or the Orem Police Department at 801-229-7070.
- **ATM Machine:** There are no ATM machines on the west campus, but there are various ATM's on main campus: Wolverine Service Center, Nuvi Basketball Center, and Noorda Theatre and Box Office. There is also an ATM at Mike's Chevron Station on the corner of Geneva and University Parkway.
- **Food Services Onsite:** UVU west campus has no food services, but there are vending machines with beverages and snacks. There are also many fast-food establishments and restaurants within ½ a mile all around the campus, on Geneva Road and University Parkway.

2. Preparing for the Exams

a. Hygiene Exam

- **Patient Screening:** Candidates are permitted to make an appointment at the UVU Dental Hygiene Clinic to screen potential patients and to take x-rays for the exam. The clinic will be available from 6am to 6pm during the days of the UVU WREB exam, and the afternoon and evening the night before the initial start day. Please contact the clinic manager at 801-863-7608 to make an appointment, as chair space is limited.
 - **Radiographs:** Digital x-rays will be available, with a \$4.00 charge per film if needed. Please provide your own XCP kit if possible.
 - **Administration of Local Anesthetic:** A Practitioner from Utah Valley University faculty will be available to provide administration of local anesthesia to Candidate patients if needed.
 - **Equipment, Instruments and Expendable Dental Materials:** Refer to the respective WREB Candidate Guide for a list of materials and armamentarium that the Candidate must provide.
- A. Handpiece and Prophy Angle Hookups:** Candidates should bring their own slow speed handpiece. The clinic has A-Dec dental units, and an A-Dec two-hole, two pin slow speed handpiece connection. No quick connect plugs or hoses are available.

- B. **Sonic/Ultrasonic Devices:** The clinic is equipped with Dentsply Ultrasonic units that will be available in each operatory at no charge. You may bring a 30K Cavitron tip, for your own use, or rent one for \$10 cash through the clinic.
 - C. **Air/Water Syringe Tips:** Disposable air/water syringe tips will be available to use with the dental unit, with extra tips on the supply table.
 - D. **Blood Pressure Cuffs and Stethoscopes:** Candidates will need to provide their own blood pressure cuff and stethoscope. The site does not provide these items.
 - E. **Expendable Materials:** Expendable dental materials supplied by the school are noted in *Appendix A*.
- **Sterilization Services:** Sterilization services will be available each day from 6am to 5pm.
- b. **Local Anesthesia Exam, if applicable**
 - **Equipment, Instruments and Expendable Dental Materials:** Refer to the respective WREB Candidate Guide for a list of materials and armamentarium that the Candidate must provide.
 - A. **Air/Water Syringe Tips:** Disposable Air/water syringe tips will be available to use with the dental unit, with extra tips on the supply table.
 - B. **Expendable Materials:** Expendable dental materials supplied by the school are noted in *Appendix B*.
 - **Sterilization Services:** Sterilization services will be available each day from 6am to 5pm.

3. During the Clinical Exam

- 4. **Dental Operatory Units:** : Each operatory is equipped with one ADEC 411 chair, one delivery unit equipped with two air/water syringes, high volume suction and low volume suction, one high speed hookup and one slow speed hook up.

5. Infection Control (Surface Asepsis):

- a. • Handles of the unit light, x-ray heads, and air-water syringes may be covered with plastic wrap provided on cart.
 - b. • The patient chair must be disinfected with OPTIM 33TB-Wipes at each unit.
 - c. • Plastic chair barriers and plastic covers are provided. Disinfecting spray and wipes are available in each operatory.
 - d. • Disposable plastic over gloves are available for candidates on cart.
 - e. • A staff member will be in the sterilization room to process all contaminated instruments
- A. **Hazardous Waste Disposal (exam-type specific):**
 - **Hygiene:** Any blood/saliva soaked waste is considered hazardous and must be disposed of in red biohazard bags (available on the supply cart). Biohazard bags School Name Page 5 of 8 may be attached to the dental unit with tape. At the

end of the session, this bag should be brought to the sterilization area, where it will be placed in biohazard waste containers.

- **Local Anesthesia:** Any blood/saliva soaked waste is considered hazardous and must be disposed of in red biohazard bags (available on the supply cart). Biohazard bags may be attached to the dental unit with tape. At the end of the session, this bag should be brought to the sterilization area, where it will be placed in biohazard waste containers

B. Sharps Disposal: All needles, anesthetic cartridges and any other disposable sharps are to be placed in the red plastic sharps containers located in each operatory on the countertop area.

6. Emergency Medical Equipment: All necessary emergency equipment is located in the instructor grading area, which will be pointed out during the clinic tour. This includes oxygen, AED, first aid kits, ice packs, etc.

7. Travel and Lodging Information

Airport Information: There are two airports close to UVU. Salt Lake International, and Provo Municipal Airport – 3421 Mike Jense PKWY, Provo.

• **Ground Transportation** to and from SLC Airport:

For non-peak drive hours, expect a minimum drive time of approximately 60 minutes/peak drive time may be an hour +. Transportation methods available at the airport include but are not limited to:

1. Shuttle Bus

Express Shuttle 1-800-397-0773 www.expressshuttleutah.com
(\$25 for first person, \$10 for each additional in the same group, maximum of 7 people one way/ Hotel drop off rates may vary/ Reservations required 24 hrs. in advance)

2. Taxi Service

Approximate one-way cab fare (without tip) is \$45.00 Yellow Cab 1-801-521-2100 www.yellowcabutah.com AAA Cab Co. 1-801-641-4964
City Cab Co. 1-801-363-5550

3. Rental Car: Salt Lake is served by many major car rental companies:

Alamo 1-888 426-3299 Budget 1-800-237-7251 Hertz 1-800-654-3131
Avis 1-800-831-2847 Enterprise 1-800-736-8222 Thrifty 1-800-847-4389

• **Hotel Accommodations:** A list of suggested area hotels for Candidates are provided:

La Quinta Inn & Suites - 1100 W. 780 North, Orem, UT 84057 Phone: 801-235-9555

Courtyard by Marriott - 1600 N Freedom (200 West) Boulevard, Provo, Utah 84604
Phone: 1-801-373-2222 or Fax: 1-801-374-2207

Comfort Inn and Suites - 427 West University Parkway Orem, UT 84058
Phone: 801-431-0405

Hampton Inn & Suites - 851 West 1250 South, Orem, UT 84058
Phone: 1-801-426-8500 or Fax: 1-801-426-8700

8. Campus Map:
UVU Campus Map

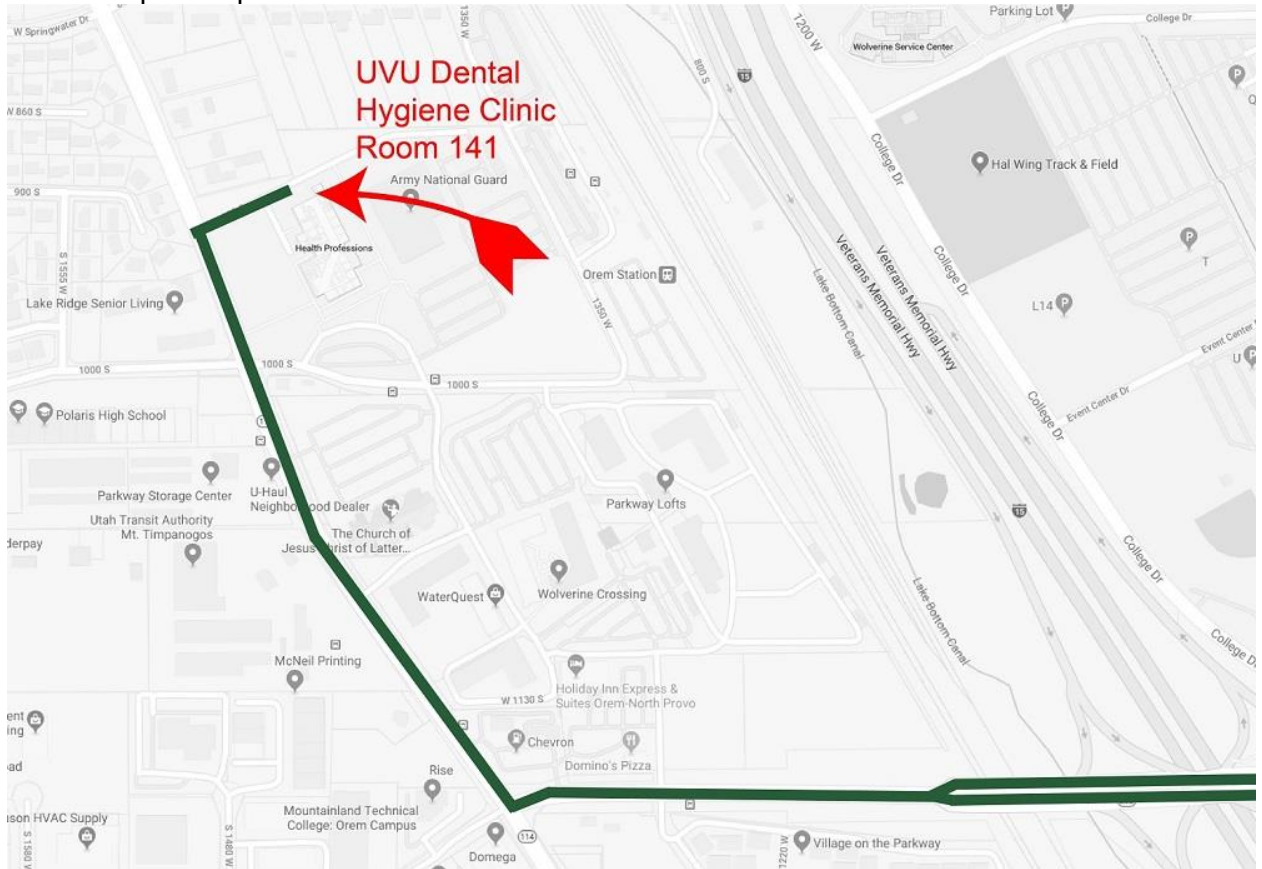

UVU Parking Map Link:

<https://www.uvu.edu/maps/main/?id=382#!ct/18632,18577,18620,18578,18593,18598,18601,18602,18603,18604,18606,18608,18611,18614,18617,18618,18619,18579,18599,18605,18607,18609,18610,18612,18613,18621,38567,18724,21138,21139,21140,28284,18733,18738,18743,42799,1950?ce/1950?mc/40.27930467283951,-111.71673059463502?z/16>

9. Clinic Floor Plan: Indicate Patient waiting area, Candidate clinic, Examiner grading area, areas of emergency equipment

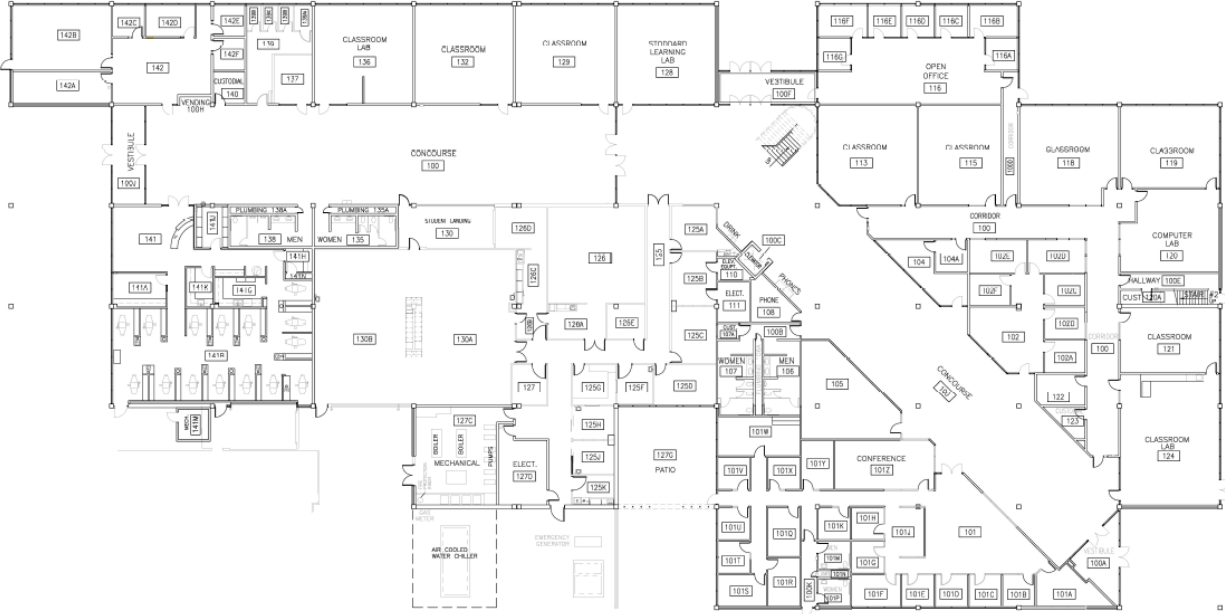

LEVEL 1
HEALTH PROFESSIONS

Required School-provided Expendable Dental Materials Appendices

APPENDIX A – Expendable Dental Hygiene PATIENT BASED Materials List Provided by Exam Site Host (School) To be provided in sufficient quantities for all Dental Hygiene Candidates		
2x2 gauze squares	Cotton-tip applicators	Patient bib clips, disposable
Air/water syringe tips	Drinking cups	Patient napkins/bibs
Antimicrobial mouthwash	Face masks	Prophy paste
Anesthetic(s)	Facial tissue	Sanitizing materials
<ul style="list-style-type: none"> Local anesthetic(s) with and without vasoconstrictors 	Gloves	Soap
<ul style="list-style-type: none"> Topical anesthetic(s) 	<ul style="list-style-type: none"> Gloves, nonlatex (S,M,L,XL) 	Standard saliva ejectors
Autoclave bags, small	<ul style="list-style-type: none"> Overgloves 	Surface disinfectant
Autoclave bags, medium	Headrest covers	Syringe Needles (long & short)
Autoclave tape	Instrument trays, disposable	Tray covers
Barrier covers/tape	Paper towels	Trash bags

APPENDIX A – Expendable Dental Hygiene MANIKIN Materials List Provided by Exam Site Host (School) To be provided in sufficient quantities for all Dental Hygiene Candidates		
2x2 gauze squares	Facial tissue	Sanitizing materials
Air/water syringe tips	Gloves, nonlatex (S,M,L,XL)	Soap
Autoclave bags, medium	Headrest covers	Surface disinfectant
Barrier covers/tape	Instrument trays, disposable	Tray covers
Face masks	Paper towels	Trash bags
	Rod Posts (mounting typodont)	

APPENDIX A – Expendable Dental Hygiene OSCE Materials List Provided by Exam Site Host (School) To be provided in sufficient quantities for all Dental Hygiene Candidates		
Masks	Gloves, nonlatex (M,L)	Paper towels
Facial tissue	Surface disinfectant materials	

APPENDIX B – Expendable Local Anesthesia Materials List Provided by Exam Site Host (School) To be provided in sufficient quantities for all Local Anesthesia Candidates		
2x2 gauze squares	Cotton-tip applicators	Patient bib clips, disposable
Air/water syringe tips	Drinking cups	Patient napkins/bibs
Antimicrobial mouthwash	Face masks	Sanitizing materials
Anesthetic(s)	Facial tissue	Soap
<ul style="list-style-type: none"> Local anesthetic(s) with and without vasoconstrictors 	Gloves	Standard saliva ejectors
<ul style="list-style-type: none"> Topical anesthetic(s) 	<ul style="list-style-type: none"> Gloves, nonlatex (S, M,L,XL) 	Surface disinfectant
Autoclave bags, small	<ul style="list-style-type: none"> Overgloves 	Syringe Needles (long & short)
Autoclave bags, medium	Headrest covers	Tray covers
Autoclave tape	Instrument trays, disposable	Trash bags
Barrier covers/tape	Paper towels	