

SOUTHWESTERN COLLEGE



**Exam Site Information for Candidates
Western Regional Examining Board (WREB)
2021 WREB Hygiene Examination**

**SOUTHWESTERN COLLEGE
HIGHER EDUCATION CENTER AT NATIONAL CITY
DENTAL HYGIENE PROGRAM
880 NATIONAL CITY BLVD, NATIONAL CITY CA
(619) 216-6665 EXT. 6670**

Exam Site Information for Candidates
2021 WREB Dental Hygiene Examinations

1. School Facility and Services

- **Location, Building Access and Hours:** Southwestern College Higher Education Center at National City is located at 880 National City Boulevard in National City, California. Dental Hygiene Clinic is located on the 2nd Floor, Room 7217. Building is open 6:00am-6:00pm daily for duration of exam.

Contact Southwestern College Dental Hygiene Program Director Gay Teel (619-216-6670) directly with questions regarding school services.

- **Parking:** Parking structure is located right behind the Higher Education Center on Roosevelt Avenue. Contact Gay Teel (619-216-6670) for parking fees information.
- **Security and Emergency Services:** Contact Gay Teel (619-216-6670) for this information.

2. Preparing for the Hygiene Exam

- **Patient Screening:** Contact Gay Teel (619-216-6670) regarding clinic availability.
- **Radiographs:** Candidates are required to provide their own x-rays for this exam. Southwestern College has digital radiography available for emergency use only.
- **Sterilization Services:** Southwestern College does not provide onsite sterilization services.
- **Equipment, Instruments and Expendable Dental Materials:** Refer to WREB Candidate Guide for a list of materials and armamentarium that the Candidate must provide.
 - A. Hand piece and Prophy Angle Hookups:** Two Hole Coupler and Midwest RDH handpiece. Contact Gay Teel (619-216-6670) regarding availability.
 - B. Sonic/Ultrasonic Devices:** WREB allows the use of sonic/ultrasonic devices as an adjunct to calculus removal. All operatories are equipped for hookup of the following compatible devices: Cavitron, Swerv, Piezo. Southwestern College does not have equipment available for loan or rent at this time.
 - C. Air/Water Syringe Tips:** Syringe tips are disposable.
 - D. Blood Pressure Cuffs and Stethoscopes:** Candidates must provide their own blood pressure cuffs or stethoscopes. Southwestern College does not have equipment available for loan or rent.
 - E. Expendable Materials:** Expendable dental materials supplied by the school are noted in **Appendix A** (items not listed are responsibility of Candidate).

APPENDIX A – Expendable Dental Hygiene Materials List Provided by Exam Site Host (School) To be provided in sufficient quantities for all Dental Hygiene Candidates		
2x2 gauze squares	Cotton-tip applicators	Paper towels
Air/water syringe tips	Drinking cups	Patient bib clips, disposable
Hydrogen peroxide rinse	Face masks	Patient napkins/bibs
Anesthetic(s)	Facial tissue	Prophylaxis paste
• Local anesthetic(s)	Gloves	Sanitizing materials
• Topical anesthetic(s)	• Gloves, non-latex (S,M,L,XL)	Soap
Autoclave bags, small	• Over gloves	Standard saliva ejectors
Autoclave bags, medium	Headrest covers	Surface disinfectant
Autoclave tape	Instrument trays, disposable	Tray covers
Barrier covers/tape	Syringe Needles	Trash bags

3. During the Clinical Exam

- **Dental Operatory Units:** A-Dec 1021 Decade (Chair), A-Dec delivery system 2122 Cascade
- **Infection Control (Surface Asepsis):** Refer to OSHA clinical asepsis protocols pertinent to the exam (i.e. dental unit, countertops, patient chair, light handles, etc.); additional information provided at exam site.
 - A. Hazardous Waste Disposal:**
 - **Hygiene:** Refer to OSHA clinical procedure for disposal of blood/saliva-soaked waste; additional information provided at exam site.
 - B. Sharps Disposal:** Sharps containers are located throughout the clinic.
- **Emergency Medical Equipment:** Oxygen is available at Chairs 1 and 13. The AED is located in clinic as well as first aid kit.

COVID 19 UPDATE: Candidates must be fully vaccinated against COVID-19 and must have finished the series at least 2 weeks prior to exam day. A current vaccine card - showing 2 doses, or 1 dose with J&J - will be required upon entrance. If a Candidate has not been fully vaccinated, a negative Covid test within 72 hours of arrival will be required.



HEC 1ST FLOOR

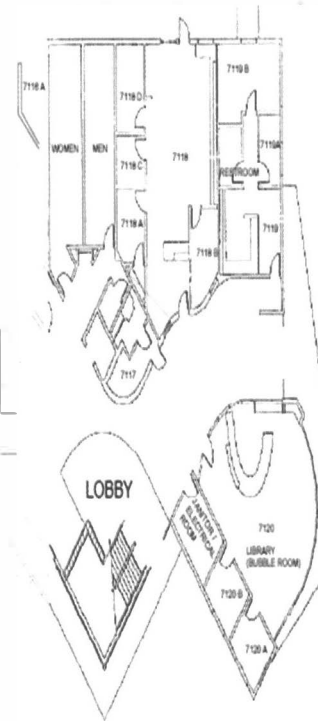

**Covid-19 Screening
Entrance/Exit**

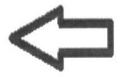

HEC 2ND FLOOR

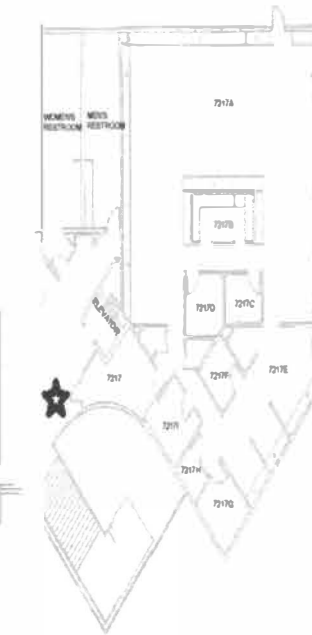

**SWC DH Clinic
Entrance**

