

Lake Washington Institute of Technology

Updated WREB Host Site Information - 2021 Local anesthesia, Dental Hygiene Clinical and Restorative Exams

The information in this document will supersede previously distributed information in the Exam Host Site Information packet.

**School Coordinators: Carrie Sasynuik: carrie.sasynuik@lwtech.edu
425-739-8157 campus phone line**

The College is working under State of Washington Higher Education guidelines to operate safely due to COVID-19. You must follow the rules set forth by LWTech for the health and well-being of yourself and others. These protocols may change based on the status of public health and state guidance.

Anyone (includes exam candidates) recently visited an area outside of Washington must self-quarantine for 14 days from the day you returned to Washington in order to access the college campus. The only exception to this rule is WREB personnel who resides in states outside of these areas.

Candidates please be mindful of your travel plans and advise your patient accordingly regarding his/her travel plans.

If you spent more than 15 minutes, and less than 6 feet apart, with someone who over the last fourteen days after you were with them developed COVID-19 symptoms and subsequently tested positive, you will not be permitted into the building.

Day before your exam, you need to ask yourself and your patient if you or he/she has any of the following symptoms, and on the day of your exam, the same questions will be asked at the check in area:

- A new **fever** (100.4 F or higher) or a sense of having a fever?
- A new **cough** that you cannot attribute to another health condition?
- New **shortness of breath** that you cannot attribute to another health condition?
- A new **sore throat** that you cannot attribute to another health condition?
- New **muscle aches** that you cannot attribute to another health condition or that may have been caused by a specific activity, such as physical exercise?
- New **respiratory symptoms**, such as sore throat, running nose/nasal congestion or sneezing, that you cannot attribute to another health condition?
- New **chills or repeated shaking with chills** that you cannot attribute to another health condition?
- New **loss of taste or smell** that you cannot attribute to another health condition?

If you or your patient have **ANY** of these symptoms, you or your patient will need to stay home. Anyone who gives a positive response to the questions above will be asked to leave the building.

For contact tracing purposes, everyone that enters the campus will be asked to show their ID and a log of their names, phone numbers, and email addresses will be recorded. This information will be kept confidential by the college and discarded after four weeks.

Facial coverings must be worn by all on campus at all times, except dental patients during dental procedures performed by exam candidates. Masks with valves are not allowed, as they protect you but not others around you.

School Facility and Services

- Only the Allied Health (AH) building door on the 3rd floor (South Parking Lot) will be open during WREB Exams. All other exterior doors will be locked.
- Only college and WREB staff, candidates and their patients are allowed on campus, no other visitors are allowed on campus.
- When inside the building, always wear your face covering and stay 6 feet apart from another person.
- There will be college staff performing the following COVID screening procedures:
 - Checking ID of all LWTech staff, WREB personnel and WREB candidates and patients. Personal info. such as name, email and cell phone # will be recorded. This is for contact tracing in case of exposures.
 - Temperature check and COVID questionnaires
 - Be sure to allow time for this procedure, come a little earlier than your assigned time but not too early as we have limited space in the dental waiting area and social distancing of 6 feet apart will be strictly enforced
- The LWTech campus is closed during the WREB exams, no food services will be available.
- In order to minimize touching surfaces and areas to be sanitized, lingering in college hallways will not be permitted.
- Wash your hands or use hand sanitizer often, available at check in and in the dental clinic.

Preparing for the Dental Hygiene Exam

- Limited Cavitrons are available for use on a first come first served basis, candidates can email the school coordinator to reserve units, we will need candidate #, date and time of your exam. Candidates must supply their own 30K inserts. No Piezo units are available.

- Using HVE is strictly enforced during the use of any aerosol producing devices, such as the ultrasonic and air/water syringe. Neither the Isolite nor saliva ejector alone effectively reduced aerosols and splatter, therefore cannot be a substitution for using the HVE. As much as possible, gross debris and biofilm should be removed manually before ultrasonic scaling.
- An antimicrobial preprocedural rinse will be provided for use before ultrasonic scaling.

Preparing for the Local Anesthesia Exam

- Make sure to bring enough syringes. We cannot guarantee your syringe will be sterilized in time if you have to re-take the exam.

Sterilization Services for all exams

- Your contaminated instruments need to be bagged and marked with your candidate ID#. We can run your instruments through the sterilizer, but we will not run them through the ultrasonic or dishwasher. Please make sure you run your instruments through the proper cleaning steps and re-sterilize them at your location before next use.
- Sterilized instruments may not be ready until the next day.

PPE for Dental Hygiene Exam:

- Candidates are required to bring their own:
 - NIOSH approved qualitative or quantitative fitted N95 Filtering Facepiece Respirators (FFRs) or a qualitative or quantitative fitted FFR that meets the criteria under FDA Emergency Authorization Usage (EUA), appendix A
 - face shields
 - protective eyewear with side shields for yourself and your patient
 - disposable head caps and gowns. If a reusable cap and gown are used, candidate must take off the cap & gown carefully and immediately put into a sealed bag after doffing.
- Gloves will be provided onsite. You can bring your own gloves if you have a preference of a certain type or brand of gloves.
- Donning and doffing of PPE must happen inside each operatory, no contaminated PPE will be allowed outside of the dental clinic.

PPE for Local Anesthesia Exam:

- Candidates are required to bring their own:
 - protective eyewear with side shields for yourself and your patient
 - disposable gowns. If a reusable gown is used, candidate must take off the gown carefully and immediately put into a sealed bag after doffing.
- Gloves and Level 2 mask will be provided onsite for this exam. You can bring your own gloves if you have a preference of a certain type or brand of gloves.

- Donning and doffing of PPE must happen inside each operator, no contaminated PPE will be allowed outside of the dental clinic.

PPE for Restorative Exam:

- Candidates are required to bring their own:
 - protective eyewear with side shields
 - Reusable or disposable gown
- Level 1 or 2 masks will be provided for the restorative exam.
- Gloves will be provided onsite for all exams. You can bring your own gloves if you have a preference of a certain type or brand of gloves.

LAKE WASHINGTON INSTITUTE OF WASHINGTON COVID HEALTH CHECKLIST

Safety Checklist Before Coming to Campus

For all entering campus: If you spent more than 15 minutes, and less than 6 feet apart, with someone who over the last fourteen days after you were with them developed COVID-19 symptoms and subsequently tested positive, you cannot come to campus.

Each time before you come to campus, please fill out and bring this questionnaire to campus. Do you have:

A new fever (100.4 F or higher) or a sense of having a fever? Yes No

A new cough that you cannot attribute to another health condition. Yes No

New shortness of breath that you cannot attribute to another health condition? Yes No

A new sore throat that you cannot attribute to another health condition. Yes No

New muscle aches that you cannot attribute to another health condition or that may have been caused by a specific activity, such as physical exercise? Yes No

New respiratory symptoms, such as sore throat, runny nose/nasal congestion, or sneezing, you cannot attribute to another health condition? Yes No

New or repeated shaking with chills you cannot attribute to another health condition? Yes No

New loss of taste or smell you cannot attribute to another health condition? Yes No

Did you receive a positive COVID-19 test result within the last 14 days? Yes No

Have you traveled outside and/or arrived in WA State within the last 14 days? Yes No

Contact your healthcare provider for advice.

For contact tracing, we will need to keep a log of your phone number and email address. This information will be kept confident and discarded within 4 weeks.

By signing below, I attest to the accuracy of the answers to the above screening questions.

Name (please print): _____

Signature: _____

Email address: _____

Phone number: _____ Date: _____

Lake Washington Institute of Technology



Exam Site Information for Candidates
Western Regional Examining Board (WREB)
2021 WREB Hygiene Examination

Lake Washington Institute of Technology
11605 132nd Avenue NE
Kirkland, WA 98034
425-739-8157

Exam Site Information for Candidates
2021 WREB Dental Hygiene, Local Anesthesia & Restorative Examinations

Table of Contents

1. School Facility and Services

- Clinic Address, Building Access and Hours
- Parking
- Security and Emergency Services

2. Preparing for the Hygiene Exam

- Patient Screening
- Radiographs
- Administration of Local Anesthetic – Practitioner Availability
- Dental Operatory Units
- Equipment, Instruments and Expendable Materials
- Sterilization Services

3. Preparing for Local Anesthesia Exam

- Equipment, Instruments and Expendable Dental Materials
- Sterilization Services

4. Preparing for the Restorative Exam

- Equipment, Instruments and Expendable Dental Materials
- Sterilization Services

5. During the Exam

- Infection Control (Surface Asepsis)
- Medical Emergencies and Equipment

6. Travel and Lodging Information

- Airport Information
- Ground Transportation
- Hotel Accommodation

7. Campus Map

8. Clinic Floor Plan

9. School-provided Expendable Dental Materials Appendices

1. School Facility and Services

- **Location, Building Access and Hours:**

Lake Washington Institute of Technology
11605 132nd Avenue NE, E106, Kirkland WA 98034

Carrie Sasynuik: carrie.sasynuik@lwtech.edu (preferred) or (425) 739-8157

Building Opens: 6:00am-6:00pm daily for the duration of exam

- **Parking:** Any open parking area; no charge for parking
- **Security and Emergency Services:** 425-739-8224 or 9-911

2. Preparing for the Hygiene Exam

- **Patient Screening:** Please note that LWTECH does not have the responsibility of providing examination patients or back-up patients for any candidate. Candidates should not make requests of anyone associated with the college (faculty, staff or administration) for possible back-up patients, patient information, patient consultation, advice, or patient records relating to any patient being considered for the WREB examination. All questions should be directed to appropriate WREB officials. Access to the clinic will only be granted during the official WREB exams
- **Radiographs:** Candidates are welcome to use the x-ray equipment, aiming devices, phosphorous plates, scan x-machine and computer. LWTech personnel will not help take the images. They will assist in assigning a room and have the necessary items ready for image exposure. They will also process the plates through the scan x-machine. It is the responsibility of the candidate to correctly organize the images in the mount on the computer screen. Printing of the images will be done on standard coping paper.
 - There is no additional service charge for this service.
 - Phosphorous plates are an indirect digital radiograph.
- Please wear appropriate clinical attire while in the dental clinic and follow all infection control protocols.

PPE for Dental Hygiene Exam:

- Candidates are required to bring their own:
 - NIOSH approved qualitative or quantitative fitted N95 Filtering Facepiece Respirators (FFRs) or a qualitative or quantitative fitted FFR that meets the criteria under FDA Emergency Authorization Usage (EUA), appendix A
 - face shields
 - protective eyewear with side shields for yourself and your patient
 - disposable head caps and gowns. If a reusable cap and gown are used, candidate must take off the cap & gown carefully and immediately put into a sealed bag after doffing.

Gloves will be provided onsite. You can bring your own gloves if you have a preference of a certain type or brand of gloves.

Donning and doffing of PPE must happen inside the dental clinic, no contaminated PPE will be allowed outside of the dental clinic.

- **Administration of Local Anesthetic:** A qualified practitioner is **NOT** available to administer local anesthetic to Candidate
- **Equipment, Instruments and Expendable Dental Materials:**

A. Handpiece and Prophy Angle Hookups:

Dental Units are Adec brand, handpiece hook-ups are two and four pin, six pin fiber optic handpieces will not work in the units.



- B. Sonic/Ultrasonic Devices:** Limited Cavitrans are available for use on a first come first served basis, candidate needs to email the school coordinator, carrie.sasynuik@lwtech.edu, to reserve a unit. You must include candidate #, date and time of your exam. Candidates must supply their own 30K inserts. No Piezo units are available.

Using HVE is strictly enforced during the use of any aerosol producing devices, such as the ultrasonic and air/water syringe. Neither the Isolite nor saliva ejector alone effectively reduced aerosols and splatter, therefore, cannot be a substitution for using the HVE. As much as possible, gross debris and biofilm should be remove manually before ultrasonic scaling.

An antimicrobial preprocedural rinse will be provided for use before ultrasonic scaling.

- C. Air/Water Syringe Tips:** Air water syringe tips are disposable. Tips are provided for each candidate.
- D. Blood Pressure Cuffs and Stethoscopes:** The Candidate is responsible for providing their own.
- E. Expendable Materials:** Expendable dental materials supplied by the school; are noted in **Appendix A**. Items not listed are responsibility of Candidate.

• **Sterilization Services:** If you would like your instruments sterilized upon completion of your exam, place your bagged contaminated instruments, with your candidate number on the bag and walk them to the sterilization window marked contaminated. Note, we will not ultrasonic or remove your items from their labeled bags prior to sterilization, make sure you run your instruments through the proper cleaning steps and re-sterilize them at your location before next use. Please allow 24 hours for sterilization. Sterilized instruments will be placed in the lobby outside the clinic entrance. Note that collection of sterilized instruments is on an honor system. No one will watch over them. The school will not be held accountable for any missed instruments.

3. Preparing for the Local Anesthesia Exam

- **Equipment, Instruments and Expendable Dental Materials:** Refer to the respective WREB Candidate Guide for a list of materials and armamentarium that the Candidate

must provide.

A. Air/Water Syringe Tips: Air/water syringe tips are provided by the school.

B. Blood Pressure Cuffs and Stethoscopes: The Candidate is responsible for providing their own.

C. Expendable Materials: Expendable dental materials supplied by the school are noted **Appendix B** (items not listed are responsibility of Candidate).

- Please wear appropriate clinical attire while in the dental clinic and follow all infection control protocols.

PPE for Local Anesthesia Exam:

- Candidates are required to bring their own:
 - ASTM Level 2 or 3 face masks
 - protective eyewear with side shields for yourself and your patient
 - disposable gowns. If a reusable gown is used, candidate must take off the gown carefully and immediately put into a sealed bag after doffing.

Gloves will be provided onsite. You can bring your own gloves if you have a preference of a certain type or brand of gloves.

Donning and doffing of PPE must happen inside the dental clinic, no contaminated PPE will be allowed outside of the dental clinic.

• **Sterilization Services:** If you would like your instruments sterilized upon completion of your exam, place your bagged contaminated instruments, with your candidate number on the bag and walk them to the sterilization window marked contaminated. Note, we will not ultrasonic or remove your items from their labeled bags prior to sterilization, make sure you run your instruments through the proper cleaning steps and re-sterilize them at your location before next use. Please allow 24 hours for sterilization. Sterilized instruments will be placed in the lobby outside the clinic entrance. Note that collection of sterilized instruments is on an honor system. No one will watch over them. The school will not be held accountable for any missed instruments.

Anesthesia Exam: If sterilization of your syringe is needed to re-take the exam, we cannot guarantee your syringe will be sterilized in time for your retake exam. Please bring extra syringes.

4. Preparing for the Restorative Exam

- **Equipment, Instruments and Expendable Dental Materials:** Refer to the respective WREB Candidate Guide for a list of materials and armamentarium that the Candidate must provide.

A. Handpiece and Propy Angle Hookups: Handpiece hook-ups are two and four-pin.



Handpieces (high and slow speed) are available upon request by emailing the school coordinator before clinical restorative orientation. They will be given to the candidate during the restorative set-up period. In order to receive a handpiece, the candidate number and op number will be needed in order to check out the handpieces. The school does not charge for the use of the handpieces. However, the candidate will be charged for the handpieces if they are not returned. The high-speed handpiece is attached to the line that has the tape next to the hook up site.

B. Air/Water Syringe Tips: Air/water syringe tips are provided by the school.

C. Curing Lights: Curing lights will be available at each operatory.

D. Amalgamators: Several are placed within the clinic

E. Expendable Materials: Expendable dental materials supplied by the school are noted in **Appendix C**. (items not listed are responsibility of Candidate).

- Please wear appropriate clinical attire while in the dental clinic and follow all infection control protocols.

PPE for Restorative Exam:

- Candidates are required to bring their own:
 - protective eyewear with side shields for yourself
 - reusable or disposable gowns.

Level 1 masks will be provided for the restorative exam

Gloves will be provided onsite. You can bring your own gloves if you have a preference of a certain type or brand of gloves.

Donning and doffing of PPE must happen inside the dental clinic, no contaminated PPE will be allowed outside of the dental clinic.

5. During the Clinical Exam

- **Dental Operatory Units:** ADEC/Cascade dental chair with foot control chair operations.
- **Infection Control (Surface Asepsis):** Surface areas not covered by a barrier will be cleaned first, then wiped with 4 x 4 gauze soaked with Birex disinfectant. These items are located at

each sink station in the clinic.

A. Hazardous Waste Disposal (exam-type specific):

- **Hygiene:** Procedure for disposal of blood/saliva-soaked waste. Place blood- soaked waste in a red biohazard bag. Properly close the bag and then place the biohazard bag in the contaminated waste box next to the contaminated window of the sterilization room.
- **Local Anesthesia:** Place both the needle and spent carpule of anesthetic in the sharp's container. There is a sharps container in each op.
- **Restorative:** Procedure for disposal of amalgam scraps. Amalgam scraps can either be placed in the amalgam scrap jars located next to the amalgamator or in the large amalgam scrap container next to the clinical doors. Please no plastic amalgam capsules in either container. Amalgam only.

B. Sharps Disposal: Sharps containers are in each op. Only for needles and anesthetic carpules.

• **Emergency Medical Equipment:**

A. Phones:

- Room 106(clinic): on the wall in the middle island
- Front desk: out through the doors into the reception area.
- **For emergency help dial 9-911, please solicit another caller to also call campus security at #8224.**

B. Fire Extinguishers:

- Room 109: in the hall outside the Examiner's clinic
- Room 106 by the windows and emergency exit
- How to use: pull the pin, aim at the base of the fire, squeeze the trigger
- **Do not use if faced with a large or rapidly growing fire, just exit as soon as possible (always take your patient)**

C. Nearest Exits:

- Room 106 clinic: out the emergency exit in the main dental clinic between the treatment rooms C5 and D5
- Once outside continue along the path and move away from the building

D. Eyewash Stations (wear your protective eyewear):

- Room 109: back lab
- Examiner's Clinic: 1st sink on the right
- Room 106 main testing clinic: each row of treatment rooms has one sink with an eye-wash station, be sure to locate the one that is closest to you before you begin your procedure. There is also an eye wash station in the sterilization room.

Pull off the green caps, pull the metal stopper on the back of the faucet and turn the water on. Flush eyes thoroughly.

E. Emergency Oxygen:

- Examiner's Clinic: inside door as you enter from the lab
- Room 106, main testing clinic: by the emergency exit and by the entrance door to the processing rooms.

On/Off knob is on the side (a lever), flow knob is circular, everything else is hooked up. Additional oxygen can also be found when the N2O is set up.

F. First Aid, Emergency Kits and Defibrillator (AED):

- Examiner's room #107 in the cabinets attached to the sterilization area – first aid only
- Room 106 main testing clinic: First Aid hanging on the wall by the master switch and first aid and all emergency items in four (4) drawers across from the as you enter through the main Clinic doors.
- Defibrillator (AED) mounted on the wall next to the entrance for the x-ray processing room.

MSDS Manual/Book: in op number F-1 in the cabinet

Exposures and Exposure Personnel (wear your PPE and handle sharps carefully):

Clinic Manager – 1st office on the left as you enter main Clinic

Office Manager – Reception

6. Travel and Lodging Information

Airport Information: SeaTac (Seattle Tacoma) International-travel time approximately 45 minutes from the airport-normal traffic

Ground Transportation: Shuttle Express, rental cars

Hotel Accommodations:

The Clarion Inn at Totem Lake

12233 Totem Lake Way

425-821-2202

Silver Cloud Inn

12202 NE 124th

425-821-8300

Best Western Kirkland Inn

12223 NE 116th

425-822-2300 or 1-800-528-1234 (reservations center)

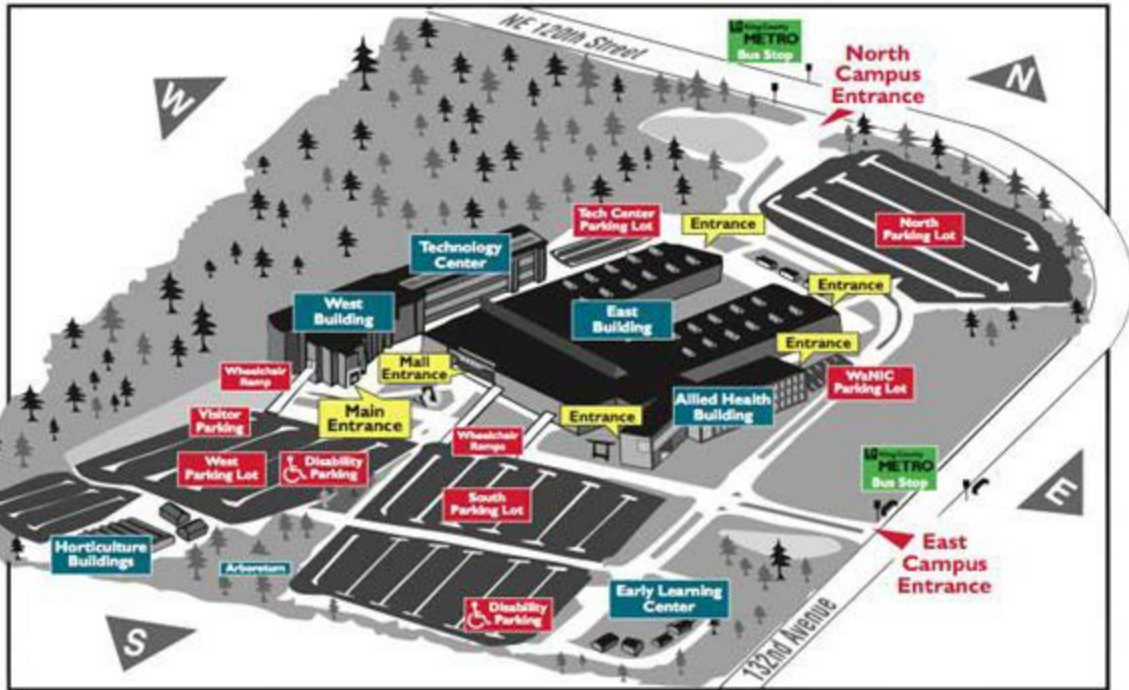

7.Campus Map:

The dental clinic located in the east building in E106. The east building is the two-story U- shaped building on the map. The dental clinic located in the lower right side of the U shape. Park near the Allied Health Building. You will enter on the third floor, take the elevator down to the first floor, take a right out of the elevator, then an immediate right. Once you pass the stairs, the dental clinic entrance is through the double doors on your left.



White building, east building.

- Allied health building entrance is off to the right of this photo.

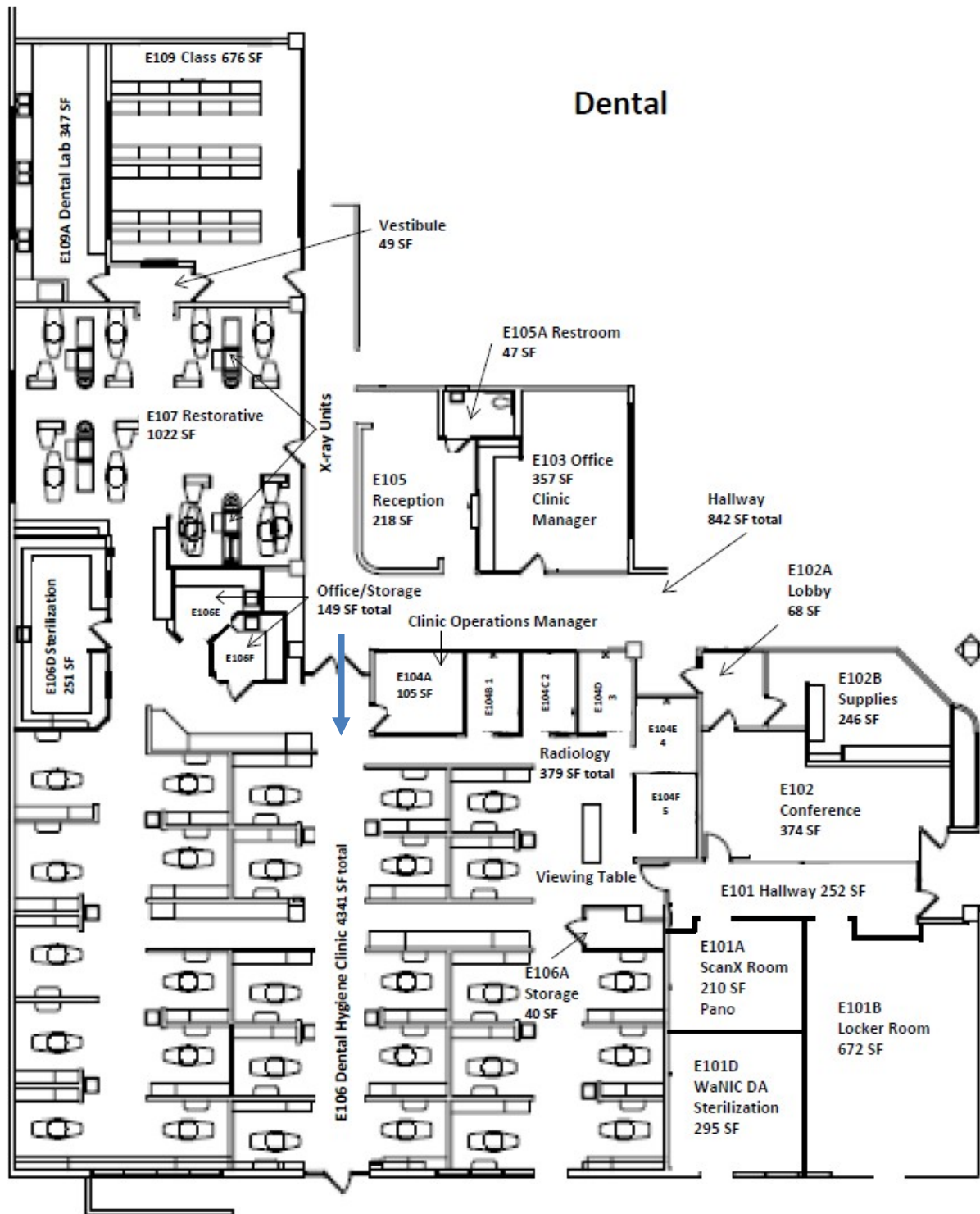

8. **Clinic Floor Plan:** Patient waiting area-lobby of the dental clinic, Candidate clinic-E106, 28 ops with 5 x-ray rooms, Examiner grading area-E107 and E109.

LWTech Dental
Hygiene Clinic Floor
Operator numbers

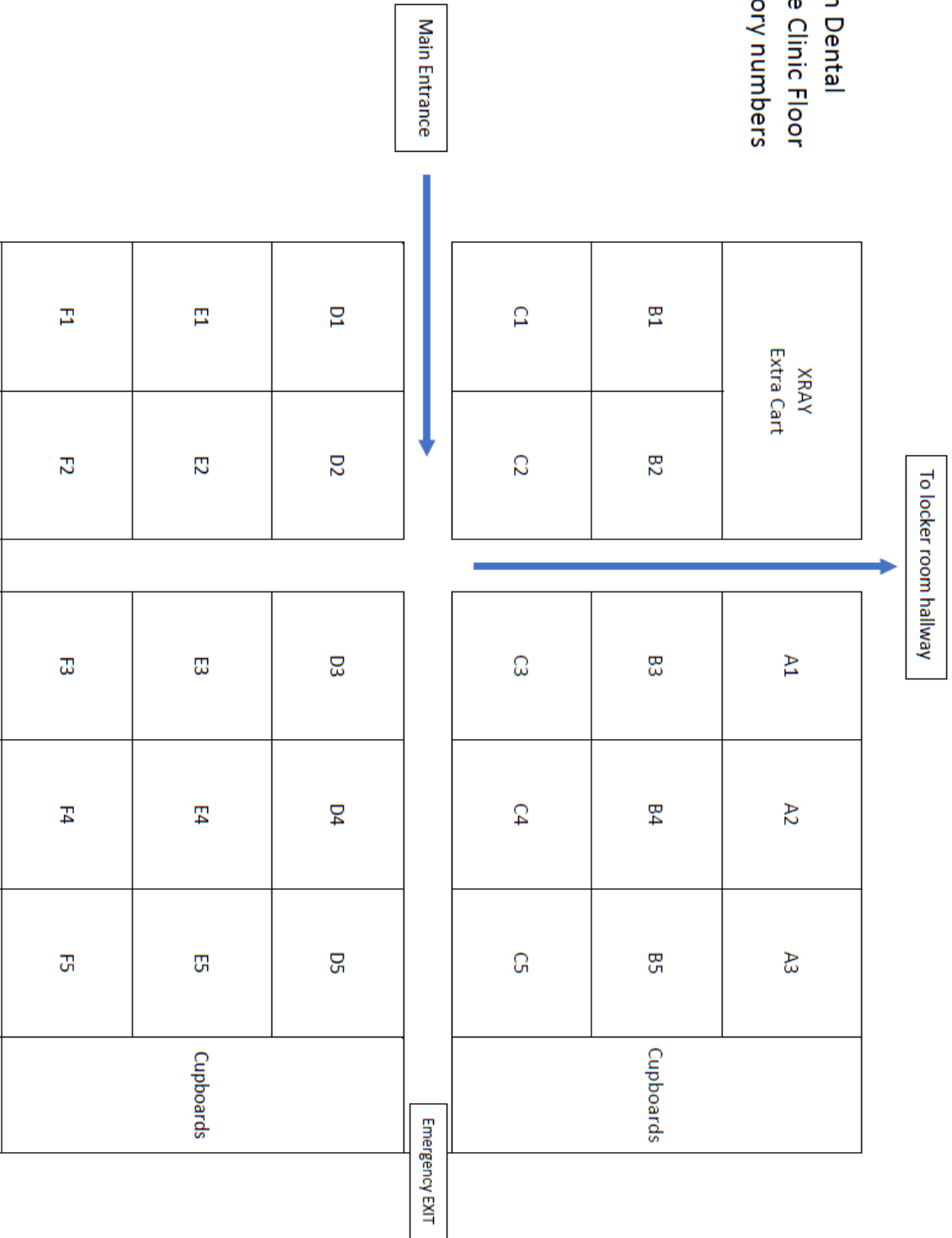

9. Required School-provided Expendable Dental Materials Appendices

APPENDIX A – Expendable Dental Hygiene Materials List Provided by Exam Site Host (LWTECH) To be provided in sufficient quantities for all Dental Hygiene Candidates		
2x2 gauze squares	Cotton-tip applicators	Sanitizing materials
Air/water syringe tips	Drinking cups	Soap
Antimicrobial mouthwash	Facial tissue	Standard saliva ejectors/HVE
Anesthetic(s)	Gloves, nonlatex	Surface disinfectant
<ul style="list-style-type: none"> Local anesthetic(s) with and without vasoconstrictors 	Headrest covers	Syringe Needles (long & short)
<ul style="list-style-type: none"> Topical anesthetic(s) 	Instrument trays	Tray covers
Autoclave bags, small	Paper towels	Trash bags
Autoclave bags, medium	Patient bib clips, disposable	
Autoclave tape	Patient napkins/bibs	
Barrier covers/tape	Prophy paste	

APPENDIX B – Expendable Local Anesthesia Materials List Provided by Exam Site Host (LWTECH) To be provided in sufficient quantities for all Local Anesthesia Candidates		
2x2 gauze squares	Cotton-tip applicators	Patient bib clips, disposable
Air/water syringe tips	Drinking cups	Patient napkins/bibs
Antimicrobial mouthwash	Facial tissue	Sanitizing materials
Anesthetic(s)	Gloves, nonlatex	Soap
<ul style="list-style-type: none"> Local anesthetic(s) with and without vasoconstrictors 	Headrest covers	Standard saliva ejectors
<ul style="list-style-type: none"> Topical anesthetic(s) 	Instrument trays	Surface disinfectant
Autoclave bags, small	Paper towels	Syringe Needles (long & short)
Autoclave bags, medium		Tray covers
Autoclave tape		Trash bags
Barrier covers/tape		

APPENDIX C – Expendable Restorative Materials List Provided by Exam Site Host (LWTECH) To be provided in sufficient quantities for all Restorative Candidates		
2x2 gauze squares	Drinking cups	Sanitizing materials
Air syringe tips	Level 1 mask	Rod posts (mounting Typodont)
Amalgamator/Triturator	Facial tissue	Soap
Amalgam scrap container(s)	Gloves, nonlatex	Surface disinfectant
Barrier covers/tape	Instrument trays	Tray covers
Cotton-tip applicators	Paper towels	Trash bags