

## Great Falls College MSU



Exam Site Information for Candidates  
Western Regional Examining Board (WREB)  
2021 WREB Hygiene Examination

Great Falls College Montana State University  
2100 16<sup>th</sup> Ave South  
Great Falls, MT, 59404  
(406) 77-4364

**Exam Site Information for Candidates**  
**2021 WREB Dental Hygiene, Local Anesthesia & Restorative Examinations**

**Table of Contents**

**1. School Facility and Services**

- Clinic Address, Building Access and Hours
- Parking
- Security and Emergency Services
- ATM Machine
- Food Services Onsite

**2. Preparing for the Exam**

- Patient Screening
- Radiographs
- Administration of Local Anesthetic – Practitioner Availability
- Dental Operatory Units
- Equipment, Instruments and Expendable Materials
- Sterilization Services

**3. During the Exam**

- Infection Control (Surface Asepsis)
- Medical Emergencies and Equipment

**4. Travel and Accommodation Information**

- Airport Information
- Ground Transportation
- Hotel Accommodation

**5. Appendices**

- Campus Map
- Clinic Floor Plan
- Expendable Dental Materials Lists

## 1. School Facility and Services

- **Location, Building Access and Hours:** Dental hygiene **CLINIC** 2100 16<sup>th</sup> Ave South, Great Falls, MT, 59405, (406) 771-4364. and contact Terri Jarvey name for questions regarding the school, equipment, etc. Enter building from the Main Parking Lot (North side). There is a dental clinic sign outside of the building noting which doors to enter; building open 6:00am-6:00pm daily for duration of exam.
- **Parking:** Candidates, patients, and examiners can park anywhere in the North Lot. There is not fee for parking. Enter through the doors to the left of the main entrance.
- **Security and Emergency Services:** To access security candidates are asked to call 911
- **ATM Machine:** The ATM machine is located just outside the bookstore near the food court area.
- **Food Services Onsite:** There are vending machines on campus but there is no food service on the weekends. There are grocery stores and restaurants near campus.

## 2. Preparing for the Hygiene Exam

- **Patient Screening:** GFCMSU does not have the responsibility of providing examination patients or back-up patients for any candidate. Candidates should not make requests of anyone associated with the college (faculty, administration, or staff) for possible back-up patients, patient information, patient consultation, advice, or patient records relating to any patient being considered for the WREB examination. All questions should be directed to appropriate WREB officials. The GFCMSU dental clinic will be available on a limited basis for screening patients. All screening are facilitated **by appointment only**. Please call the Dental Clinic Manager 406-771- 4364 for details. There is a \$10 fee for use of the facility for screening patients to cover the cost of barriers and supplies for the screenings. Radiographs are not permitted unless requested by the supervising dentist during the exam.
- **Radiographs:** Candidates are required to provide x-rays for exam, however, if the examiners require additional images the radiology lab will be available. This lab is located across the hall from the clinic. Print outs of the images will be available if images are required.
- **Administration of Local Anesthetic.**

Practitioner(s) from the school is **NOT AVAILABLE** to administer local anesthesia to Candidate Patients. There are no exceptions to this policy.

- **Equipment, Instruments and Expendable Dental Materials:** Refer to the respective WREB Candidate Guide for a list of materials and amamentarium that the Candidate must provide.

### A. Handpiece and Prophy Angle Hookups:

Candidates will need to bring their own slow speed hand pieces if they choice to use one. The dental chairs feature a four –hole (screw-on) air connection. The air pressure to each operatory is chair is factory set to approximately 35 to 50 psi.

- **B. Sonic/Ultrasonic Devices:** WREB allows the use of sonic/ultrasonic devices as an adjunct to calculus removal. Candidates are responsible for bringing their own

ultrasonic device if they choose to use one. The college does not rent equipment to candidates Please see images below of hookups available in each operatory.

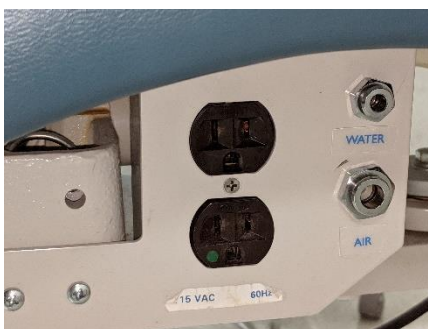

**C. Air/Water Syringe Tips:** Syringe tips are disposable and are included in the school use fee.

**D. Blood Pressure Cuffs and Stethoscopes:** Candidates are responsible for providing their own blood pressure cuffs and stethoscopes.

**E. Expendable Materials:** Expendable dental materials supplied by the school are noted in **Appendix A**. (Items not listed are the responsibility of the Candidate).

- **Sterilization Services:** If available, specify time sterilization will open/close each day. **Candidates retaking onsite will need their instruments sterilized prior to retake clinic entrance.**

### 3. Preparing for the Local Anesthesia Exam

- **Equipment, Instruments and Expendable Dental Materials:** Refer to the respective WREB Candidate Guide for a list of materials and amamentarium that the Candidate must provide.

**A. Air/Water Syringe Tips:** Syringes are disposable and included in the school use fee.

**B. Expendable Materials:** Expendable dental materials supplied by the school are noted in **Appendix B**. (items not listed are responsibility of Candidate).

- **Sterilization Services:** Sterilization is available during the Local Anesthesia Exam and Hygiene Exam. The hours for sterilization will begin and end with the exams each day. Candidates retaking onsite will need their instruments sterilized prior to retake clinic entrance. Sterilization will be available if this need should arise.

### 4. During the Clinical Exam

- **Dental Operatory Units:** The clinic has two types of clinic chairs in the clinic: Adec 500 and the Magellan Dental Unit. Each unit is universal and can be used by both right and left handed clinicians.



- **Infection Control (Surface Asepsis):** Each operatory should be wiped with Cavi-wipes before barrier are placed. The chair, cart, shelf and operator chairs should all be wiped down. Each op should have 4 plastic barriers placed: one for the tray/arm, one for the suction, one for the chair and one for the operator chair. Four sticky barriers are also provided two for the light handles, one for the light switch and one for the operator chair handle. Tow sleeves are provided for the unit: one for the air/water and one for the suction. After the candidate has dismissed their patient each operatory should be wiped down using the wipe/wipe method.

**A. Hazardous Waste Disposal (exam-type specific):**

- **Hygiene:** Procedure for disposal of blood/saliva-soaked waste. Most waste can go directly into the garbage. If the candidate has blood soaked gauze, please inform the floor assistant and they will be able to dispose of it appropriately.
- **Local Anesthesia:** Procedure for disposal of blood/saliva-soaked waste. See above for disposal of soaked waste. All used sharps go into the sharps containers located above each sink in the clinic.
- **Restorative:** Procedure for disposal of amalgam scraps. This clinic doesn't dispose of amalgam scraps at this time.

**B. Sharps Disposal:** All used sharps go into the sharps containers located above each sink in the clinic. All needles and used carpules may be disposed in the sharps containers.

- **Emergency Medical Equipment:** Emergency equipment is located in the clinic kiosk right as you enter the clinic through the main entrance. This area will be shown to you during the examination tour. The oxygen tank is located next the emergency kit in the same area. The AED unit is just outside the main clinic doors. An eyewash station is located in the middle of the clinic, the sterilization area and the lab. In the event of an emergency please stay with your patient and verbally notify the clinic floor assistant of the emergency by stating Operatory 99. A phone located at the back of the clinic near the WREB clock may be used to call 911 if needed.

**5. Travel and Accommodation Information**

- **Airport Information:** Great Falls International Airport is located 10 miles outside the city limits
- **Ground Transportation:** The airport offers car rentals. Also Blacked Out 406 Taxi and Limousine Services is available. Please call (406) 781-5218 for details.
- **Hotel Accommodations:**

- Fairfield Inn, 1000 9<sup>th</sup> Ave S, (406) 454-3000
- Great Falls Inn, 1400 28<sup>th</sup> St. South, (406) 453-6000
- La Quinta, 600 River Dr. S, (406) 761-2600

## 6. Maps

- **Campus Map:** From Great Falls International Airport, take I-15 N from Terminal Dr. and Airport Dr., Take MT-200 E/US-89 S to 10<sup>th</sup> St S in Great Falls, Continue on 10<sup>th</sup> until 20<sup>th</sup> St. S. Take a right onto 20<sup>th</sup> St. S. Then take a left onto 16<sup>th</sup> Ave S. Continue on 16<sup>th</sup> Ave S. until you have reached your destination.



Great Falls College MSU

- **Clinic Floor Plan:**

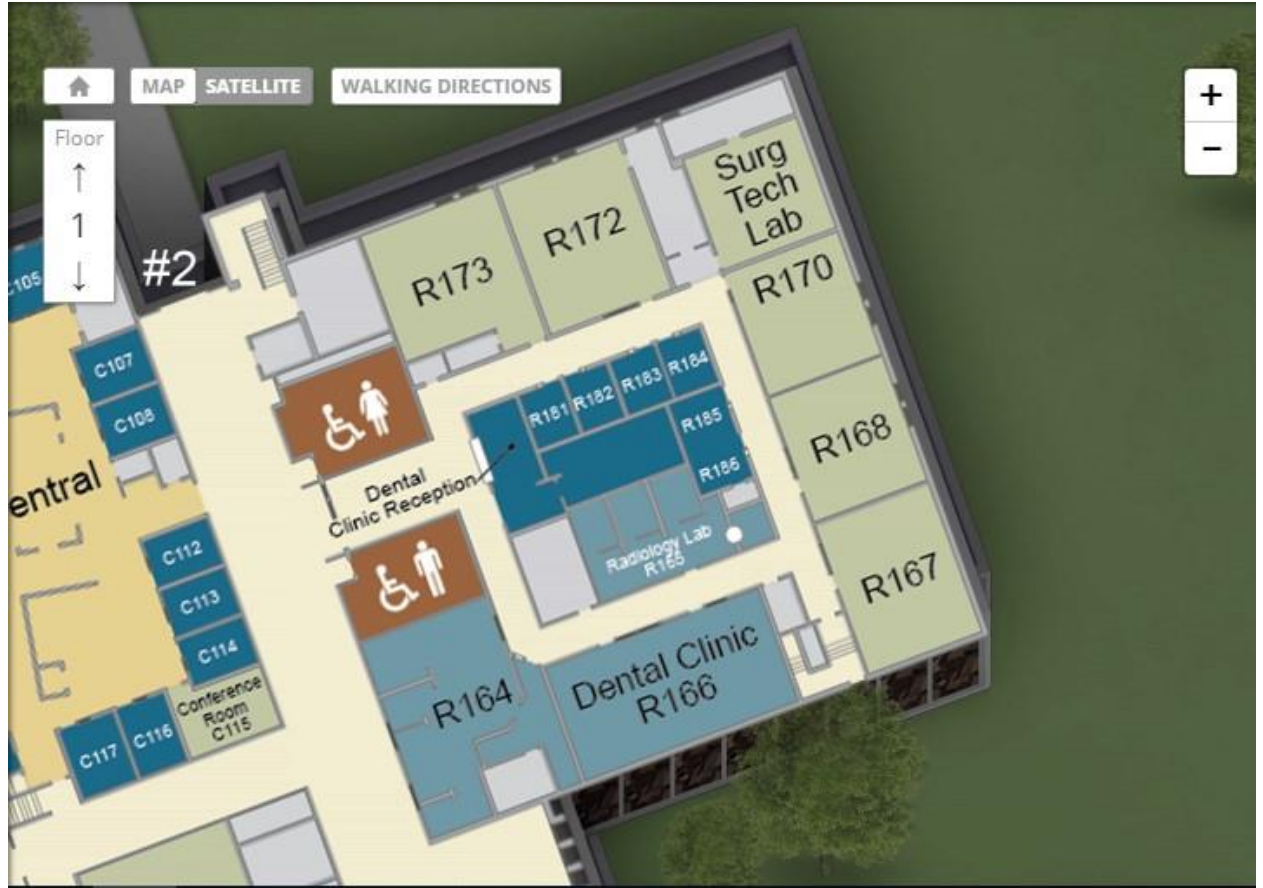

Dental Wing

- Patient waiting area is in clinic reception area, Candidate clinic is R166, Examiner grading area is R168, Areas of emergency equipment between R164 and R166 in kiosk. AED is located outside R164. R17-R167 is not available during examination time for candidates. Please observe signs noting designated areas.

## Expendable Dental Materials Appendices

<b>APPENDIX A – Expendable Dental Hygiene Materials List                      Provided by Exam Site Host (School)                      To be provided in sufficient quantities for all Dental Hygiene Candidates</b>		
2x2 gauze squares	Cotton-tip applicators	Paper towels
Air/water syringe tips	Drinking cups	Patient bib clips, disposable
Antimicrobial mouthwash	Face masks	Patient napkins/bibs
Anesthetic(s)	Facial tissue	Prophy paste
• Local anesthetic(s)	Gloves	Sanitizing materials
• Topical anesthetic(s)	• Gloves, nonlatex (S,M,L,XL)	Soap
Autoclave bags, small	• Overgloves	Standard saliva ejectors
Autoclave bags, medium	Headrest covers	Surface disinfectant
Autoclave tape	Instrument trays, disposable	Tray covers
Barrier covers/tape	Syringe Needles	Trash bags

<b>APPENDIX B – Expendable Local Anesthesia Materials List                      Provided by Exam Site Host (School)                      To be provided in sufficient quantities for all Local Anesthesia Candidates</b>		
2x2 gauze squares	Cotton-tip applicators	Paper towels
Air/water syringe tips	Drinking cups	Patient bib clips, disposable
Antimicrobial mouthwash	Face masks	Patient napkins/bibs
Anesthetic(s)	Facial tissue	Sanitizing materials
• Local anesthetic(s)	Gloves	Soap
• Topical anesthetic(s)	• Gloves, nonlatex (S,M,L,XL)	Standard saliva ejectors
Autoclave bags, small	• Overgloves	Surface disinfectant
Autoclave bags, medium	Headrest covers	Tray covers
Autoclave tape	Instrument trays, disposable	Trash bags
Barrier covers/tape	Syringe Needles	