

Instructions for use: Please respond to the questions below

Screening Questions		Notes
Do you have a fever or above-normal temperature (>100.4)? Take temperature at appointment.	<input type="checkbox"/> No <input type="checkbox"/> Yes	<i>Temperature will be recorded for you by the student.</i>
Are you experiencing shortness of breath or having trouble breathing?	<input type="checkbox"/> No <input type="checkbox"/> Yes	
Do you have a dry cough?	<input type="checkbox"/> No <input type="checkbox"/> Yes	
Have you recently lost or had a reduction in your sense of smell or taste?	<input type="checkbox"/> No <input type="checkbox"/> Yes	
Do you have a runny nose? (unrelated to allergies)	<input type="checkbox"/> No <input type="checkbox"/> Yes	
Do you have a sore throat?	<input type="checkbox"/> No <input type="checkbox"/> Yes	
Are you experiencing chills or repeated shaking with chills?	<input type="checkbox"/> No <input type="checkbox"/> Yes	
Do you have unexplained muscle pain?	<input type="checkbox"/> No <input type="checkbox"/> Yes	
Do you have a headache?	<input type="checkbox"/> No <input type="checkbox"/> Yes	
Do you have nausea or vomiting?	<input type="checkbox"/> No <input type="checkbox"/> Yes	
Do you have diarrhea?	<input type="checkbox"/> No <input type="checkbox"/> Yes	
Have you been in contact with someone who has tested positive for COVID-19 in the last 14 days?	<input type="checkbox"/> No <input type="checkbox"/> Yes	
Have you been tested for COVID-19 in the last 14 days?	<input type="checkbox"/> No <input type="checkbox"/> Yes	

Please notify the DSU Dental Hygiene Program within 10 days if you become ill with COVID-19 symptoms or test positive for COVID-19.

Dixie State University Dental Hygiene



**Exam Site Information for Candidates
Western Regional Examining Board (WREB)
2021 WREB Local Anesthesia Examination**

**Dixie State University
Taylor Health Science Building
1526 S Medical Center Drive St. George UT
435-879-4905**

Exam Site Information for Candidates
2020 WREB Dental Hygiene, Local Anesthesia & Restorative Examinations

Table of Contents

1. School Facility and Services

- Clinic Address, Building Access and Hours
- Parking
- Security and Emergency Services
- ATM Machine
- Food Services Onsite

2. Preparing for the Exam

- Patient Screening
- Radiographs
- Administration of Local Anesthetic – Practitioner Availability
- Dental Operatory Units
- Equipment, Instruments and Expendable Materials
- Sterilization Services

3. During the Exam

- Infection Control (Surface Asepsis)
- Medical Emergencies and Equipment

4. Travel and Lodging Information

- Airport Information
- Ground Transportation
- Hotel Accommodation

5. Campus Map

6. Clinic Floor Plan

7. Required School-provided Expendable Dental Materials Appendices

1. School Facility and Services

- **Location, Building Access and Hours:**
 - Dixie State University – Taylor Health Science Bldg
 - 1526 S. Medical Center Drive
 - St. George UT 84770
 - 435-879-4912 – Jessica Atkinson
 - Entry on south side of building
 - Building open 6:00 am – 6:00 pm Saturday April 10
- **Parking:** Parking is available on-site at no charge
- **Security and Emergency Services:** Campus security – 435-236-4000
- **ATM Machine:** N/A
- **Food Services Onsite:** N/A

2. Preparing for the Exams

a. Local Anesthesia Exam

- **Equipment, Instruments and Expendable Dental Materials:** Refer to the respective WREB Candidate Guide for a list of materials and armamentarium that the Candidate must provide.
 - A. Air/Water Syringe Tips:** Air/Water syringe tips are disposable and will be available
 - B. Expendable Materials:** Expendable dental materials supplied by the school are noted in *Appendix B*.
- **Sterilization Services:** Sterilization services are available

3. During the Clinical Exam

- **Dental Operatory Units:** Belmont ExCaliber Chairs.
- **Infection Control (Surface Asepsis):** Barriers and surface disinfectants will be provided
 - A. Hazardous Waste Disposal (exam-type specific):**
 - **Local Anesthesia:** Hazardous waste disposal located in Sterilization lab
 - B. Sharps Disposal:** Sharps containers located between each two chairs. Capped needles and LA cartridges allowed in sharps containers
- **Emergency Medical Equipment:** First Aid equipment located in mini-lab in the main clinic area. AED mounted on wall outside of mini-lab. Emergency protocol binders located between each two operatories.

4. Travel and Lodging Information

- **Airport Information:** St George Airport or Las Vegas (2 hours away)
- **Ground Transportation:** Taxi, Lift
- **Hotel Accommodations:** Candidates are local so no hotel accommodations needed

5. Campus Map: Taylor Health Sciences building is located next to the hospital off campus. The address is 1526 S. Medical Center Drive St. George UT

6. Clinic Floor Plan:

Exam Location & Directions

Mailing Address

DSU Dental Hygiene
225 South University Avenue
St George, UT 84770

Clinic Address

DSU Dental Hygiene Clinic
Taylor Health Sciences Center
1526 E Medical Center Drive
St. George, Utah 84790



Driving Directions to the Clinic

- At **EXIT 8**, take ramp for **I-15 St George Boulevard**
- Turn **LEFT** onto **UT-34 E / E St George Blvd**
- Turn **RIGHT** onto **River Rd**. You will **pass Target and Lowes** on the left-hand side.
- Turn **LEFT** onto **E Medical Center Drive / E 480 South**
- Pass **Intermountain Dixie Regional Medical Center** and **Jubilee Home II** on the right-hand

Click on [map](#) for larger view.

side.

- Turn **RIGHT** into the DSU Taylor Health Sciences Center parking lot.
- Park and enter on the **SOUTHEAST SIDE** at the Dental Hygiene Clinic Entrance.

Telephone Numbers

(435) 879-4900 Clinic Manager: Elyse Perkins

(435) 879-4905 Secretary: Kristina Brems

(435) 879-4909 Department Chair: Brenda Armstrong RDH MDH

Parking & Clinic Entrance

- Enter the Clinic on the South Side of the Taylor Health Science Center
- **Free parking** for Candidates and Patients allowed in any part of the parking lot located at the Russell Taylor Health Science Building.
- Permits are not required during WREB examination day and parking lot hours are 6:00 a.m. to 6:00 p.m.
- Vehicles left after hours on campus are subject to being towed.



Click on [map](#) for larger view.

Clinic Floor Plan

Patient reception area, Candidate clinic, Examiner grading area, areas of emergency equipment:
Please see attached map



- **Blue line** represents barrier curtains.
- Operatories on the right side of the blue line are the **examiner area**.
- Operatories on the left side of the blue line are **candidate operatories**.
- **Patient reception room** is located on the far left lower corner.
- The hallway located just outside the top of the map is the **check-in area**.



- **Blue star** notes location of emergency binder, emergency first aid kit and emergency oxygen.



- **Red lightning bolt** notes location of the AED unit.

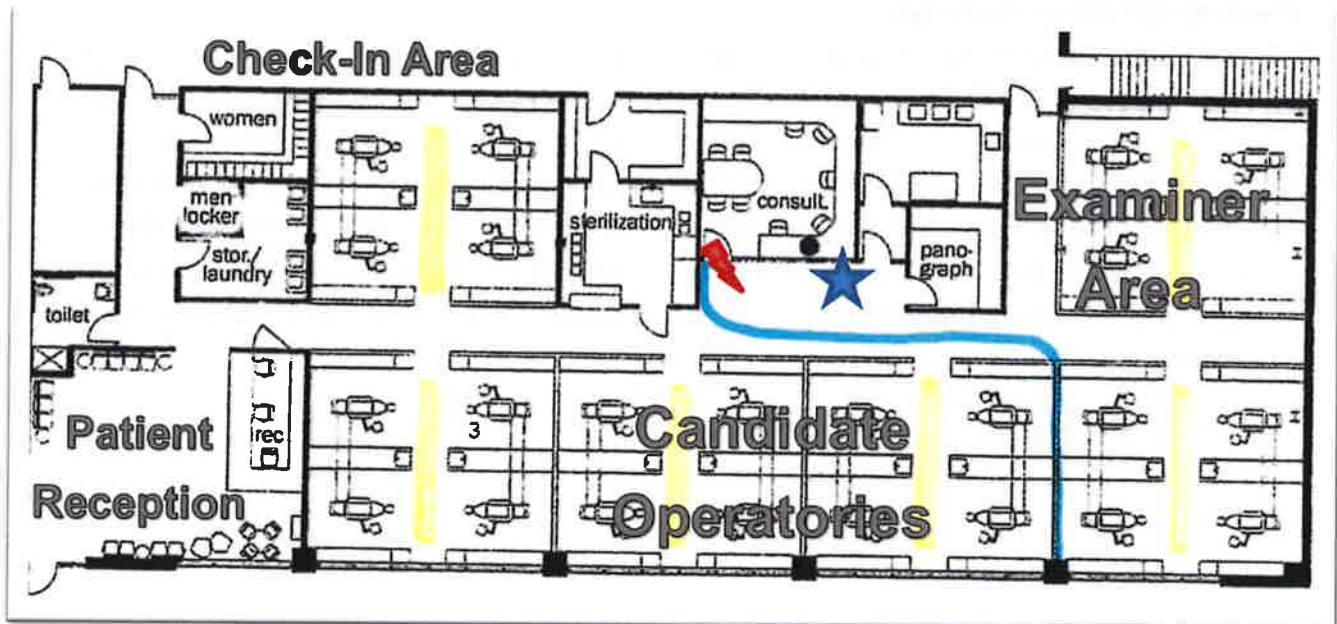

Local Accommodations

Airport Information

Candidates can choose to fly into either St George Regional Airport (half hour from exam site) or Las Vegas, NV airports (2.5 hours from exam site).

- Website for St. George Regional Airport (SGU): <https://www.flysgu.com/>. You will also find ground transportation available at this website.
- Website for Las Vegas, NV, McCarran International Airport: <https://www.mccarran.com/>

Lodging: Hotel/Motel

Reservations should be made directly with hotels/motels accommodations located in St George, Utah. Most hotel accommodations in St. George would be no more than 20 minutes away from the DSU Taylor Health Sciences Center.

Food & Beverage Services

Dixie State University has no food, beverage, or cafeteria services for candidates or their patients except for a couple of vending machines. Candidates should inform their patients to eat before coming to the exam or candidates may choose to bring a small amount of food and beverage for their patients that the on-site **school coordinator can refrigerate and then retrieve for them** when it is needed. There are many gas stations, restaurants, fast food establishments, and a grocery store located within one (1) mile of the clinic if you wish to purchase food. However, **food or drink are not allowed in any areas** near the candidate clinics or check in desk during the examination.

Required School-provided Expendable Dental Materials Appendices

APPENDIX B – Expendable Local Anesthesia Materials List Provided by Exam Site Host (School) To be provided in sufficient quantities for all Local Anesthesia Candidates		
2x2 gauze squares	Cotton-tip applicators	Patient bib clips, disposable
Air/water syringe tips	Drinking cups	Patient napkins/bibs
Antimicrobial mouthwash	Face masks	Sanitizing materials
Anesthetic(s)	Facial tissue	Soap
<ul style="list-style-type: none"> Local anesthetic(s) with and without vasoconstrictors 	Gloves	Standard saliva ejectors
<ul style="list-style-type: none"> Topical anesthetic(s) 	<ul style="list-style-type: none"> Gloves, nonlatex (S, M,L,XL) 	Surface disinfectant
Autoclave bags, small		Syringe Needles (long & short)
Autoclave bags, medium	Headrest covers	Tray covers
Autoclave tape	Instrument trays, disposable	Trash bags
Barrier covers/tape	Paper towels	