

**Clark College
Firstenburg Dental Hygiene
Education and Care Center**



**Exam Site Information for Candidates
Western Regional Examining Board (WREB)
2021 WREB Hygiene Examination**

**Clark College
Health Science Center Main Campus
1933 Fort Vancouver Way
Vancouver, WA 98663
360-992-2127**

Physical building address: 2232 E. Reserve Street, Vancouver, WA 98661

Exam Site Information for Candidates
2020 WREB Dental Hygiene, Local Anesthesia & Restorative Examinations

Table of Contents

1. School Facility and Services

- Clinic Address, Building Access and Hours
- Parking
- Security and Emergency Services
- ATM Machine
- Food Services Onsite

2. Preparing for the Exam

- Patient Screening
- Radiographs
- Administration of Local Anesthetic – Practitioner Availability
- Dental Operatory Units
- Equipment, Instruments and Expendable Materials
- Sterilization Services

3. During the Exam

- Infection Control (Surface Asepsis)
- Medical Emergencies and Equipment

4. Travel and Lodging Information

- Airport Information
- Ground Transportation
- Hotel Accommodation

5. Campus Map

6. Clinic Floor Plan

7. Required School-provided Expendable Dental Materials Appendices

1. School Facility and Services

- **Location, Building Access and Hours:** Clark College Dental Hygiene Clinic, Health Science Center: Physical building address 2232 E Reserve Street, Vancouver, WA 98661. College contact: Marci Wedemeyer 360-992-2127 Directions to Clinic entrance; the clinic is located in the North East corner of the main college campus, off of East Reserve Street, park in the Brown 1 parking lot. Building open 6:00am-6:00pm daily for duration of exam.

COVID-19 protocol: All persons entering any building on the campus will be asked to provide a COVID health screening form and have their temperature checked. A health screening form will be provided by the college and sent to candidates from WREB. All persons, candidates, patients, and WREB employees, entering any college building, will be required to complete a form for each day and submit to the college representative. All persons must don appropriate face coverings prior to entering the building, a mask will be provided if you do not have one available. Face coverings must be in place while moving about the building(s). Only patients may remove their face covering when asked by the clinician while in the dental chair.

- **Parking:** Candidates and patients can park in any unmarked parking spot during the weekday at no charge. Do not park in Dental Patient Parking or F/S parking, these require permits or passes. There are no parking restrictions on weekends.
- **Security and Emergency Services:** Onsite Security can be contacted 24 hours a day at 360-992-2133, or by dialing 2133 from a clinic phone.
- **ATM Machine:** Available in Gaiser Hall just to the West of the dental clinic.
- **Food Services Onsite, currently closed at time of publication October 2020:**
 - The Tod & Maxine McClaskey Culinary Institute Food Court is open Monday – Friday 10:00 a.m. to 3 pm, Bakery and coffee is open Monday – Friday 7am – 12pm
 - Coffee lounges - Hanna Hall: Monday – Thursday 6:45 AM – 8:00 PM and Friday 6:45 AM – 2:00 PM
 - Clark College Bookstore: Monday – Friday 8:00 AM – 5:00 PM
 - Joan Stout Hall Clark Café: Monday – Thursday 7:30 am – 1 pm

2. Preparing for the Exams

- **Clark College Clinic Attire:**
 - Scrubs
 - Closed toed puncture resistant shoes
 - Knee length long sleeve lab jacket with name/logo covered, disposable gowns will be available
 - Eye protection with side shields, OSHA accepted for clinician and patient
 - Long socks to cover above the ankle
 - **COVID-19 Requirements:**
 - Approve N95/KN95 respirator, must provide own mask and fit test certificate
 - Face shield, disposable shield will be available
 - Hair covering

1. Hygiene Exam

- **Patient Screening:** Candidates must provide their own patient. Clark College will not furnish any patients or make any records available for patient screening prior to the exam. Clark College cannot not provide clinical space for patient screening.

- **Radiographs:** Clark College is a fully digital radiology clinic; therefore, we are unable to provide access to our database platform for candidates. Candidates are required to have radiographs for their board patient and all back up board patients prior to the exam.
 - A. Radiology facilities will be made available for candidates if needed for supplemental images required by WREB. A fee for radiographs will be based on current clinic fees, \$5.00 per individual image not to exceed \$30.00.
 - B. Clark College only offers digital radiographs; therefore, the images will be taken using our database platform and printed for WREB submission.
 - C. Paper and ink charges are part of the fee for radiographs.
- **Administration of Local Anesthetic:** Practitioner(s) from the school are **NOT AVAILABLE** to administer local anesthesia to Candidate Patients. There are no exceptions to this policy. Candidates, if needed, are expected to provide their own practitioner to administration local anesthetic.

- **Equipment, Instruments and Expendable Dental Materials:** Refer to the respective WREB Candidate Guide for a list of materials and armamentarium that the Candidate must provide.
 - A. **Handpiece and Propy Angle Hookups:** The clinic is equipped with A-Dec chairs, there are two handpiece hoses available on each unit: a six (6) pin A-Dec high speed handpiece hose with water and a four (4) pin A-Dec slow speed hose without water. The handpiece(s) must be air driven and not electric. Candidates are responsible to supply their own handpiece, motor and attachment. If a candidate needs a handpiece, latch or prophy angle attachment they will be available for rent with **prior arrangements**. Rental charge for each handpiece is \$25.00 payable by cash or cashier's check, no personal checks or debit/credit cards can be accepted. A deposit check of \$500.00 must be left with the school coordinator, the deposit will be returned when the handpiece is returned. Rental charge for the latch and/or prophy angle will be \$20.00 payable by cash or cashier's check, no personal checks or debit/credit cards can be accepted, with a \$100.00 deposit check to be returned to you when rental item is returned.
 - B. **Sonic/Ultrasonic Devices:** WREB allows the use of sonic/ultrasonic devices as an adjunct to calculus removal. Candidates must supply their own ultrasonic unit. Air and water quick disconnect ports are available at each chair. Clark College **does not** rent or loan Sonic/Ultrasonic Devices, tips or handpieces.

COVID-19 Restrictions: Clark College will follow the guidelines from Washington State and Clark County Health Departments to determine use of aerosols during the hygiene exam. Any changes to the exam will be communicated to the candidates through WREB.
 - C. **Air/Water Syringe Tips:** The use of disposable air/water syringe tips is prohibited at Clark College. Each unit will be supplied with metal air/water syringe tip(s) for exams as needed. The metal tip(s) is the property of Clark College and will be bagged for sterilization at the end of the exam.
 - D. **Blood Pressure Cuffs and Stethoscopes:** Candidates are responsible to supply their own blood pressure cuff and stethoscope.
 - E. **Expendable Materials:** Expendable dental materials supplied by the school are noted in **Appendix A**.
- **Sterilization Services:** The sterilization of instruments, for retake purposes only, will be done by the school coordinator or clinic assistant. Instruments will be processed and ready for the candidate prior to their retake exam. Instruments will on the results table when sterilization in complete. Candidate will prepare instruments for sterilization by writing their candidate number only on the provided bag(s), taking the bag(s) and instruments back to the counter at the sterilization room for processing. Please make sure to inform the school coordinator or the clinic assistant that the instruments are ready for sterilization.

3. **Local Anesthesia Exam**

A. Equipment, Instruments and Expendable Dental Materials: Refer to the respective WREB Candidate Guide for a list of materials and armamentarium that the candidate must provide.

B. Syringe Tips: The use of disposable air/water syringe tips is prohibited at Clark College. Each unit will be supplied with metal air/water syringe tip(s) for exams as needed. The metal tip(s) is the property of Clark College and will be bagged for sterilization at the end of the exam

C. Expendable Materials: Expendable dental materials supplied by the school are noted in ***Appendix B***.

- **Sterilization Services:** The sterilization of instruments, for retake purposes only, will be done by the school coordinator or clinic assistant. Instruments will be processed and ready for the candidate prior to their retake exam. Instruments will be on the results table when sterilization is complete. Candidate will prepare instruments for sterilization by writing their candidate number only on the provided bag(s), taking the bag(s) and instruments back to the counter at the sterilization room for processing. Please make sure to inform the school coordinator or the clinic assistant that the instruments are ready for sterilization.

4. **Restorative Exam**

- **Equipment, Instruments and Expendable Dental Materials:** Refer to the respective WREB Candidate Guide for a list of materials and armamentarium that the Candidate must provide. The clinic has a-Dec dental chairs and delivery systems with post mount for the dentofrom.

- A. Handpiece and Propy Angle Hookups:** The clinic is equipped with A-Dec chairs, there are two handpiece hoses available on each unit: a six (6) pin A-Dec high speed handpiece hose and a four (4) pin A-Dec slow speed hose. The handpiece(s) must be air driven and not electric. Candidates are responsible to supply their own handpiece, motor and attachment. If a candidate needs a handpiece, latch or prophy angle attachment they will be available for rent with **prior arrangements**. Rental charge for each handpiece is \$25.00 payable by cash or cashier's check, no personal checks or debit/credit cards can be accepted. A deposit check of \$500.00 must be left with the school coordinator, the deposit will be returned when the handpiece is returned. Rental charge for the latch and/or prophy angle will be \$20.00 payable by cash or cashier's check, no personal checks or debit/credit cards can be accepted, with a \$100.00 deposit check to be returned to you when rental item is returned.

- B. Air/Water Syringe Tips:** The use of disposable air/water syringe tips is prohibited at Clark College. Each unit will be supplied with one metal air/water syringe tip for clinical exam. The metal tip(s) is the property of Clark College and will be bagged for sterilization at the end of the exam.

- C. Curing Lights:** Curing lights and shields will be provided at each unit.

- D. Expendable Materials:** Expendable dental materials supplied by the school are noted in ***Appendix C***

5. **During the Clinical Exam**

- **Dental Operatory Units:** The clinic is equipped with A-Dec chairs and delivery systems, with a variety of ergonomic and traditional operator stools.

- **Infection Control (Surface Asepsis):** Barriers will be placed on the dental chair, light handles, bracket tray handle, A/W syringe, saliva ejector, and on the handles of the operator stool. At the end of your exam all barriers will be removed and discarded, candidates will use ProSpray wipes to clean all surfaces of the dental chair, dental light, operator stool and unit counter tops. Each candidate will re-barrier the chair for the next candidate.

A. Hazardous Waste Disposal (exam-type specific):

- **Hygiene:** Any blood saturated items will be disposed in a chairside biohazard bag, these bags will be sealed and put into the biohazard box located across from the sterilization room.
- **Local Anesthesia:** Any blood saturated items will be disposed in a chairside biohazard bag, these bags will be sealed and put into the biohazard box located across from the sterilization room.
- **Restorative:** Amalgam scraps from the catch bag and amalgam well will be dumped out into the Amalgam scrap jar(s) next to the amalgamator.

B. Sharps Disposal: Anesthetic needles and carpules will be disposed of in the chairside sharp's container provided.

- **Emergency Medical Equipment:** All medical emergency equipment is located in the northwest corner of the clinic across from the sterilization room and marked with a ceiling sign.
 - There are two (2) portable oxygen tanks available, each equipped with an oxygen mask.
 - Emergency medical supplies and medications are located in the mobile emergency cart
 - AED is located in the mobile emergency cart.
 - In case of emergency:
 - Notify WREB personnel that you need assistance
 - Call EMS by dialing 911 directly
 - Have emergency cart brought to your unit by a WREB representative or School representative

6. Travel and Lodging Information

- **Airport Information:** Portland International Airport (PDX) is located 12.5 miles away from the college, www.flypdx.com/PDX
- **Ground Transportation:** Information available from the PDX website, www.flypdx.com/PDX, regarding ground transportation options.
- **Hotel Accommodations:**
 - Homewood Suites by Hilton: 360-750-1100
 - Holiday Inn Express: 360-253-0500
 - Hilton Vancouver: 360-993-4500
 - Heathman Lodge: 855-516-1090
 - Comfort Inn & Suites: 360-696-0411

7. Campus Map:

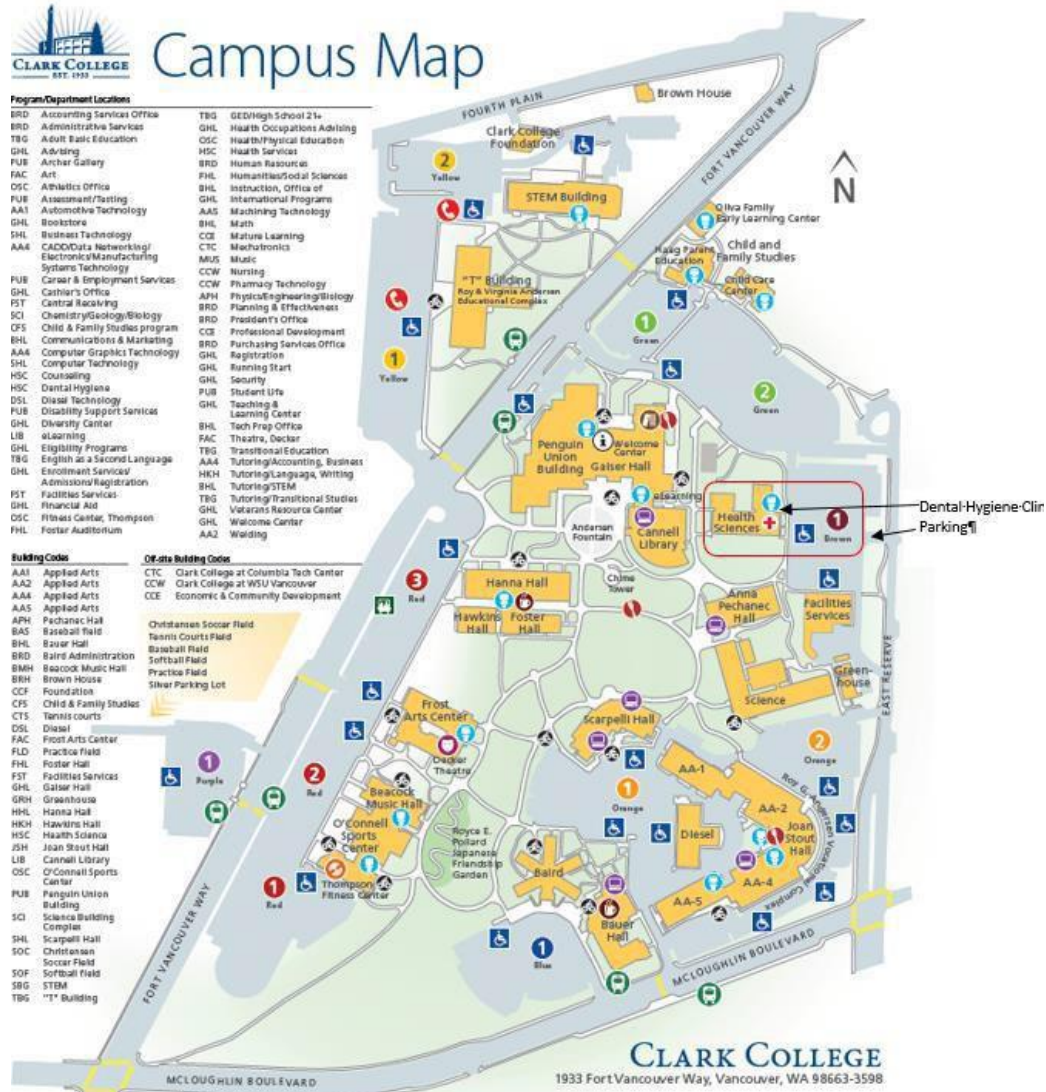

Driving Directions: www.clark.edu/about/visitors-guide/getting-to-clark/maps/google/index.php

Physical building address: 2232 E. Reserve Street, Vancouver, WA 98661

8. **Clinic Floor Plan:** Indicate Patient waiting area, Candidate clinic, Examiner grading area, areas of emergency equipment.

COVID 19: Entrance and Exit flows will be modified to accommodate social distancing as needed. The changes will be posted in the lobby and reviewed during the clinic orientation.

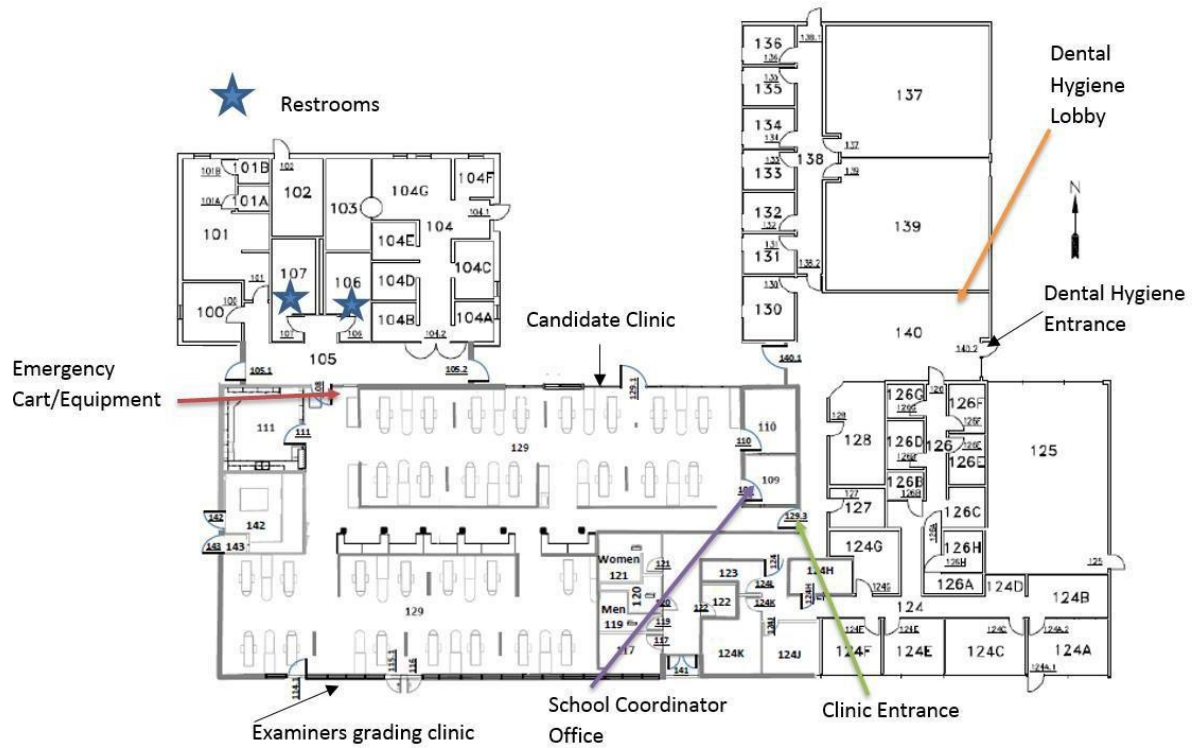

Required School-provided Expendable Dental Materials Appendices

APPENDIX A – Expendable Dental Hygiene Materials List Provided by Exam Site Host (Clark College) To be provided in sufficient quantities for all Dental Hygiene Candidates		
2x2 gauze squares	Cotton-tip applicators	Patient bib clips, disposable
Air/water syringe tips	Drinking cups	Patient napkins/bibs
Antimicrobial mouthwash	Face masks	Prophy paste
Anesthetic(s)	Facial tissue	Sanitizing materials
<ul style="list-style-type: none"> • Local anesthetic(s) • 3% Carbocaine plain • 4% Articaine 1:100,000 • 2% Lidocaine 1:100,000 • 4% Prilocaine 1:200,000 • 0.5% Marcaine 1:200,000 	Gloves	Soap
• Topical anesthetic(s)	• Gloves, nonlatex (S, M, L, XL)	Standard saliva ejectors
Autoclave bags, small	• Overgloves	Surface disinfectant
Autoclave bags, medium	Headrest covers	Syringe Needles (long & short)
Autoclave tape	Instrument trays, reusable	Tray covers
Barrier covers/tape	Paper towels	Trash bags

APPENDIX B – Expendable Local Anesthesia Materials List Provided by Exam Site Host (Clark College) To be provided in sufficient quantities for all Local Anesthesia Candidates		
2x2 gauze squares	Cotton-tip applicators	Patient bib clips, disposable
Air/water syringe tips	Drinking cups	Patient napkins/bibs
Antimicrobial mouthwash	Face masks	Sanitizing materials
Anesthetic(s)	Facial tissue	Soap
<ul style="list-style-type: none"> • Local anesthetic(s) • 3% Carbocaine plain • 4% Articaine 1:100,000 • 2% Lidocaine 1:100,000 • 4% Prilocaine 1:200,000 • 0.5% Marcaine 1:200,000 	Gloves	Standard saliva ejectors
• Topical anesthetic(s)	• Gloves, nonlatex (S, M, L, XL)	Surface disinfectant
Autoclave bags, small	• Overgloves	Syringe Needles (long & short)
Autoclave bags, medium	Headrest covers	Tray covers
Autoclave tape	Instrument trays, reusable	Trash bags
Barrier covers/tape	Paper towels	

APPENDIX C – Expendable Restorative Materials List Provided by Exam Site Host (Clark College) To be provided in sufficient quantities for all Restorative Candidates		
2x2 gauze squares	Drinking cups	Sanitizing materials
Air syringe tips	Face masks	Rod posts (mounting Typodont)
Amalgamator/Tricherator	Facial tissue	Soap
Amalgam scrap container(s)	Gloves, nonlatex (S, M, L, XL)	Surface disinfectant
Barrier covers/tape	Instrument trays, reusable	Tray covers
Cotton-tip applicators	Paper towels	Trash bags