

UNIVERSITY OF THE PACIFIC  
ARTHUR A. DUGONI  
SCHOOL OF DENTISTRY  
Dental Hygiene Program  
April 18-19, 2020

Exam Site information for Candidates  
Western Regional Examining Board (WREB)  
2020 WREB Hygiene Examination

University of the Pacific  
San Francisco Campus, Dugoni School of Dentistry  
155 5<sup>th</sup> Street, San Francisco, CA 94103  
415-780-2069 (Program Director)

**Exam Site Information for Candidates  
2020 WREB Dental Hygiene Exams**

**Table of Contents**

**1. School Facility and Services**

- Clinic Address, Building Access and Hours
- Parking
- Security and Emergency Services
- ATM Machine
- Food Services Onsite

**2. Preparing for the Exam**

- Patient Screening
- Radiographs
- Administration of Local Anesthetic – Practitioner Availability
- Dental Operatory Units
- Equipment, Instruments and Expendable Materials
- Sterilization Services

**3. During the Exam**

- Infection Control (Surface Asepsis)
- Medical Emergencies and Equipment

**4. Travel and Accommodation Information**

- Airport Information
- Ground Transportation
- Hotel Accommodation

**5. Appendices**

- Campus Map
- Clinic Floor Plan

- Expendable Dental Materials Lists

The University of the Pacific, Arthur A. Dugoni School of Dentistry is making its facility available to the Western Regional Examining Board (WREB) as a testing site only. This handout is intended to address questions you may have regarding the facility and its role in the examination. If you need any additional information or clarification, please contact the Dental Hygiene Program Director, Lory Laughter, at (415) 780–2069 or [llaughter@pacific.edu](mailto:llaughter@pacific.edu). However, please do not call the school for any interpretation of material contained in your Candidate Manual. Questions regarding the examination itself (content, patient requirements, paperwork/forms, etc.) should be directed to the WREB office (623) 209-5400.



## 1. School Facility and Services

### **Clinic Address, Building Access and Hours**

Dental Hygiene is located at the University of the Pacific Dugoni School of Dentistry, 155 5<sup>th</sup> Street, San Francisco, CA 94103. Building access will be through the entrance on Minna Street, just off 5<sup>th</sup>. Building hours for candidates are 6:00am-6:00pm each day. **Parking**

There is a parking lot located on the corner of Fifth and Mission and there are many other parking lots near the facility. Parking is at the driver's expense and we do not validate parking. Street parking is limited to metered parking and the fine for overtime parking is quite expensive and not recommended.

### **Security and Emergency Services**

There is 24-hour Security on campus and candidates will need to show their WREB candidate ID badge for entrance into the building.

To contact security email at [sf\\_security@pacific.edu](mailto:sf_security@pacific.edu) or call 415-929-6456.

For emergencies, dial 415-929-6411.

For the management of emergencies at our School, a medical crash cart is stationed in our Oral Surgery Department and on the 2nd floor corridor. An Oral Surgery faculty member will be on call throughout the course of the examination. If you should experience any type of medical emergency, follow the prompt of the emergency tags posted on all phones to activate the emergency team.

There are no ATM Machines on campus but those listed below are close:

- Bank of America ATM, Metreon, 101 4th St, SF
- Wells Fargo ATM, 760 Market St, SF

Services Onsite

We will not be offering food service onsite. There are many outside food establishments all around our School. At the Westfield Shopping mall, located at 5th and Mission (three blocks away), there is a food court with a variety of eateries available.

**2. Preparing for the Hygiene Exam**

Refer to the respective WREB Candidate Guide for a list of materials and armamentarium that the Candidate must provide.

Patient Screening

Available by appointment only. Candidates must provide their own instruments and gowns for screening. Make an appointment by contacting the School Coordinator, Lory Laughter at 415-780-2069 or [llaughter@pacific.edu](mailto:llaughter@pacific.edu)

Radiographs

All radiography will be monitor to monitor digital format. If you are planning to have any radiographs taken through our Dental School, you must make arrangements with our Radiology Department at (415) 929-6586. Payment for services must be paid prior to any exposures. Radiograph fees are as follows:

Periapical / Bitewing – first film	\$ 23.00
Periapical / Bitewing – each additional film	\$ 12.00
Bitewing survey – four films	\$ 33.00
Full-mouth survey – 18 films	\$ 75.00
Panoramic	\$ 75.00

Administration of Local Anesthetic – Practitioner Availability

Practitioners from the school are NOT AVAILABLE to deliver local anesthesia to candidates' patients.

here is no exception to this policy.

Dental Operatory Units

Each clinic operatory is equipped with a new Pelton-Crane unit, with operator and assistant chairs. There is no need to request for a left-handed user chair because our units can be used as left- or right-hand use.



Our units are fitted for Star hand pieces. Must use the connection on the right.



In each cubicle area, there is a red plastic sharps container. Place all needles and other used sharps in these receptacles.

Equipment, Instruments and Expendable Materials

- a. We will have technicians from our Building Operations available all day if you experience equipment malfunction. No handpieces, prophylaxis angles, equipment or instruments are available for rental.
- b. Operatories are equipped for hookup of ultrasonic devices that use a universal connection. No devices are available for rent.



the smaller connector nearest the grey knob.

Water connection for ultrasonic scaler under right side of chair. Power outlet also in this area. Note this is

- c. Disposable air-water syringe tips are used and will be available with the disposable supplies.
- d. Blood pressure cuffs or stethoscopes are not available for Candidate use. Please bring your own or share with another candidate.
- e. Expendable dental materials supplied by the school are noted in **Appendix A**. Items not listed are the responsibility of Candidate.

#### Sterilization Services

There will be no sterilization services available since there is no local anesthesia exam.

### **3. During the Exam**

#### Infection Control

Universal Precautions - The School of Dentistry requires the use of universal barrier protection (gloves, face masks, eyewear with side shields, and protective clothing during all direct patient contact. Barrier covers, nitrile gloves, side shields for eyewear, and facemasks will be made available, but you will be responsible for providing OSHA- acceptable eyewear for yourself and your patient and a disposable gown for yourself during all clinical procedures.

Clinic Attire – You must provide your own clinic attire, which must meet any standards imposed by WREB. Disposable clinic gowns may not be worn outside the clinic area or from one clinic to another.

Surface Asepsis – Each operatory will have disinfectant wipes available for surface disinfection of the clinic operatory (patient chair, operator and assistant carts/stools, light handles, counter tops, etc.).

#### Medical Emergencies and Equipment

A portable oxygen unit is available in the clinic and will be shown on the clinic tour. Medical Emergencies will be managed by the oral surgery faculty on call.

### **4. Travel and Accommodation Information**

#### Airport Information

Two airports, Oakland and San Francisco International, are accessible to the Dugoni School of Dentistry. From each airport, take the BART (Bay Area Regional Transport) train to the Powel Street Exit, follow signs to 5<sup>th</sup> Street and walk the two blocks to the dental school.

#### Ground Transportation

BART trains connect the airports with downtown San Francisco. The website can assist with planning for times and fares. Refer to: <https://www.bart.gov/> To travel around San Francisco refer to: <http://www.sftravel.com/article/how-get-around-san-francisco->



[transportation-basics](#) The Muni system provides bus service. Taking BART to the Powell street station requires only a short three block walk. If driving, parking at the Fifth and Mission parking garage requires only crossing Minna street to the dental school. Parking costs are around \$35/day but less for a shorter period of time.

Additional information and details are listed on the Dugoni website:

<http://www.dental.pacific.edu/about/locations-and-visitor-information/map-directions-and-parking>

#### Hotel Accommodation

There are many hotels in downtown San Francisco relatively close to the school. Some hotels listed below are within 3-6 miles from downtown. Please search for additional accommodations:

WESTIN	335 POWELL STREET	(415) 397-7000
MARRIOTT	480 SUTTER STREET	(415)398-8900
HOTEL ZETTA	55 – 5TH STREET	(415) 543-8555
HILTON	333 O'FARREL STREET	(415) 771-1400
COMFORT INN by the Bay	2775 VAN NESS AVENUE	(415) 928-5000
COVENTRY MOTOR INN	1901 LOMBARD STREET	(415) 567-1200
COW HOLLOW MOTOR INN	2190 LOMBARD STREET	(415) 921-5800
DE VILLE MOTEL	2599 LOMBARD STREET	(415) 346-4664
EDWARD II INN	3155 SCOTT STREET	(415) 922-3000
LANAI MOTEL	2361 LOMBARD STREET	(415) 931-7810
MANOR MOTEL	2358 LOMBARD STREET	(415) 922-2010
S.F. MOTOR INN	1750 LOMBARD STREET	(415) 921-1842
MIYAKO HOTEL	1625 POST STREET	(415) 533-4567
BEST WESTERN	1800 SUTTER STREET	(415) 921-4000
HOLIDAY INN	PINE AND VAN NESS	(415) 441-4000
BROADWAY MANOR INN	2201 VAN NESS AVENUE	(800) 727-6239
THE QUEEN ANNE	1590 SUTTER STREET	(800) 227-3970
THE PICKWICK	85 5 <sup>TH</sup> STREET	(415) 267-3940

Please contact your choices directly for information about room rates, and facilities. Do not call the school for this information. Please note this list is for your convenience. We do not recommend one over the other.



## 5. Appendices

Campus Map-Campus consists of five floors above this floor plan

FIFTH & MISSION PARKING GARAGE HERE

First floor

Enter here

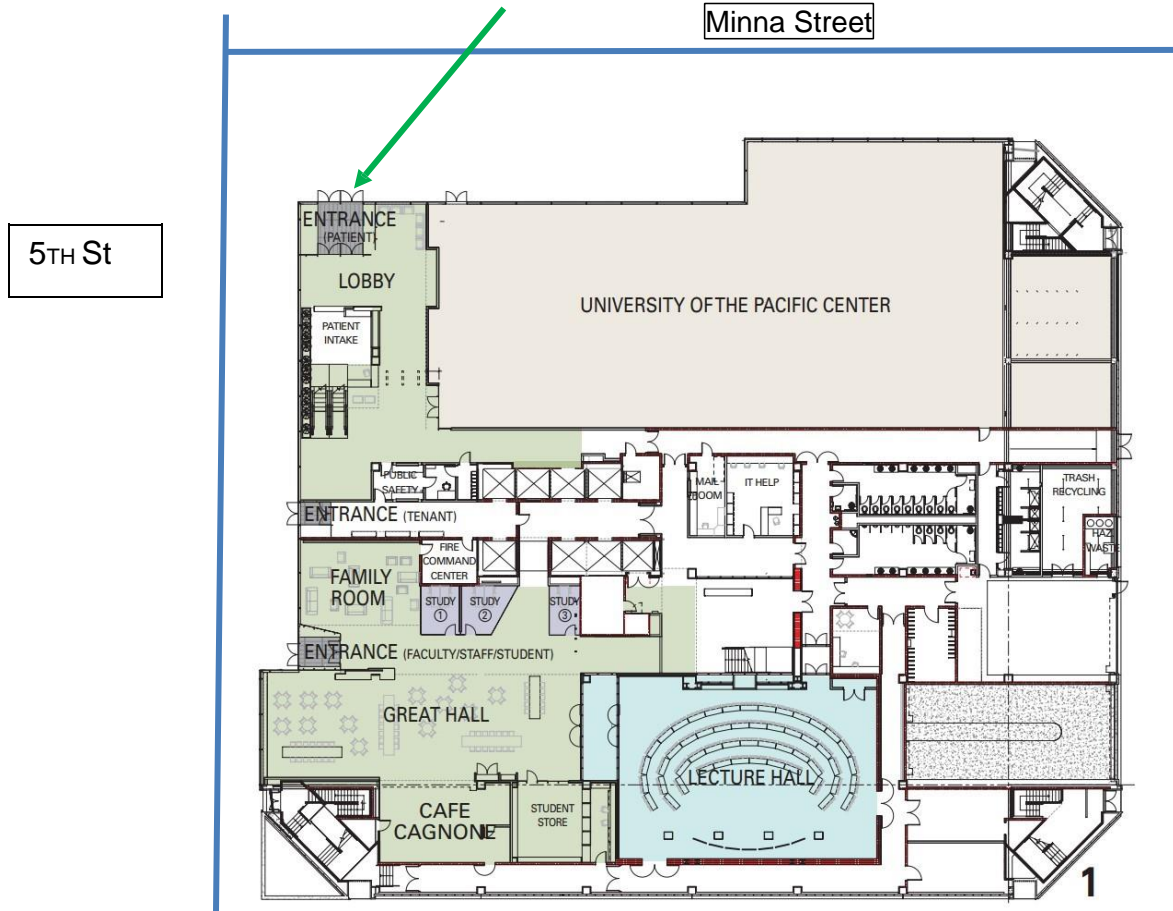



Expendable Dental Materials Lists:

<b>APPENDIX A – Expendable Dental Hygiene Materials List                      Provided by Exam Site Host (UOP)                      To be provided in sufficient quantities for all Dental Hygiene Candidates</b>		
2x2 gauze squares	Cotton-tip applicators	Patient bib clips, disposable
Air/water syringe tips	Drinking cups	Patient napkins/bibs
Antimicrobial mouthwash	Face masks	Prophy paste
Anesthetic(s)	Facial tissue	Sanitizing materials
• Local anesthetic(s) with and without vasoconstrictor	Gloves	Soap
• Topical anesthetic(s)	• Gloves, nonlatex (XS, S, M, L, XL)	Standard saliva ejectors
Autoclave bags, small	Headrest covers	Surface disinfectant
Autoclave bags, medium	Instrument trays, disposable	Syringe Needles 25L & 27S
Autoclave tape	Paper towels	Tray covers
Barrier covers/tape		Trash bags