

# **Tulsa Community College**



**Exam Site Information for Candidates  
Western Regional Examining Board (WREB)  
2019 WREB Hygiene Examination**

**Tulsa Community College  
Metro Campus  
909 S. Boston Ave, Tulsa OK, 74119  
(918)595-7022**

**Exam Site Information for Candidates**  
**2019 WREB Dental Hygiene, Local Anesthesia & Restorative Examinations**

**Table of Contents**

**1. School Facility and Services**

- Clinic Address, Building Access and Hours
- Parking
- Security and Emergency Services
- ATM Machine
- Food Services Onsite

**2. Preparing for the Exam**

- Patient Screening
- Radiographs
- Administration of Local Anesthetic – Practitioner Availability
- Dental Operatory Units
- Equipment, Instruments and Expendable Materials
- Sterilization Services

**3. During the Exam**

- Infection Control (Surface Asepsis)
- Medical Emergencies and Equipment

**4. Travel and Accommodation Information**

- Airport Information
- Ground Transportation
- Hotel Accommodation

**5. Appendices**

- Campus Map
- Clinic Floor Plan
- Expendable Dental Materials Lists

## 1. School Facility and Services

### • Location, Building Access and Hours:

- Alfred Philips Building, 909 S. Boston Ave, Tulsa OK 74119
  - Enter building at 9<sup>th</sup> and Cincinnati (NE corner), Take elevator to 3<sup>rd</sup> floor, MP 300
- School Coordinator – Carolyn Crabtree, cell (918)805-1585
- Clinic Support – Daniele Dennison, cell (918)688-5809
- Alfred Philips Building Hours: Sunday - Saturday 6:00am – 6:00pm, Contact Campus Police at (918) 595-8888, for any issues.

### • Parking:

- Candidates and Patients may park in any TCC parking lot while visiting the TCC Dental Hygiene Clinic. TCC parking lots are indicated with blue lines on the ground. TCC owns a parking lot on each corner at 9th & Boston, 10th & Cincinnati, 11th & Cincinnati, and 12th & Cincinnati. Visit <http://www.tulsacc.edu/campus-locations/metro-campus> for a detailed map.
- If you choose to park at a meter that is closer to our building, you are responsible for paying the meter. Meters are free after 5pm Monday- Friday and all-day Saturday and Sunday. Note: Parking meters are only good for up to 2 hours. It is highly encouraged to park in a TCC parking lot.
- TCC is not responsible for any parking tickets Candidates and/or Patients may incur.

### • Security and Emergency Services:

- To contact TCC Campus Police dial (918)595-8888
  - In case of emergency dial 911
- Emergency Call Boxes are located in most TCC parking lots

### • ATM Machine:

- An ATM is available on the 2<sup>nd</sup> floor of the Alfred Philips building hallway. It is located South of the elevators passed the writing center to the left.

### • Food Services Onsite:

- The MC Café is located on the 2<sup>nd</sup> floor of the Student Union Building (Hours: Monday - Friday 7:30am to 1:30pm)
- Vending machines for snacks and drinks are located on the 2<sup>nd</sup> Floor of the Alfred Philips Building, south of the elevators.
- Snacks and drinks are also available in the bookstore, located on the 1<sup>st</sup> floor of the Student Union Building. (Hours: Monday-Thursday 8:00am to 6:00pm, Friday 8:00am to 5:00pm)

## 2. Preparing for the Hygiene Exam

### • Patient Screening:

- Facility will **not** be available for screening

- **Radiographs:**
  - TCC Clinic uses NOMAD Pro handheld x-ray unit, instructions for use are located on the portable nomad cart.
  - Images are digital but may be printed on regular copy paper, if needed
- **Administration of Local Anesthetic:**
  - Option A: Practitioner(s) from the school is **NOT AVAILABLE** to administer local anesthesia to Candidate Patients. There are no exceptions to this policy.
- **Equipment, Instruments and Expendable Dental Materials:** Refer to the respective WREB Candidate Guide for a list of materials and armamentarium that the Candidate must provide.

**A. Handpiece and Proply Angle Hookups:**

1. Standard hose connectors at each unit.
2. Handpieces are NOT provided for Candidate use.
3. Candidates must bring their own handpieces.

**B. Sonic/Ultrasonic Devices:**

1. Standard quick disconnect air/water hookups for sonic/ultrasonic devices
2. Sonic/ultrasonic devices will **NOT** be provided by facility.
3. Candidates must bring their own sonic/ultrasonic devices.

**C. Air/Water Syringe Tips:**

1. Disposable plastic tips are provided

**D. Blood Pressure Cuffs and Stethoscopes:**

1. Blood Pressure Cuffs and Stethoscopes are **NOT** provided for candidate use.
2. Candidates must bring their own Blood Pressure Cuffs and Stethoscopes.

**E. Expendable Materials:**

1. Expendable dental materials supplied by the school are noted below in **Appendix A**.

- **Sterilization Services:**
  - Sterilization Services will be available, at the clinic, daily from 7:00am to 6:00 pm for the duration of the exam.

**3. During the Clinical Exam**

• **Dental Operatory Units:**

- Workstations are Hygiene Proma A series
- Chairs are Royal

• **Infection Control (Surface Asepsis):**

Using paper towels dampened with water **clean** the following surfaces: (place paper towels under running water in sink to dampen, be sure paper towels are wet enough but not dripping with water)

- All areas of cabinetry (including sides, tops, back, drawer handles, etc.)
- All vinyl on clinician chair

- All vinyl on patient chair (including plastic cover for foot area)
  - *If vinyl needs to be spot cleaned for a hard to clean stain, then a premixed solution of Ivory soap and water in a spray bottle may be used. After cleaning with the solution, the “soap” film must be wiped off with water. If Ivory soap and water does not remove the stain alert the Academic Support Technician.*

Retrieve Birex disinfectant wipes from unit cabinet then **clean** the following surfaces, throwing away often:

- light handles, switch, and arm (**do not** wipe light shield – it will cloud the plastic)
- bracket tray, including arm
- air/water syringe, handpiece connectors, suction connectors, holders, and hoses
- countertops
- sink rim, soap pump and faucet handle
- clinician’s chair lever
- outside of personal storage container, *if using separate container*
- cord box at the foot of the patient chair
- any other surfaces that need cleaned

Repeat the above Birex cleaning step to **disinfect** all surfaces listed above. Allow treated surfaces to soak for 2 minutes to achieve disinfection before placing supplies for unit set-up.

Retrieve two fresh Birex disinfectant wipes

- Wipe Birex container and place back in unit cabinet
- Wipe heavy-duty nitrile gloves, remove and place under unit sink

Place foil barriers on:

- Patient mirror handle
- clinician chairs lever

Place cover-all barrier on dental light switch

Place air/water syringe tip, saliva ejector and HVE

Place plastic barriers on:

- patient headrest (clear liner: fold ends of bag over at the top backside of headrest)
- clinician chair (clear liner: tie behind chair)

- bracket tray and controls (clear liner)
- air/water syringe (tube sleeve)
- suction hoses (tube sleeve)

Place light handle barriers on light handles

Tape Ziploc to counter. Use biohazard sticker only as needed according to OSHA guidelines for contaminated waste.

- **Dental Unit Water System**

- Distilled water only must be used in the unit water bottle. The bottle holds enough water for a normal day's use. Heavy users may require a refill during procedures. The bottle simply unscrews counterclockwise for refilling. Use caution when filling bottle as to not overfill the bottle because it will leak all over the floor. Return the bottle and replace turning clockwise until screwed on tight.
- NOTE: There is an O-ring/washer that must be seated all the way up into the bottle mount. If the O-ring/washer is not seated properly then the water will not flow through the dental unit for the air/water syringe or handpiece connectors. Use caution when removing and replacing bottles as to not lose or throw away the O-ring/washer.

- A. **Hazardous Waste Disposal (exam-type specific):**

- 1. **Hygiene:** A white metal foot pedal operated Biohazard bin is located on the clinic floor.

- B. **Sharps Disposal:**

- 1. Sharps Containers are located on countertops at all units.

- **Emergency Medical Equipment:**

- Emergency cart and portable oxygen tank are in the clinic, outside MP-304C
- AED located in the clinic, on top of emergency cart, outside MP-304C

#### 4. **Travel and Accommodation Information**

- **Airport Information:** Tulsa International Airport

- <https://www.tulsaairports.com/>
- 7777 E Apache St, Tulsa OK (918)838-5000

- **Ground Transportation:**

- Your Ride (888)610-5503
- Enterprise Rent-A-Car (918)583-4880
- Tulsa Taxi & Airport Service (918)934-0000
- Tulsa Airport Taxi (918)834-2400

- **Hotel Accommodations:** We have multiple hotels within a 3-mile radius. The six listed below show rates between \$90-\$150.
  - Doubletree by Hilton Downtown, 616 W 7<sup>th</sup> St, Tulsa OK 74127, (918)587-8000
  - Hyatt Regency Tulsa, 100 E 2<sup>nd</sup> St, Tulsa OK 74103 (918)234-1234
  - Hampton Inn & Suites Downtown, 211 W 3<sup>rd</sup> St, Tulsa OK 74103 (918)949-6900
  - Fairfield Inn & Suites by Marriott 111 N Main St, Tulsa OK 74103 (918)879-1800
  - Aloft Tulsa Downtown, 200 Civic Center, Tulsa OK 74103 (918)974-8200
  - Holiday Inn Tulsa City Center, 17 W 7<sup>th</sup> St, Tulsa OK 74119 (918)585-5898

## 5. Maps

- **Campus Map:**

- Alfred Philips Building, 909 S. Boston Ave, Tulsa, OK 74119
  - Enter building at 9<sup>th</sup> & Cincinnati, Take elevator to 3<sup>rd</sup> floor, MP 300
- Visit <http://www.tulsacc.edu/campus-locations/metro-campus> for additional maps and more detailed information

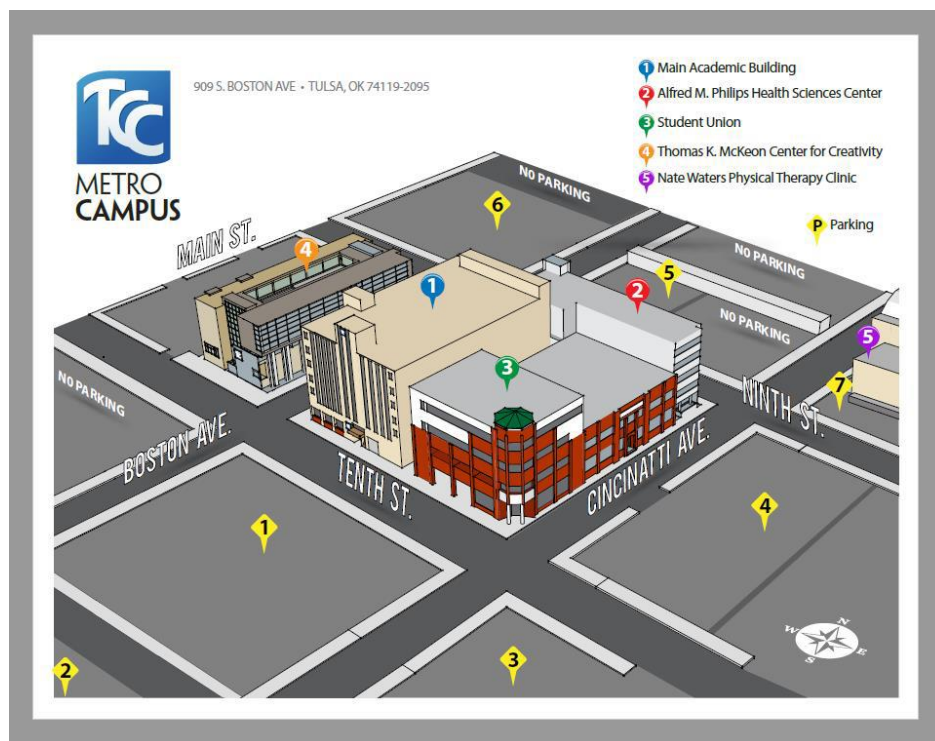

- Clinic Floor Plan:

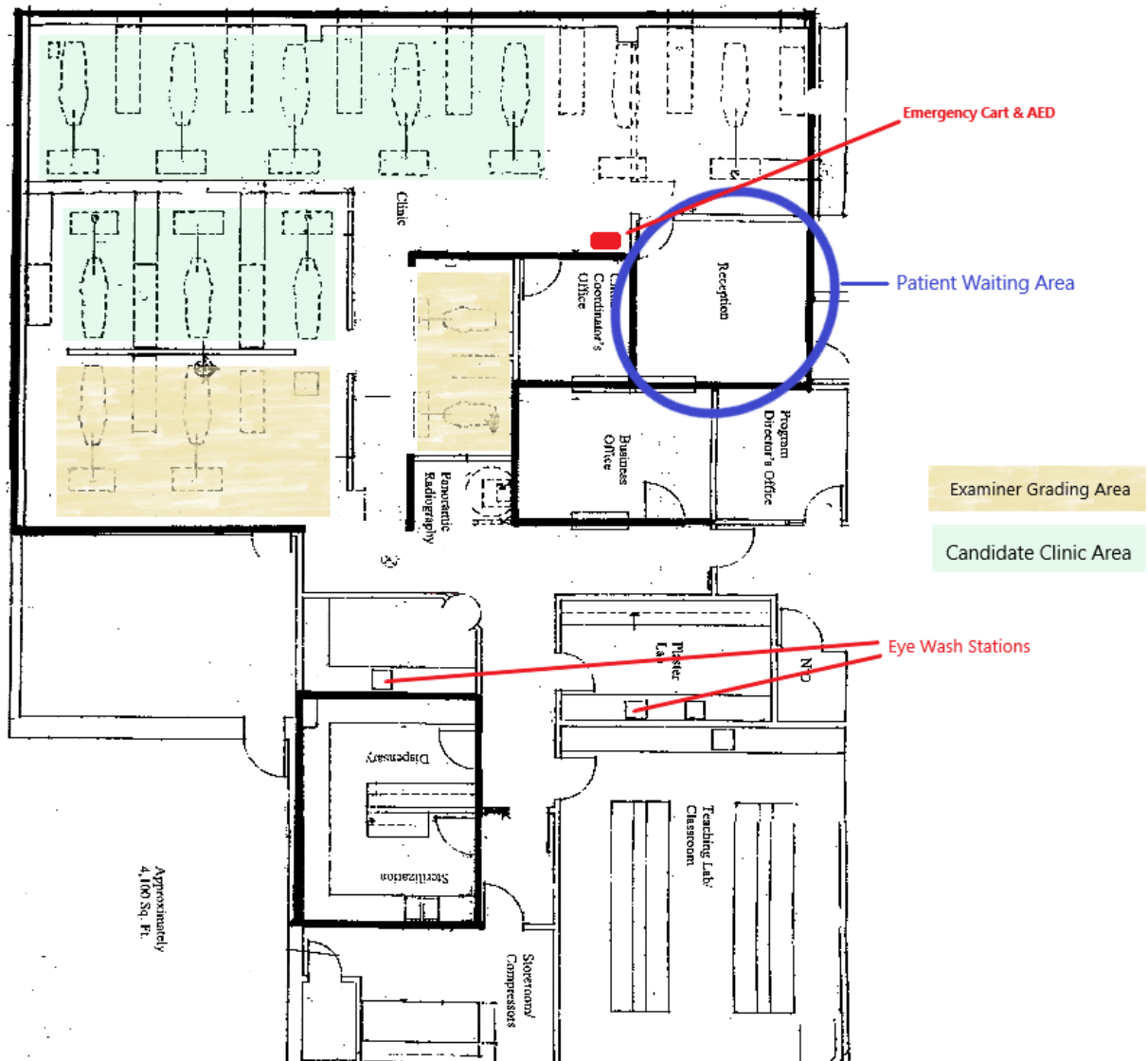

Tulsa Community College, Dental Hygiene Clinic Floor Plan 2019



## Expendable Dental Materials Appendices

<b>APPENDIX A – Expendable Dental Hygiene Materials List                      Provided by Exam Site Host (School)                      To be provided in sufficient quantities for all Dental Hygiene Candidates</b>		
2x2 gauze squares	Cotton-tip applicators	Patient bib clips, disposable
Air/water syringe tips	Drinking cups	Patient napkins/bibs
Antimicrobial mouthwash	Face masks	Prophy paste
Anesthetic(s)	Facial tissue	Sanitizing materials
• Local anesthetic(s)	Gloves	Soap
• Topical anesthetic(s)	• Gloves, nonlatex (S, M, L, XL)	Standard saliva ejectors
Autoclave bags, small	• Over gloves	Surface disinfectant
Autoclave bags, medium	Headrest covers	Syringe Needles
Autoclave tape	Instrument trays, disposable	Tray covers
Barrier covers/tape	Paper towels	Trash bags