

San Joaquin Valley College



Exam Site Information for Candidates
Western Regional Examining Board (WREB)
2019 WREB Hygiene Examination

San Joaquin Valley College (SJVC)
ONTARIO CAMPUS
4580 Ontario Mills Parkway
Ontario, CA 91764

Exam Site Information for Candidates
2019 WREB Dental Hygiene, Local Anesthesia & Restorative Examinations

Table of Contents

1. School Facility and Services

- Clinic Address, Building Access and Hours
- Parking
- Security and Emergency Services
- ATM Machine
- Food Services Onsite

2. Preparing for the Exam

- Patient Screening
- Radiographs
- Administration of Local Anesthetic – Practitioner Availability
- Dental Operatory Units
- Equipment, Instruments and Expendable Materials
- Sterilization Services

3. During the Exam

- Infection Control (Surface Asepsis)
- Medical Emergencies and Equipment

4. Travel and Accommodation Information

- Airport Information
- Ground Transportation
- Hotel Accommodation

5. Appendices

- Campus Map
- Clinic Floor Plan
- Expendable Dental Materials Lists

1. School Facility and Services

- **Location, Building Access and Hours:**

Dental hygiene **CLINIC** address:
4580 Ontario Mills Parkway
Ontario, CA 91764

Telephone number: (909) 291-8121

Contact name for questions regarding the school, equipment, etc.
Leslie Nazaroff, RDH, DrPH

Directions to Clinic entrance is located on the WEST entrance

Hours building open 6:00am-6:00pm daily for duration of exam

- **Parking:** Candidates and Patients may park in any area designated as STUDENT PARKING. Please DO NOT park in any slot along the perimeter of the building. There are no parking fees.
- **Security and Emergency Services:** Onsite Security will be available throughout the examination. The Site Host and WREB Coordinator will have immediate contact availability.
- **ATM Machine:** NONE AVAILABLE.
- **Food Services Onsite:** NONE AVAILABLE.

2. Preparing for the Hygiene Exam

- **Patient Screening:** Patient screening by Candidates will NOT be available during at any time. In addition, it is imperative to note that SJVC will NOT have additional patients available for the examination to serve as back-up patients.
- **Radiographs:** Candidates will be allowed to expose and process digital radiographs ONLY during the WREB examination as deemed necessary by the WREB personnel. \$30 for use of the kit and phosphorous plates; \$5.00 for photo quality print-out. All payments must be in cash.
- **Administration of Local Anesthetic:**
 - A. Practitioners from the school are **NOT AVAILABLE** to administer local anesthesia to Candidate Patients. There are no exceptions to this policy.
- **Equipment, Instruments and Expendable Dental Materials:** Refer to the respective WREB Candidate Guide for a list of materials and armamentarium that the Candidate must provide.
 - A. **Handpiece and Prophy Angle Hookups:** SJVC will NOT have any handpieces or prophy angles available during the examination. However, for Candidates who

choose to bring their own handpieces we have a 4-Hole Slow speed hose connection.

B. Sonic/Ultrasonic Devices: All operatories are equipped with a **Dentsply 30K Mounted Magnostriuctive Ultrasonic** device for your use. You must supply your own handpiece and inserts. However, these are available for rent: \$30.00 for the handpiece and \$30.00 for each insert (100 FSI and 1000 FSI are available). All payments must be in cash. Candidates who wish to use their own Ultrasonic device should not the following compatibility requirements: the ADEC Dental Chair has a Quick-Connect water source to adapt a male hose connection.

C. Air/Water Syringe Tips: Candidates are provided disposable Air/Water Syringe Tips. Should you need additional, they will be available at the Sterilization Window

D. Blood Pressure Cuffs and Stethoscopes: Candidates must provide their own Blood Pressure Cuffs and Stethoscopes.

E. Expendable Materials: See Appendix

- **Sterilization Services:** Sterilization will be available ONLY for Candidates retaking onsite Sunday afternoon. **If the Candidate is testing Sunday morning, there is no guarantee that the instrument cycle will be complete in time for the retake examination. Therefore, it is advisable to plan ahead. Candidates must clearly print their full name and date on the autoclave bags, available at each unit. Candidates may retrieve their instruments when they are permitted back on the floor during their Sunday afternoon exam time. No sterilization will be available after the last test session.**

3. During the Clinical Exam

- **Dental Operatory Units:** SJVC Dental Hygiene Clinic is equipped with ADEC Dental Patient Chairs that are capable to support a left-handed or right-handed Candidate. There will be an adjustable clinician chair. Each dental unit has its own counter and a shared sink between two units.

Infection Control (Surface Asepsis): Note that proper PPEs should be worn at all appropriate times (gloves, eyewear, gown and mask). Candidates are expected to wear scrubs during the examination. Heavy gloves are recommended during disinfectant and break down of unit. All candidates are required to adhere to the following infection control steps:

- **Unit Set-Up**
 - ♦ With **Cavi-Wipes** surface disinfectant, wipe down:
 - Unit control arm, trays and all hoses
 - Dental patient chair and candidate chair upholstery
 - Dental unit light handles and light switch
 - Dental unit counter top
 - Any personal items used (i.e., protective eye wear, bib clips)
 - ♦ **Purge** water unit lines for 2 minutes at the beginning of the day
 - ♦ Plastic **bag** or **sleeve barriers** (included on the set-up tray) will be placed on the following:

- Full chair cover (bag)
 - Unit control arm (bag)
 - Unit assistant arm (bag)
 - Light handle (sleeves)
 - Air water syringes, suctions, cavitron handle (sleeves)
 - ♦ Place plastic **tape** (wrap – available at each unit) on the following:
 - Unit arms where contact is anticipated
 - Patient chair arms
 - Levers and switches
 - Unit control panel
 - Candidate clinician chair where contact is anticipated (i.e., control levers)
 - ♦ Unit counter tops should be considered “clean” for paperwork and additional candidate items
- **During Examination**
 - ♦ **Please use caution when refilling the unit water bottle**
 - Hands should be **clean** when removing the bottle (or use of **over-gloves** – found next to the paper towels at each sink). **At no time** should the water tubing be touched; the refilled bottle should be guided back **without** the use of holding the tubing.
 - **Unit Break Down**
 - ♦ All sharps are to be placed in sharps containers located at each sink – at no time should an “uncapped” needle be on a candidate’s tray. In addition, disposable needle guards will be available on each set-up tray.
 - ♦ Place all disposables and barriers in center of the chair (on chair cover)
 - Roll up and discard (trash receptacles are at each sink)
 - ♦ With Cavi-Wipes surface disinfectant, repeat the steps above using **wipe-dry-wipe** (fresh wipe for second pass)
 - Use caution around any electrical controls and switches (do not over saturate these areas)
 - ♦ Purge water unit for 30 seconds
 - You may be requested to setup the unit for the next clinician
- A. Hazardous Waste Disposal (exam-type specific):**
- **Hygiene:** Unless gauze is dripping with blood, all saturated gauze used during the exam may go into the chairside trash bag and then into the trash receptacle at the sink. If you to have blood/saliva-soaked waste that drips, notify the sterilization assistant for proper disposal.
- B. Sharps Disposal:** Sharps containers are located at the sink (opening to the right of the faucet). Candidates should use a one-handed recapping for safe needle removal. All contaminated needles must be placed in the sharps container.

- **Emergency Medical Equipment:** Emergency equipment is located in sterilization. Emergency kit and oxygen tank will be located near the Chief Examiner. The Perio Retriever and Ice Packs are located in the North Wall upper cabinet. The AED, and First Aid Kit are located on the East Wall, just as you enter sterilization. A fire extinguisher is located in sterilization. An eye wash station is on the sink faucet near radiology. In the event of an emergency, notify the Chief Examiner. At the discretion of the Chief Examiner, the Site Coordinator will initiate the EMT by calling 911 as indicated.

Candidates are encouraged to locate their nearest exit from the clinic and orientation room. In the event of an emergency, all candidates and patients will exit through the closest exit.

4. Travel and Accommodation Information

- **Airport Information:** Ontario Airport
- **Ground Transportation:** Taxi, Uber, Car Rentals
- **Hotel Accommodations:**

Hotel	Address	Phone	Estimate	Website
Best Western	3400 Shelby St Ontario, CA	909.466.9600	~ \$100/night	http://book.bestwestern.com/
Country Inn (walking distance)	4674 Ontario Mills Pkwy Ontario, CA	909.204.5365	~ \$90/night	http://www.countryinnontario.com/
Double Tree	222 N. Vineyard Ontario, CA	909.937.0900	~ \$140/night	http://www.hilton.com/search/dt/US/CA/Ontario?WT.srch=1

- Note that the Country Inn is one-minute walking distance from the campus.
- Ontario Mills shopping center is a five-minute walk.

5. Maps

- **Campus Map:** Include map of campus and directions to clinic

SJVC
Ontario Campus - 1st floor

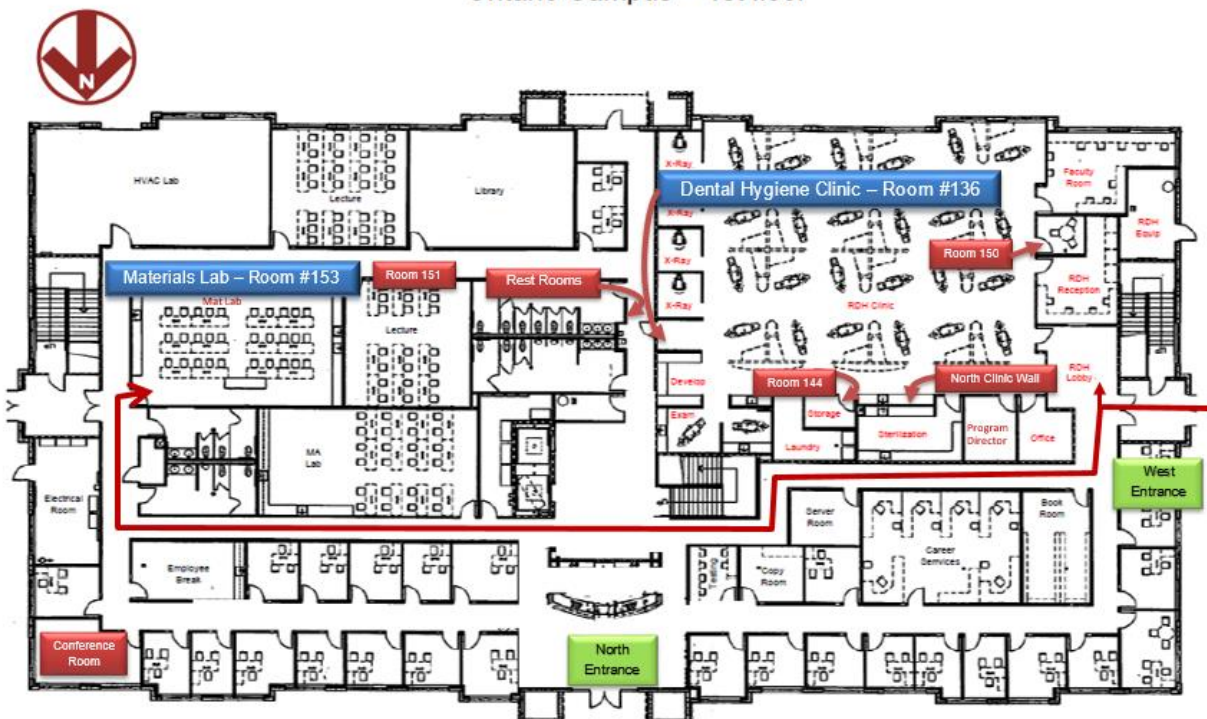

C

- **Clinic Floor Plan:** Indicate Patient waiting area, Candidate clinic, Examiner grading area, areas of emergency equipment



Expendable Dental Materials Appendices

APPENDIX A – Expendable Dental Hygiene Materials List Provided by Exam Site Host (School) To be provided in sufficient quantities for all Dental Hygiene Candidates		
2x2 gauze squares	Cotton-tip applicators	Patient bib clips, disposable
Air/water syringe tips	Drinking cups	Patient napkins/bibs
Antimicrobial mouthwash	Face masks	Prophy paste
Anesthetic(s)	Facial tissue	Sanitizing materials
• Local anesthetic(s)	Gloves	Soap
• Topical anesthetic(s)	• Gloves, nonlatex (S, M, L, XL)	Standard saliva ejectors
Autoclave bags, small	• Overgloves	Surface disinfectant
Autoclave bags, medium	Headrest covers	Syringe Needles 25g short/long
Autoclave tape	Instrument trays, disposable	Tray covers
Barrier covers/tape	Paper towels	Trash bags