

College of Southern Nevada



Exam Site Information for Candidates
Western Regional Examining Board (WREB)
2019 WREB Hygiene Examination

College of Southern Nevada
West Charleston Campus
6375 West Charleston Blvd., Building A
Las Vegas, Nevada 89146
702-651-5851

Exam Site Information for Candidates
2019 WREB Dental Hygiene, Local Anesthesia & Restorative Examinations

Table of Contents

1. School Facility and Services

- Clinic Address, Building Access and Hours
- Parking
- Security and Emergency Services
- ATM Machine
- Food Services Onsite

2. Preparing for the Exam

- Patient Screening
- Radiographs
- Administration of Local Anesthetic – Practitioner Availability
- Dental Operatory Units
- Equipment, Instruments and Expendable Materials
- Sterilization Services

3. During the Exam

- Infection Control (Surface Asepsis)
- Medical Emergencies and Equipment

4. Travel and Accommodation Information

- Airport Information
- Ground Transportation
- Hotel Accommodation

5. Appendices

- Campus Map
- Clinic Floor Plan
- Expendable Dental Materials Lists

1. School Facility and Services

- **Location, Building Access and Hours:** CSN Dental Hygiene CLINIC
6375 West Charleston Blvd. Building A,
Please contact either Carole Brew at carole.brew@csn.edu or Conrad Basilio at Conrad.basilio@csn.edu, for questions regarding the school, equipment, etc. Candidates and patients will enter through the main entrance of Building A located on the northwest corner of the campus, near Charleston and Torrey Pines; building is open from 6:30am-6:00pm for duration of exam.
- **Parking:** Please park in the lot on the Northwest corner of the campus adjacent to the entrance of Building A labeled “Dental Hygiene Clinics.” There is no charge or parking permits required for parking. Candidates will not be allowed to enter through any other door during the examination days. Please refer to the CSN map on page 6.
- **Security and Emergency Services:** Each parking lot is equipped with a designated emergency phone kiosk. Security can also be accessed by calling (702) 651-5317. Security is available 24 hours.
- **ATM Machine:** Available in the lobby of Building D.
- **Food Services Onsite:** There are vending machines in building A for drinks and snacks. Directly across the street from the campus is the Charleston Festival Plaza with fast food restaurants that include: Capriotti’s, Chipotle, Tropical Smoothie, and McDonalds, as well as Denny’s.

2. Preparing for the Hygiene Exam

- **Patient Screening:** Clinical and radiographic facilities at the school will be available Thursday, June 6, from 9:00am to 1:00pm on a space available basis. Candidates will need to provide their own sterile screening instruments. Appointments must be arranged through the Clinic Manager, Conrad Basilio at conrad.basilio@csn.edu or Carole Brew at carole.brew@csn.edu. No treatment other than screening (clinical and radiological examination) will be permitted.
- **Radiographs:** It is strongly recommended that candidates expose radiographs for the examination prior to arriving at the CSN Dental Hygiene Clinic. Candidates have access to digital x-rays only prior to the examination for digital imaging in Radiographic facilities on Thursday, June 6, from 9:00AM to 1PM. Arrangements must be made with Carole Brew at 702-651-5851. There are 4 radiographic machines as well as a Digital Panoramic machine in the Radiographic bay.
Rental of Rinn film holding devices: \$10.00 (to be paid in cash)
Photographic paper for printing digital images: \$5.00 per sheet (to be paid in cash)
- **Administration of Local Anesthetic:** Candidates who are unable to administer local anesthesia themselves should contact the Southern Nevada Dental Hygiene Association (SNDHA) for an available list of licensed Nevada practitioners who will be available during the exam to administer local anesthesia. The fee for administering local anesthesia is \$150 cash paid to the licensed Nevada

practitioner.

Arrangements for local anesthesia need to be made ahead of time as there will be no one on staff to perform local anesthesia, in the event that the candidate fails the local anesthesia board. For a list of available licensed Nevada practitioners you can email Missy Abel at missy.abel@csn.edu or Carole Brew at carole.brew@csn.edu

- **Sterilization Services:** We will sterilize instruments for those who take anesthesia and for one's retesting the WREB exam. Arrangements will be made with the floor monitor and the candidate to get their instruments back prior to the exam. Instruments to be sterilized must have the **candidate's number** on the sterilization pouches.
Candidates must let floor monitor know ASAP their need to have instruments sterilized.

3. During the Clinical Exam

- **Dental Operatory Units:** There are 20 ADEC-Cascade chairs with front delivery systems. Each dental unit has one hose for a slow speed hand-piece. Connections are a standard 2-hole 4 pin connection. All units have two 3-way air-water syringes. The syringe tips are provided. All units have an air and water source for ultrasonic scalers. The ultrasonic water source accepts a 1/4" female quick disconnect and the air-line source accepts a 3/8" male quick disconnect.



NOTE: The school does not have any adapters available to alter this configuration. Candidates should bring their own adapter or an ultrasonic that fits the unit. Any questions concerning clinic equipment should be directed to Conrad Basilio at conrad.basilio@csn.edu.

THE COLLEGE DOES NOT RENT EQUIPMENT.

- **Infection Control (Surface Asepsis):** The school infection control policy requires all candidates to wear a clinic jacket that covers the wrists and collar bones. No open toed clinic shoes may be worn in the clinic. Students must bring their own protective eyewear. Masks and non-latex gloves are available to candidates. Disinfecting wipes are provided at each operatory. Candidates must pre-clean and surface disinfect countertops and operatory chairs prior to and after use.

A. Hazardous Waste Disposal (exam-type specific):

- **Hygiene:** All biohazard waste is deposited in a red biohazard bag/container, to include items saturated with blood and or saliva, gauze,

- cotton rolls, saliva ejectors, HVE tips and gloves with blood on them.
- **Local Anesthesia:** Dispose of needles and anesthetic cartridges in designated sharps containers, only.
- **Sharps Disposal:** A wall-mounted sharps container is accessible between operatories.

B. Emergency Medical Equipment: An emergency cart with oxygen tank is located on the south wall. In the event of an imminent danger emergency involving a weapon, a panic button is located above the emergency cart. In the advent of an emergency the candidate should yell “SNOWBALL” and flip the emergency call button located on the wall of the operatory in the up position. The candidate should stay with the patient and initiate basic life support, if needed, place blood pressure cuff if basic life support is not needed. At the same time floor monitors would be responding with a call to 911 and CSN security if needed.
For all other emergencies please contact the Exam Floor monitor and/or Chief Examiner.

4. Travel and Accommodation Information

- **Airport Information:** McCarran International Airport, 5757 Wayne Newton Blvd. Las Vegas, Nevada 89119
- **Ground Transportation:** Las Vegas taxi companies: Ace/ABC Union/ANLV/Vegas Western Cab Company (702) 888-4888; Deluxe Taxicab Service (702) 567-0557; Desert Cab Company (702) 386-9102; Henderson Taxi Company (702) 384-2322; Western Cab Company (702) 736-8000; Whittlesea/Blue Cab Company (702) 384-6111; Yellow/Checker/Star Cab (702) 873-2000
- **Hotel Accommodations:** Hotels located within a 10 to 15 minute drive.
 - Arizona Charlie’s Casino & Hotel
740 S. Decatur Blvd., Las Vegas, NV 89107 702-258-5200
 - Fiesta-Rancho Hotel Casino & Hotel
2400 N. Rancho Dr., Las Vegas, NV 89130 702-631-7000
 - Las Quinta Inn and Suites
9570 W. Sahara Ave., Las Vegas, NV 89117
702-243-0356
 - Suncoast Hotel & Casino
9090 Alta Dr., Las Vegas, NV 89145
702-636-7111
 - Texas Station Gambling Hall & Hotel
2101 Texas Star Lane, N. Las Vegas, NV 89032 702-631-1000

5. Maps

- **Campus Map:** See page 6
- **Clinic Floor Plan:** See page 7

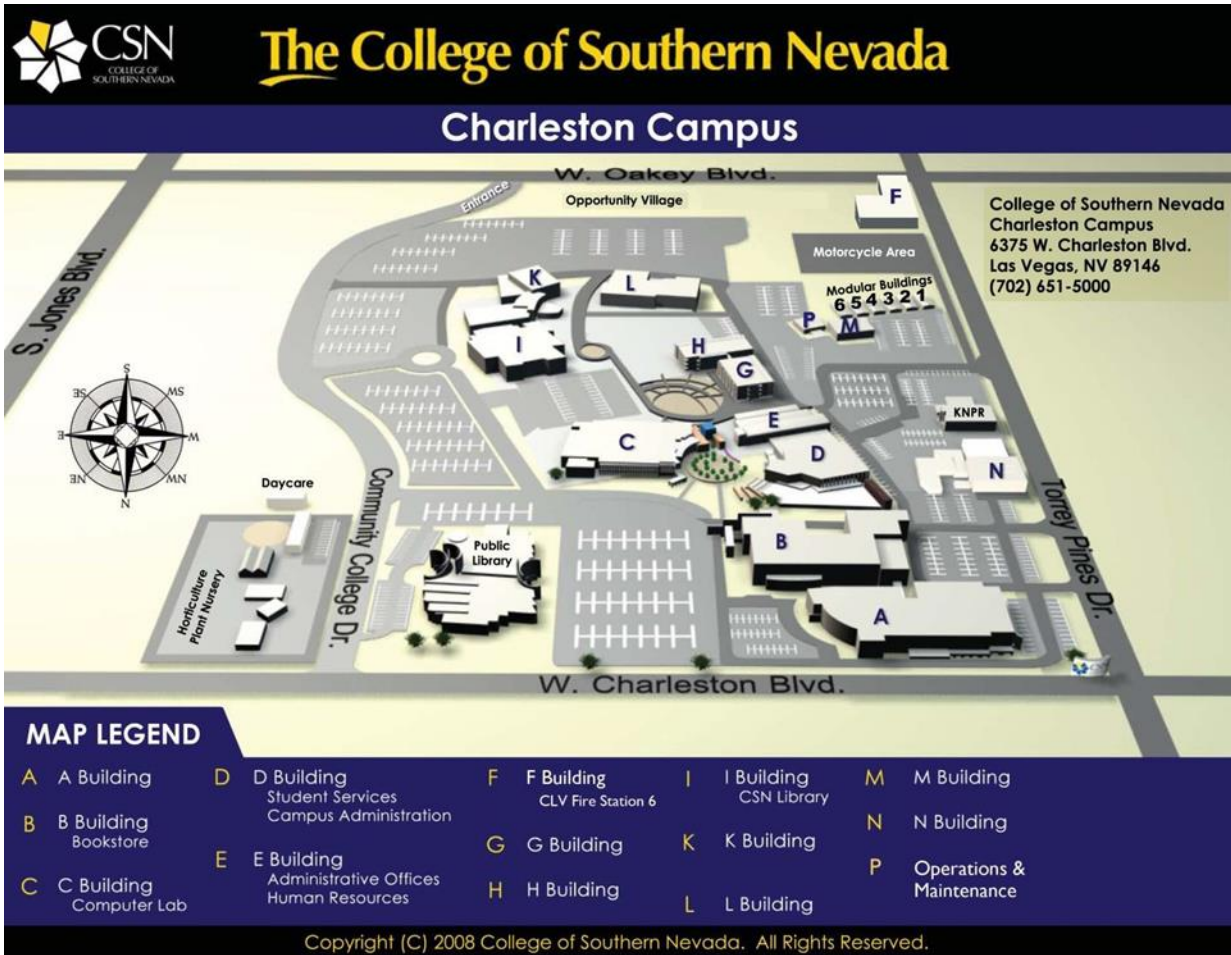

Clinic Map

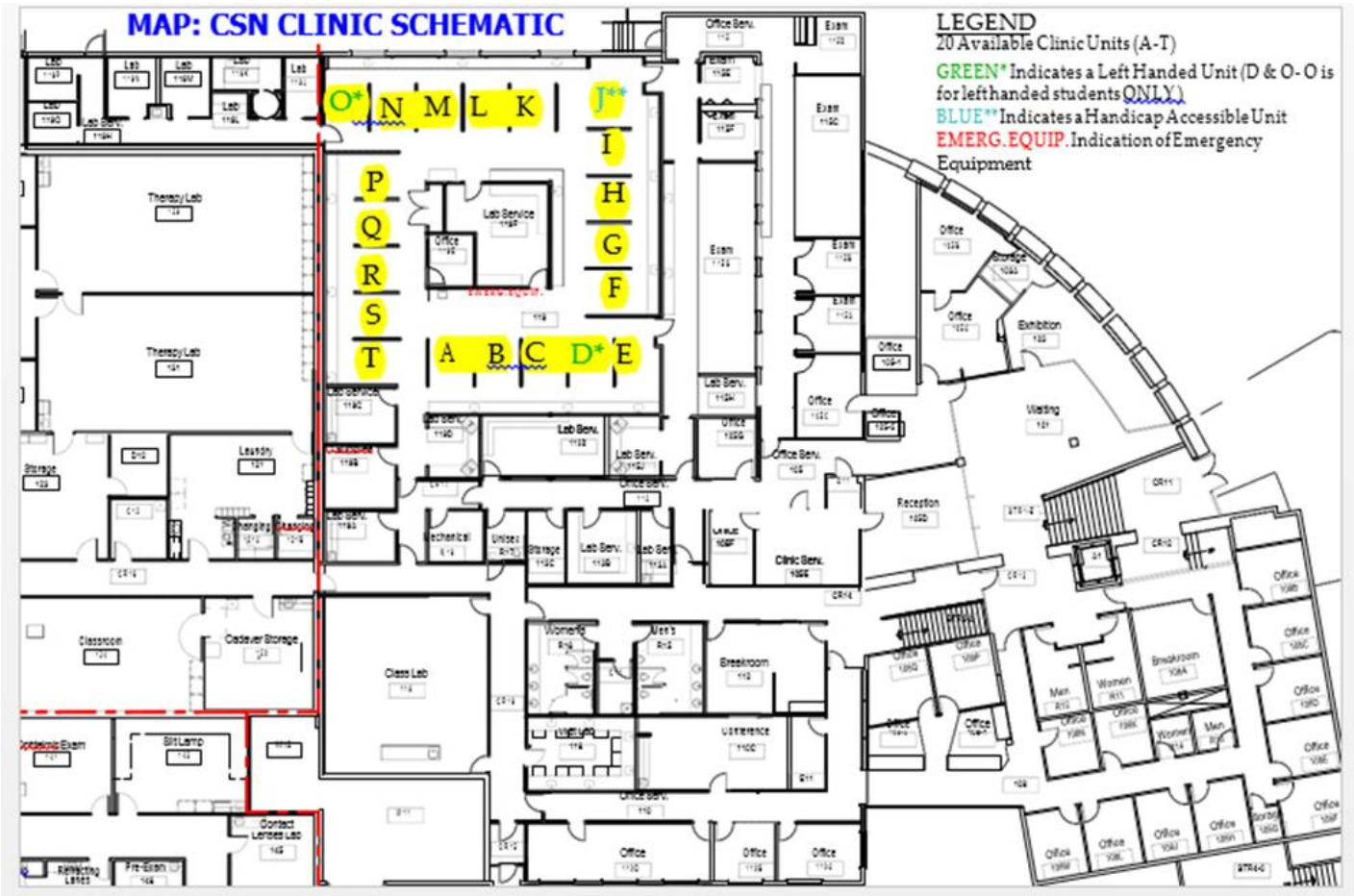

Expendable Dental Materials Appendices

| APPENDIX A – Expendable Dental Hygiene Materials List Provided by Exam Site Host (School) To be provided in sufficient quantities for all Dental Hygiene Candidates | | |
|--|-------------------------------|-------------------------------|
| 2x2 gauze squares | Cotton-tip applicators | Paper towels |
| Air/water syringe tips | Drinking cups | Patient bib clips, disposable |
| Antimicrobial mouthwash | Face masks | Patient napkins/bibs |
| Anesthetic(s) | Facial tissue | Prophy paste |
| • Local anesthetic(s) | Gloves | Sanitizing materials |
| • Topical anesthetic(s) | • Gloves, nonlatex (S,M,L,XL) | Soap |
| Autoclave bags, small | • Overgloves | Standard saliva ejectors |
| Autoclave bags, medium | Headrest covers | Surface disinfectant |
| Autoclave tape | Instrument trays, disposable | Tray covers |
| Barrier covers/tape | Syringe Needles | Trash bags |

| APPENDIX B – Expendable Local Anesthesia Materials List Provided by Exam Site Host (School) To be provided in sufficient quantities for all Local Anesthesia Candidates | | |
|--|-------------------------------|-------------------------------|
| 2x2 gauze squares | Cotton-tip applicators | Paper towels |
| Air/water syringe tips | Drinking cups | Patient bib clips, disposable |
| Antimicrobial mouthwash | Face masks | Patient napkins/bibs |
| Anesthetic(s) | Facial tissue | Sanitizing materials |
| • Local anesthetic(s) | Gloves | Soap |
| • Topical anesthetic(s) | • Gloves, nonlatex (S,M,L,XL) | Standard saliva ejectors |
| Autoclave bags, small | • Overgloves | Surface disinfectant |
| Autoclave bags, medium | Headrest covers | Tray covers |
| Autoclave tape | Instrument trays, disposable | Trash bags |
| Barrier covers/tape | Syringe Needles | |