

# Concorde Career College



Exam Site Information for Candidates  
Western Regional Examining Board (WREB)  
2021 WREB Hygiene Examination

**Concorde Career College**  
930 Carondelet Drive  
Kansas City, MO 64114

## **Concorde Career College – Kansas City WREB Patient and Candidate COVID19 Procedures**

### **Patient Arrival and Screening**

Patient and candidate to present to clinic with a face covering.

DH Staff will have patient and candidate sanitize their hands, take a temperature reading and ask the ADA pre-screening questions of the patient.

Any positive responses from the prescreening or day off screening will be referred to the staff DDS.

Patient will be walked to the clinic for seating by or seated in the waiting room.

Provider will don PPE directly prior to patient seating. All PPE provided by Concorde Career College (candidate may also bring their own) to include disposable gown, shield (accommodates loupes but not light), level 3 mask and gloves.

Turn on extraoral suction (level 2) upon seating the patient to direct aerosols away from the provider.

### **Pre-Treatment**

Student will ask the patient to remove their face covering administer the pre-procedural rinse for one minute and evacuate with saliva ejector.

Extra and intra-oral images can be taken as needed.

### **Treatment**

Candidates may leave their op to get supplies but must wash or disinfect their hands after removing and before replacing gloves.

During treatment, place the extraoral vacuum close the patients head. Use level 2 when hand instrumenting and level 9 when ultrasonic scaling.

### **Releasing Patients**

Patient will be asked to sanitize their hands and don their mask prior to exiting.

**Exam Site Information for Candidates**  
**2021 WREB Dental Hygiene, Local Anesthesia**

**Table of Contents**

**1. School Facility and Services**

- Clinic Address, Building Access and Hours
- Parking
- Security and Emergency Services
- ATM Machine
- Food Services Onsite

**2. Preparing for the Exam**

- Patient Screening
- Radiographs
- Administration of Local Anesthetic – Practitioner Availability
- Dental Operatory Units
- Equipment, Instruments and Expendable Materials
- Sterilization Services

**3. During the Exam**

- Infection Control (Surface Asepsis)
- Medical Emergencies and Equipment

**4. Travel and Lodging Information**

- Airport Information
- Ground Transportation
- Hotel Accommodation

**5. Campus Map**

**6. Clinic Floor Plan**

**7. Required School-provided Expendable Dental Materials Appendices**

## 1. School Facility and Services

- **Location, Building Access and Hours:** Dental hygiene **CLINIC** address, telephone number and contact name for questions regarding the school, equipment, etc. Directions to Clinic entrance; building open 6:00am-6:00pm daily for duration of exam. This will be updated after the move.
- **Location:** 930 Carondelet Drive, Kansas City, MO 64114. Access to DH clinic is through the covered parking garage on the north side of the building, 1<sup>st</sup> floor entrance.
- **Clinic Phone Number:** 816-595-2079
- **Contact for questions regarding testing site :** Alissa Beckerle 816-656-8542
- **Hours:** Building will be open 6:00am-6:00pm
- **Parking:** Parking is available in the garage behind the clinic in designated spots
- **Security and Emergency Services:** 911
- **ATM Machine:** No
- **Food Services Onsite:** St. Joseph Hospital Cafeteria

## 2. Preparing for the Exams

### a. Hygiene Exam

- **Patient Screening:** By appointment only. Please contact the site coordinator.
- **Radiographs:** Digital radiography equipment is available for candidate use during the exam sessions only unless previous arrangements have been made with the site coordinator. There is no charge to utilize the equipment. Two printed copies of radiographs are available at no charge.
- **Administration of Local Anesthetic:** candidates are to administer local anesthesia. No licensed practitioner will be available to administer local anesthetic.
- **Equipment, Instruments and Expendable Dental Materials:** Refer to the respective WREB Candidate Guide for a list of materials and armamentarium that the Candidate must provide.
  - A. Handpiece and Prophy Angle Hookups:** Handpieces are not available to rent. Units accept 2- and 4-hole handpiece and prophy angle hookups.
  - B. Sonic/Ultrasonic Devices:** Each operatory is equipped with an ultrasonic unit that accepts 30K inserts. There are external hookups in each operatory for candidates bringing ultrasonic/piezo units.
  - C. Air/Water Syringe Tips:** Disposable air/water syringes are utilized and provided by the site.
  - D. Blood Pressure Cuffs and Stethoscopes are available on site.**
  - E. Expendable Materials:** Expendable dental materials supplied by the school are noted in *Appendix A*.
- **Sterilization Services:** Sterilization is available during exam sessions.

## 3. During the Clinical Exam

- **Dental Operatory Units:** Adec dental chair, unit and provider stool.
- **Infection Control (Surface Asepsis):** Disinfectant wipes are provided for unit and countertop disinfection. All surfaces, except light lenses are to be wiped.

**A. Hazardous Waste Disposal (exam-type specific):**

- **Hygiene:** Blood/saliva-soaked waste is to be placed in the provided biohazardous waste bags and disposed of in the biohazardous waste receptacle in the sterilization area.
- **Local Anesthesia:** All needles and local anesthetic cartridges are to be disposed of in sharps containers located in each operatory.

**B. Sharps Disposal:** Sharps containers are located in each operatory. All needles and cartridges are to be disposed of in these containers.

- **C. Emergency Medical Equipment:** Oxygen and an emergency supply kit are located on or by the counter in the candidate examination area. Ice packs are located in the clinic supply closet. To place an emergency call from clinic phones dial 911.

**4. Travel and Lodging Information**

- **Airport Information:** Kansas City International Airport
- **Ground Transportation:** Taxi or Uber
- **Hotel Accommodations:** Sonesta Select South, Courtyard by Marriott Kansas City South, Hyatt Place – Overland Park, Kansas

**5. Campus Map:** Attached

**6. Clinic Floor Plan:** Attached

**7. Required School-provided Expendable Dental Materials Appendices**

<b>APPENDIX A – Expendable Dental Hygiene Materials List Provided by Exam Site Host (School) To be provided in sufficient quantities for all Dental Hygiene Candidates</b>		
2x2 gauze squares	Cotton-tip applicators	
Air/water syringe tips	Drinking cups	Patient napkins/bibs
Antimicrobial mouthwash	Face masks	Prophy paste
Anesthetic(s)	Facial tissue	Sanitizing materials
● Local anesthetic(s) with and without vasoconstrictors	Gloves	Soap
● Topical anesthetic(s)	● Gloves, nonlatex (S,M,L,XL)	Standard saliva ejectors
Autoclave bags, small		Surface disinfectant
Autoclave bags, medium	Headrest covers	Syringe Needles (long & short)
Autoclave tape	Instrument trays, disposable	Tray covers
Barrier covers/tape	Paper towels	Trash bags

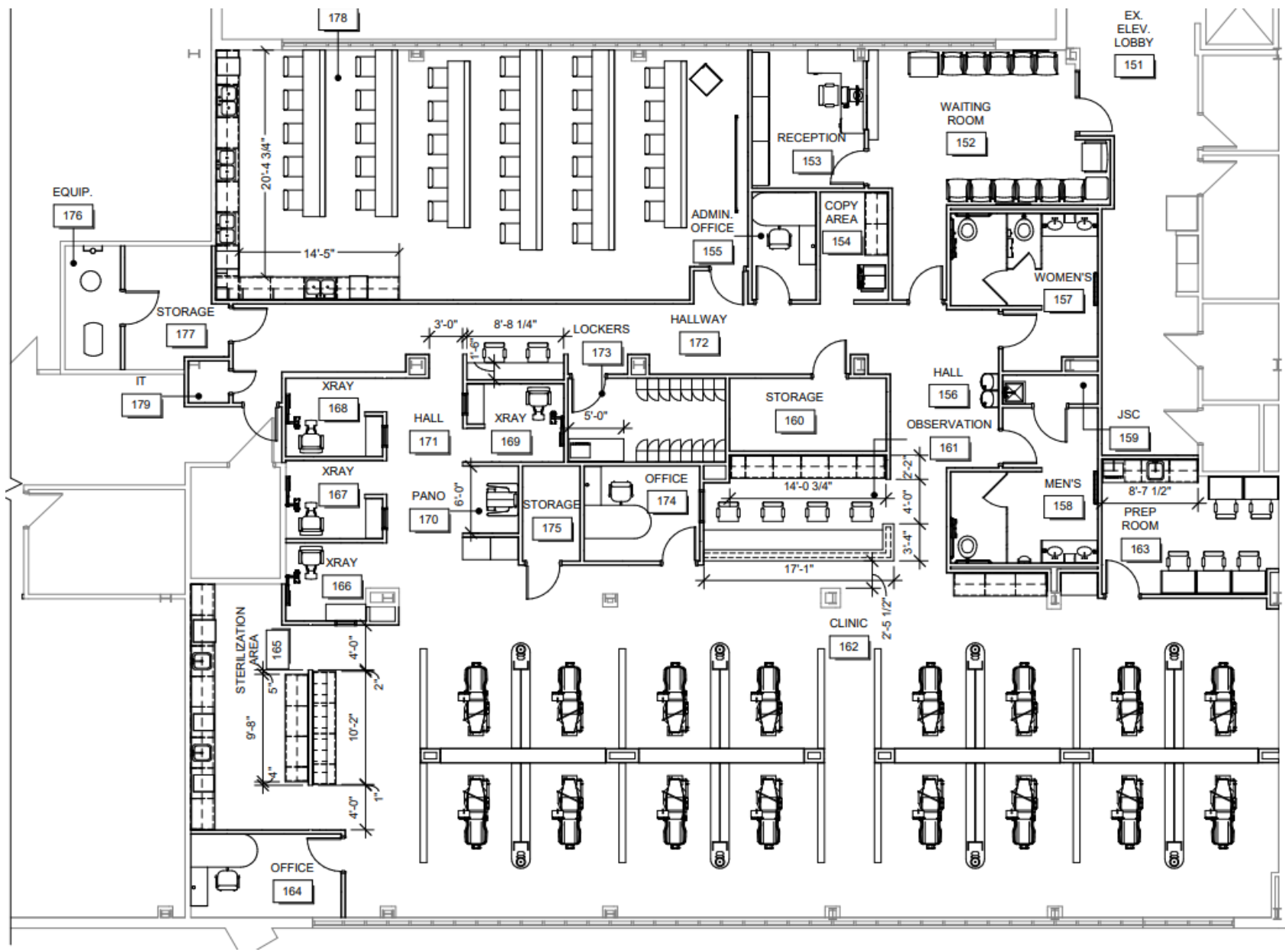



Bus routes are available from the downtown Broadway campus to the St. Joseph hospital campus.

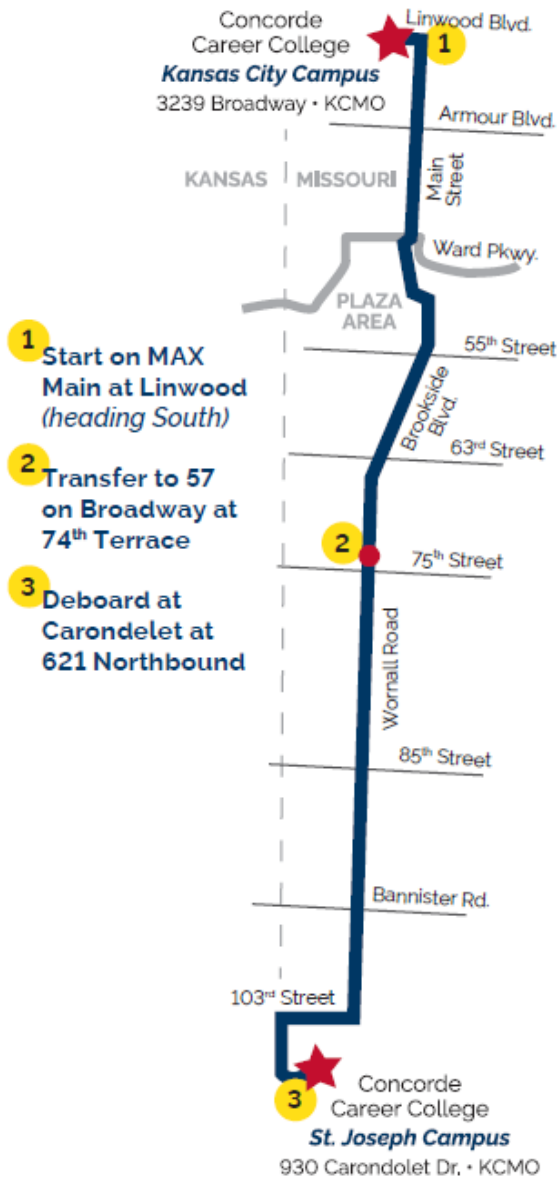

When driving from the downtown Broadway campus to the St. Joseph hospital campus take 71 Highway to Interstate 435.

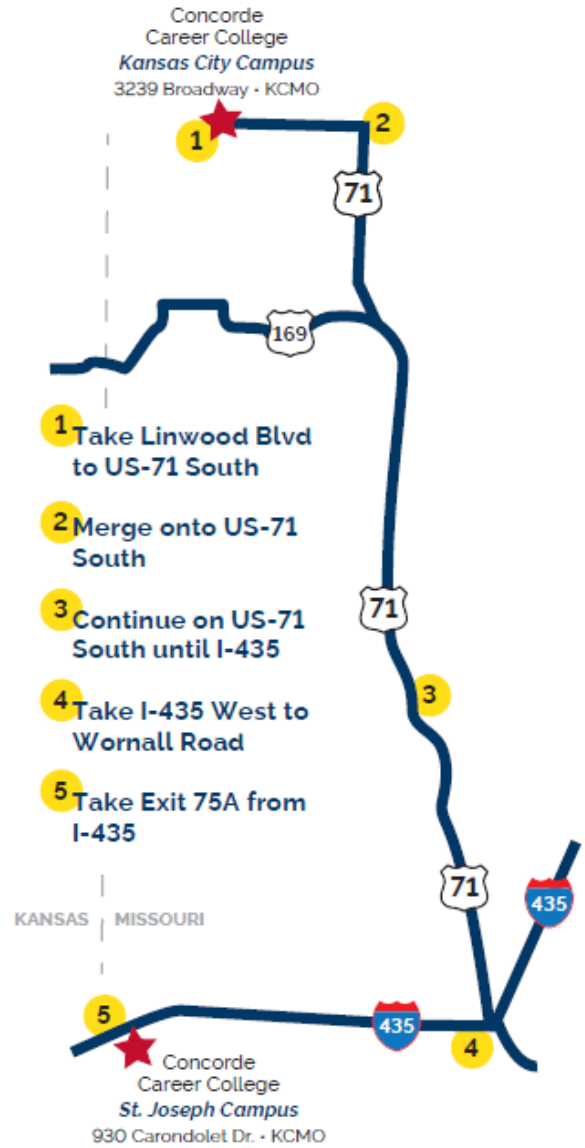



930 Carondelet Drive  
Kansas City, MO 64114

816-531-5223

From Highway 435 take Exit 75B to State Line Road  
or Exit 75A to Wornall Road

Concorde Career College is on the East side  
of the St. Joseph Medical Center Complex

