

**The University of Oklahoma
College of Dentistry**



**Exam Site Information for Candidates
Western Regional Examining Board (WREB)
2020 WREB Hygiene Examination**

**The University of Oklahoma
College of Dentistry
1201 N. Stonewall Avenue – Oklahoma City, OK 73117
405-271-3083**

Exam Site Information for Candidates
2020 WREB Dental Hygiene Examinations

Table of Contents

1. School Facility and Services

- Clinic Address, Building Access and Hours
- Parking
- Security and Emergency Services
- ATM Machine
- Food Services Onsite

2. Preparing for the Exam

- Patient Screening
- Radiographs
- Administration of Local Anesthetic – Practitioner Availability
- Dental Operatory Units
- Equipment, Instruments and Expendable Materials
- Sterilization Services

3. During the Exam

- Infection Control (Surface Asepsis)
- Medical Emergencies and Equipment

4. Travel and Accommodation Information

- Airport Information
- Ground Transportation
- Hotel Accommodation

5. Appendices

- Campus Map
- Clinic Floor Plan
- Expendable Dental Materials Lists

The College of Dentistry is making its facilities available to the Western Regional Examining Board (WREB) as a testing site only. This handout is intended to address questions you may have regarding the facility and its role in the examination.

If you need any additional information or clarification regarding this information, please contact Kim Graziano in the Office of the Director of Clinics at (405) 271-3083 or by e-mail at kim-graziano@ouhsc.edu

Please do not call the school prior to reading the entire Candidate Guide. The school will only answer questions related to the exam site and/or equipment rentals, supplies, etc. Questions regarding the examination itself (content, patient requirements, paperwork/forms, etc.) should be directed to the WREB office or website.

1. School Facility and Services

- **Location, Building Access and Hours:** The address for the College of Dentistry is 1201 N. Stonewall Ave., Oklahoma City, OK 73117. The College of Dentistry is located on the University of Oklahoma Health Sciences Center Campus just east of downtown Oklahoma City.
- **Parking:** Ample parking for candidates and their patients is located directly east, across the street from the school in the Stonewall Parking Garage. The candidate will be assessed a fee without a validated parking ticket on Friday and Monday during the exam. Validation may be obtained at the Information Desk on the first floor. No validation is required for parking on Saturday and Sunday. Handicapped parking in front of the school is available but limited. Additional handicap spaces are available on the first floor of the Stonewall Garage. If candidates have questions regarding parking contact the information desk at (405) 271-7744.
- **ATM Machine:** There is an ATM machine available in the Student Union: which is located on N. Stonewall Ave. less than a block from the College of Dentistry.
- **Security and Emergency Services:** If you see an emergency on campus, dial 911. Other important phone numbers in the event of an emergency:
OU Police Department
405-325-2864
SafeWALK
405-325-9255
Campus Crimestoppers
405-325-STOP (405-325-7867)
- **Food Services Onsite:** The Student Commons on the first floor has food vending machines and a microwave oven available. Many of the hospitals on the Health Sciences Center campus are within walking distance of the College of Dentistry and have cafeterias and takeout facilities.

There are also a number of restaurants on Lincoln Boulevard just north of the State Capitol (about 1-2 miles north of the school). **Bricktown** is also 1-2 miles southwest of the school and has many wonderful restaurants and lots of atmosphere!

Information desk staff will be happy to provide you with additional information about local restaurants and other facilities.

2. Preparing for the Hygiene Exam

- **Patient Screening:** You must provide your own patients. The college will **not** furnish any patients or make any of its clinic records available either for screening or for use during the examination. Furthermore, the college has no external sources from which potential patients can be drawn. You are strongly advised to bring your own patients with you. If you cannot, you will need to explore other alternatives (private practitioners in the area, personal contacts, community shelters, etc.) on your own. **In addition, neither the College of Dentistry nor the Faculty or Staff of the College of Dentistry will assume responsibility for follow-up patient care.**
- **Radiographs:** Radiographic facilities are available in digital format only. You will be responsible for taking your own x-rays. There will be a radiographic technician available to help assist you with equipment set up. If you plan to take any radiographs prior to your examination, there will be a fee assessed. Payments must be **cash only**.

Radiographic Fees	
Periapical/ bitewing- first film	\$ 12.00
Periapical/ bitewing- each additional	\$ 12.00
Bitewing survey – four films	\$ 30.00
Full-mouth survey – 20 films	\$ 65.00
Printing of radiographs/ sheet	\$ 2.00

If **WREB** requires additional films during your examination, there will **not** be a fee assessed.

- **Administration of Local Anesthetic:** The school will, for a fee of \$50.00, provide personnel to administer local anesthesia during the course of the examination. If you have not fulfilled the requirements necessary to administer your own anesthesia, you must either make application to take the WREB anesthesia examination or **make arrangements** for an Oklahoma licensed dentist or dental hygienist to administer it for you. This practitioner must provide WREB a copy of their current Oklahoma license and a current copy of their malpractice insurance. To make arrangements for anesthesia through the school, call Kim Graziano in the office of the Director of Clinics at (405) 271-3083 or email Kim at kim-graziano@ouhsc.edu. All fees must be paid in **cash only**.

- **Equipment, Instruments and Expendable Dental Materials:** Refer to the respective WREB Candidate Guide for a list of materials and armamentarium that the Candidate must provide.

Each clinic operatory is equipped with an A-dec unit, for operator and assistant. The **operator side of the unit** has:

1. Six-hole style handpiece (2 large & 4 small holes) connector on gray tubing. This tubing has coolant water, an electric supply for fiber optic and is used with the **high-speed** handpiece or a sonic scaler (refer to diagram below).
2. Four-hole style hand-piece (2 large & 2 small holes) connector on gray tubing. This tubing has no water and is used with the **slow-speed** handpiece only.
3. Tri-function air/water syringe

The assistant side of the unit has:

1. Tri-function air/water syringe.
2. Two high-volume evacuation hoses.
3. A saliva ejector hose.
4. 1/4" quick-connect water source for ultrasonic scalers is located on the base of the chair (refer to diagram).
5. Two electrical outlets located near the base of the chair.

The ultrasonic scaler connection on the side of the unit and pictures of the connection can be seen below. Additional ultrasonic scalers are not always available, so it is important that you make sure that your equipment will work with the units at this location prior to arriving for the exam.

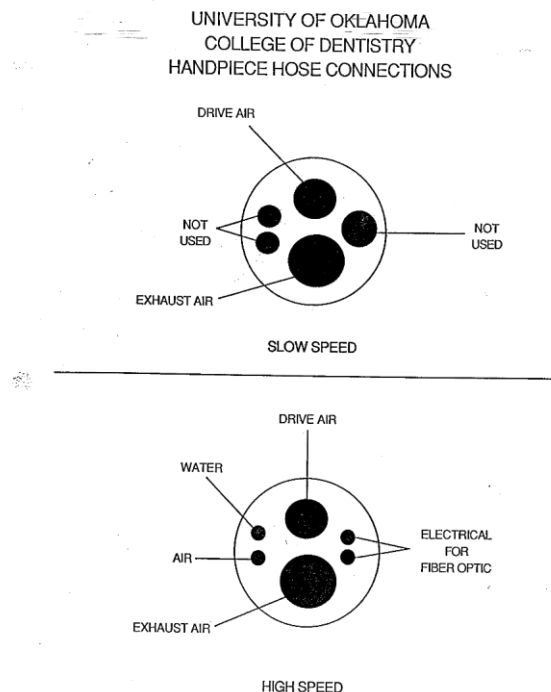

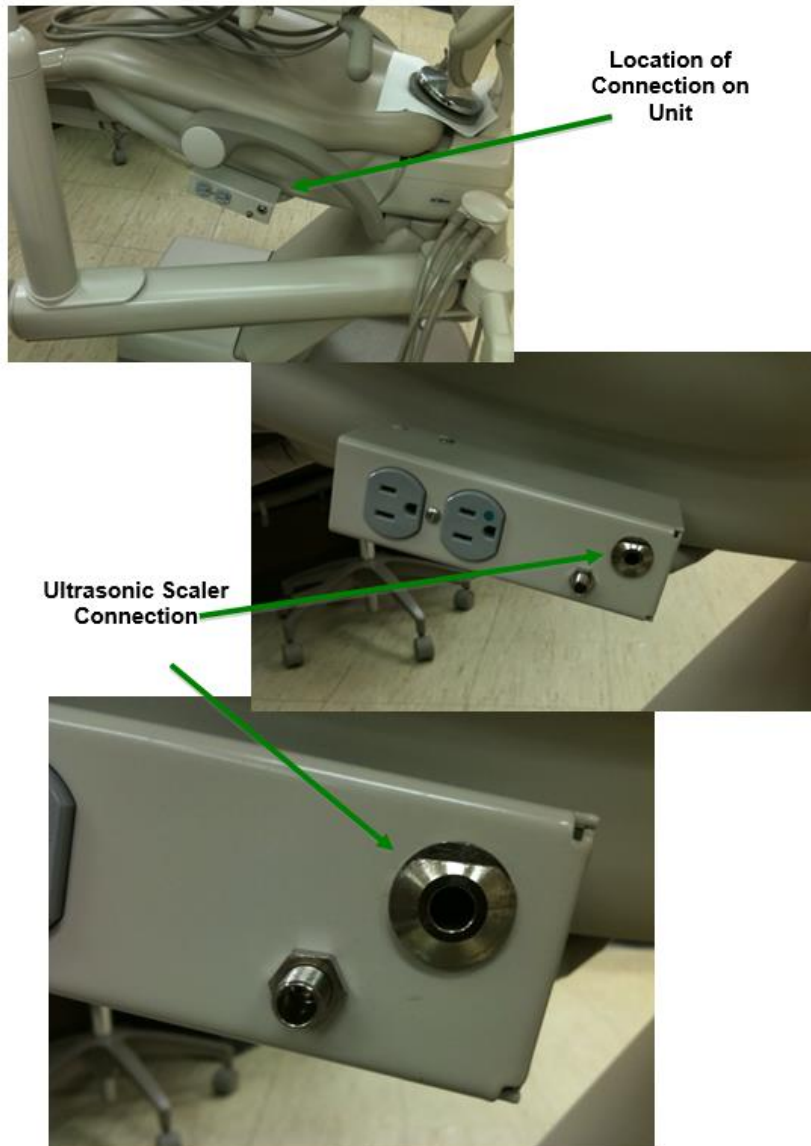

You must furnish your own equipment (hand instruments, hand pieces, anesthetic syringes, ultrasonic scaler, etc.) The College of Dentistry will assume no responsibility for any omissions in your armamentarium

- **Sterilization Services: Central Sterilization Clinic hours of operation during the exam will be 7:00 am to 5:30pm.** The main sterilization facility (Central Sterilization) is located on the second-floor room 264. Sterilization bags will be available at each clinic dispensary and at the Central Sterilization drop-off window. Candidates must clean/bag their instruments and appropriately identify them to ensure their return. **Central Sterilization will not accept any items that have not been appropriately prepared and must include the candidate number for identification.** Candidates must therefore show ID in order to pick up sterilized equipment.

3. During the Clinical Exam

- **Dental Operatory Units:** Each clinic operatory is equipped with an A-dec unit, for operator and assistant.
- **Infection Control (Surface Asepsis):** The College of Dentistry requires the use of standard precautions, which includes gloves, facemasks, protective eyewear, and barrier clothing, i.e. over-gowns during all direct patient contact. Gloves and facemasks and disposable over-gowns are available to each candidate. However, the candidate must provide their own OSHA-acceptable eyewear. Patient protective eyewear will be provided. Red cloth laundry bags may be found in clinic labs areas for disposal of used towels.

Use a modified wipe discard wipe technique for surface disinfection of the clinic operatory carts/stools, light handles, counter tops, etc. Use chair covers, as well as barrier film sheets on light switch, light handles, arms of patient chair, view box switch and unit touchpad. Sleeve barriers will be provided for air/water and suction hoses. Patient, operator and assistant chairs are to be cleaned with Silky Soap as needed. If blood is visible on the chair disinfectant may be used. The following materials and supplies will be available in the clinics for appropriate infection control procedures:

Disinfectant wipes

Chair covers for dental chair

Keyboard covers (if necessary)

Barrier film sheets to cover unit light handles, armrests, view box switch and unit touchpad

Barrier bags for air/water syringe handles and suctions

Disposable over-gowns

Disposable plastic Overgloves

Red plastic bags for disposal of contaminated items

Sharps containers for disposal of needles and anesthetic carpule

Silky Soap for cleaning vinyl chair upholstered areas

Amalgam Scrap containers

Seal Tight Disposable Air/Water syringe tips

- **Hazardous Waste Disposal (exam-type specific):** Place contaminated items (gloves, used gauze, cotton rolls and such disposables as saliva ejectors and evacuation tips) in the white bag attached to the operator cart. At the end of treatment, deposit the bag in the appropriate trash receptacle located in each clinic.
- **Sharps Disposal:** Place all needles, scalpel blades, and other sharps in the red plastic sharps containers located at each dental unit.
- **Emergency Medical Equipment:** For the management of medical emergencies at the College of Dentistry, each clinic is furnished with a medical crash cart stationed on the clinic floor. Positive pressure oxygen and various medical supplies are available in each clinic. Automated External Defibrillators (AEDs) are located in the North hallway on the second, third, and fourth floors. If the candidate is experiencing any type of medical emergency, notify the clinic dispensary staff immediately. Emergency phone numbers are listed near each clinic phone. More detailed instructions on managing medical emergencies will be provided during the school tour.

4. Travel and Accommodation Information

- **Airport Information:** Will Rogers World Airport – 7100 Terminal Drive – Oklahoma City, OK – located about 6 miles Southwest of Downtown.
- **Ground Transportation:**
Oklahoma Shuttle (405) 428-4441
OKC Green Taxi (405) 792-2227
Rental Car Companies:

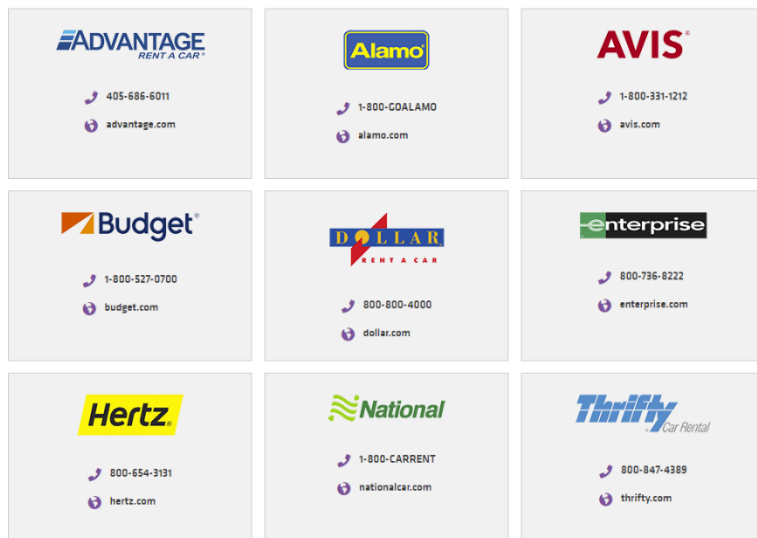

- **Hotel Accommodations:** Some of the hotels that are relatively close (within 5-15 miles) to the school are listed below. Ask about weekly rates and kitchenettes. Consult the Internet or local telephone directory for additional accommodations.

Hotels > 5 miles
Holiday Inn Express (Airport Area)
4400 Highline Blvd
OKC, OK 73108
(405) 948-3366
www.ichotelsgroup.com

Ramada (Airport Area)
2200 S. Meridian Ave.
OKC, OK 73108
(405) 681-9000
www.ramada.com

Residence Inn by Marriot (Airport Area)
4361 W. Reno Ave
OKC, OK 73107
(405) 942-4500
www.marriot.com

Hampton Inn & Suites
300 E Sheridan
OKC, OK 73104
(405) 232-3600
<http://hamptoninn3.hilton.com/>

Hotels < 5 miles
Renaissance OKC Hotel (Downtown/Bricktown Area)
10 N Broadway Ave
OKC, OK 73102
(405) 235-2780
www.marriot.com

Sheraton OKC Hotel (Downtown/Bricktown Area)
1 N Broadway Ave
OKC, OK 73102
<http://www.sheratonokc.com/>

Courtyard by Marriot (Downtown/Bricktown Area)
2 W Reno Ave
OKC, OK 73102
(405) 232-2290
www.marriot.com/okcdt

5. Appendices/Maps:
- Expendable Materials
 - Campus Maps

Expendable Dental Materials Appendices

APPENDIX A – Expendable Dental Hygiene Materials List Provided by Exam Site Host (UOK) To be provided in sufficient quantities for all Dental Hygiene Candidates	
Anesthetic carpules (with and without vasoconstrictors & topical	<u>PPE:</u>
Needles	Gloves (nitrile only)
Cotton-tipped applicators	Over gloves
Cotton rolls & pellets	Finger cots
2x2 & 4x4 gauze	Disposable over gowns
Saliva ejectors/ HVE	Patient safety glasses
Tongue blades	Face masks
Lubricant (Vaseline)	<u>Unit Barriers:</u>
Mouth rinse	Chair covers
Medicine cups/ plastic cups	Barrier film
Pumice/ Prophylaxis paste	Keyboard covers
Floss (waxed & unwaxed)	Barrier sleeves
Patient napkins	Trash bags for unit
Air/Water syringes (Sealtight brand only)	Disinfection wipes
Styrofoam trays for instruments	Silky soap

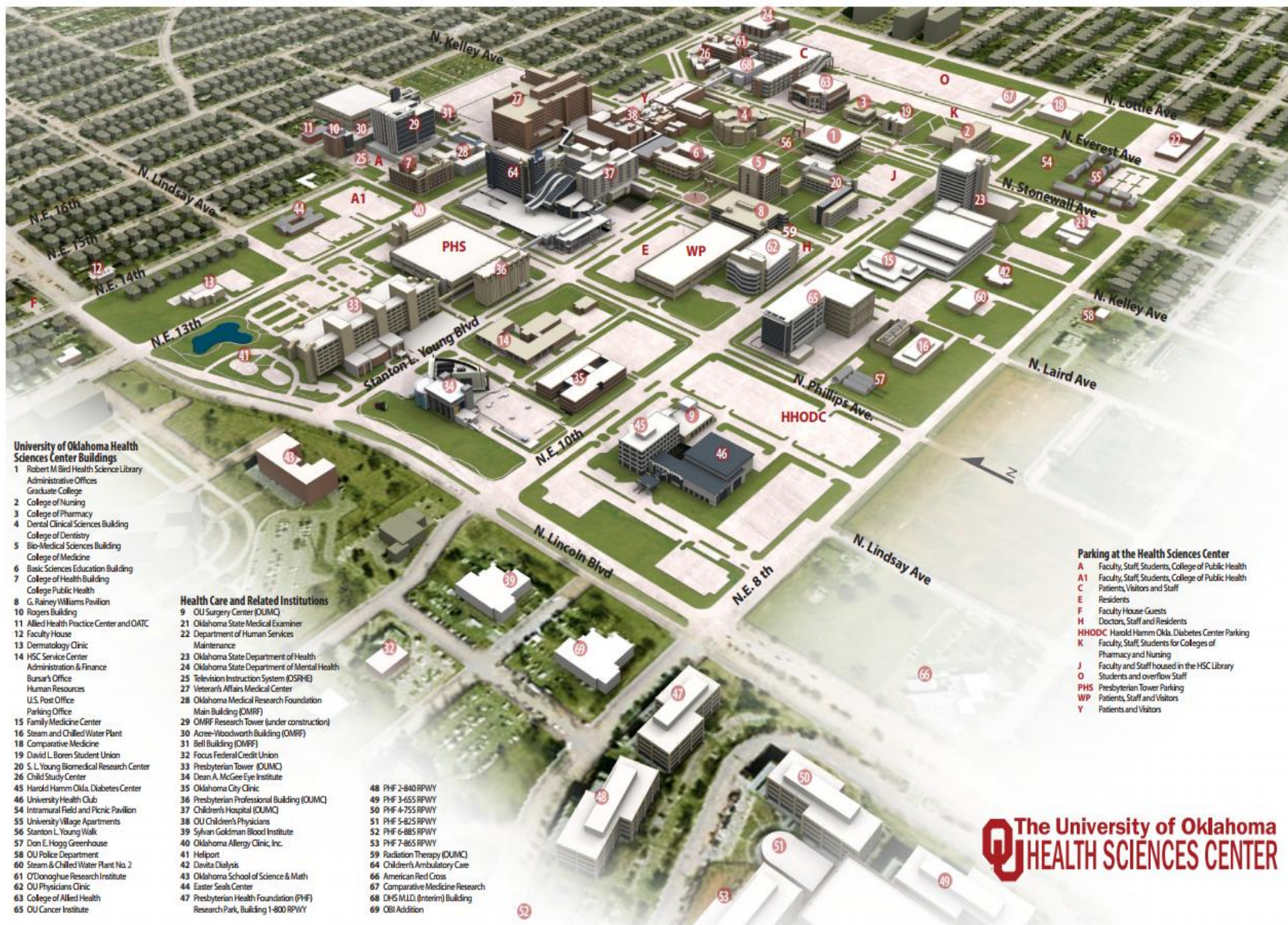

University of Oklahoma Health Sciences Center Buildings

- 1 Robert M Bird Health Science Library
- 2 Administrative Offices
- 3 Graduate College
- 4 College of Nursing
- 5 College of Pharmacy
- 6 Dental Clinical Sciences Building
- 7 College of Dentistry
- 8 Bio-Medical Sciences Building
- 9 College of Medicine
- 10 Basic Sciences Education Building
- 11 College of Health Building
- 12 College Public Health
- 13 G. Rainey Williams Pavilion
- 14 Rogers Building
- 15 Allied Health Practice Center and OATC
- 16 Faculty House
- 17 Dermatology Clinic
- 18 HSC Service Center
- 19 Administration & Finance
- 20 Bursar's Office
- 21 Human Resources
- 22 U.S. Post Office
- 23 Parking Office
- 24 Family Medicine Center
- 25 Steam and Chilled Water Plant
- 26 Comparative Medicine
- 27 David L. Boren Student Union
- 28 S. L. Young Biomedical Research Center
- 29 Child Study Center
- 30 Harold Hamm Okla. Diabetes Center
- 31 University Health Club
- 32 Intramural Field and Picnic Pavilion
- 33 University Village Apartments
- 34 Stanton L. Young Walk
- 35 Don E. Hogg Greenhouse
- 36 OU Police Department
- 37 Steam & Chilled Water Plant No. 2
- 38 O'Donoghue Research Institute
- 39 OU Physicians Clinic
- 40 College of Allied Health
- 41 OU Cancer Institute

Health Care and Related Institutions

- 9 OU Surgery Center (OUMC)
- 21 Oklahoma State Medical Examiner
- 22 Department of Human Services Maintenance
- 23 Oklahoma State Department of Health
- 24 Oklahoma State Department of Mental Health
- 25 Television Instruction System (OSRHE)
- 27 Veteran's Affairs Medical Center
- 28 Oklahoma Medical Research Foundation Main Building (OMRF)
- 29 OMRF Research Tower (under construction)
- 30 Acre-Woodworth Building (OMRF)
- 31 Bell Building (OMRF)
- 32 Focus Federal Credit Union
- 33 Presbyterian Tower (OUMC)
- 34 Dean A. McGee Eye Institute
- 35 Oklahoma City Clinic
- 36 Presbyterian Professional Building (OUMC)
- 37 Children's Hospital (OUMC)
- 38 OU Children's Physicians
- 39 Sylvan Goldman Blood Institute
- 40 Oklahoma Allergy Clinic, Inc.
- 41 Helpport
- 42 Davita Dialysis
- 43 Oklahoma School of Science & Math
- 44 Easter Seals Center
- 47 Presbyterian Health Foundation (PHF) Research Park, Building 1-800 RPWY

- 48 PHF 2-840 RPWY
- 49 PHF 3-655 RPWY
- 50 PHF 4-755 RPWY
- 51 PHF 5-825 RPWY
- 52 PHF 6-885 RPWY
- 53 PHF 7-865 RPWY
- 59 Radiation Therapy (OUMC)
- 64 Children's Ambulatory Care
- 67 American Red Cross
- 68 Comparative Medicine Research
- 68 DNS MLD (Interim) Building
- 69 OBI Addition

Parking at the Health Sciences Center

- A Faculty, Staff, Students, College of Public Health
- A1 Faculty, Staff, Students, College of Public Health
- C Patients, Visitors and Staff
- E Residents
- F Faculty House Guests
- H Doctors, Staff and Residents
- HHODC Harold Hamm Okla. Diabetes Center Parking
- K Faculty, Staff, Students for Colleges of Pharmacy and Nursing
- J Faculty and Staff housed in the HSC Library
- O Students and overflow Staff
- PHS Presbyterian Tower Parking
- WP Patients, Staff and Visitors
- Y Patients and Visitors

The University of Oklahoma
HEALTH SCIENCES CENTER

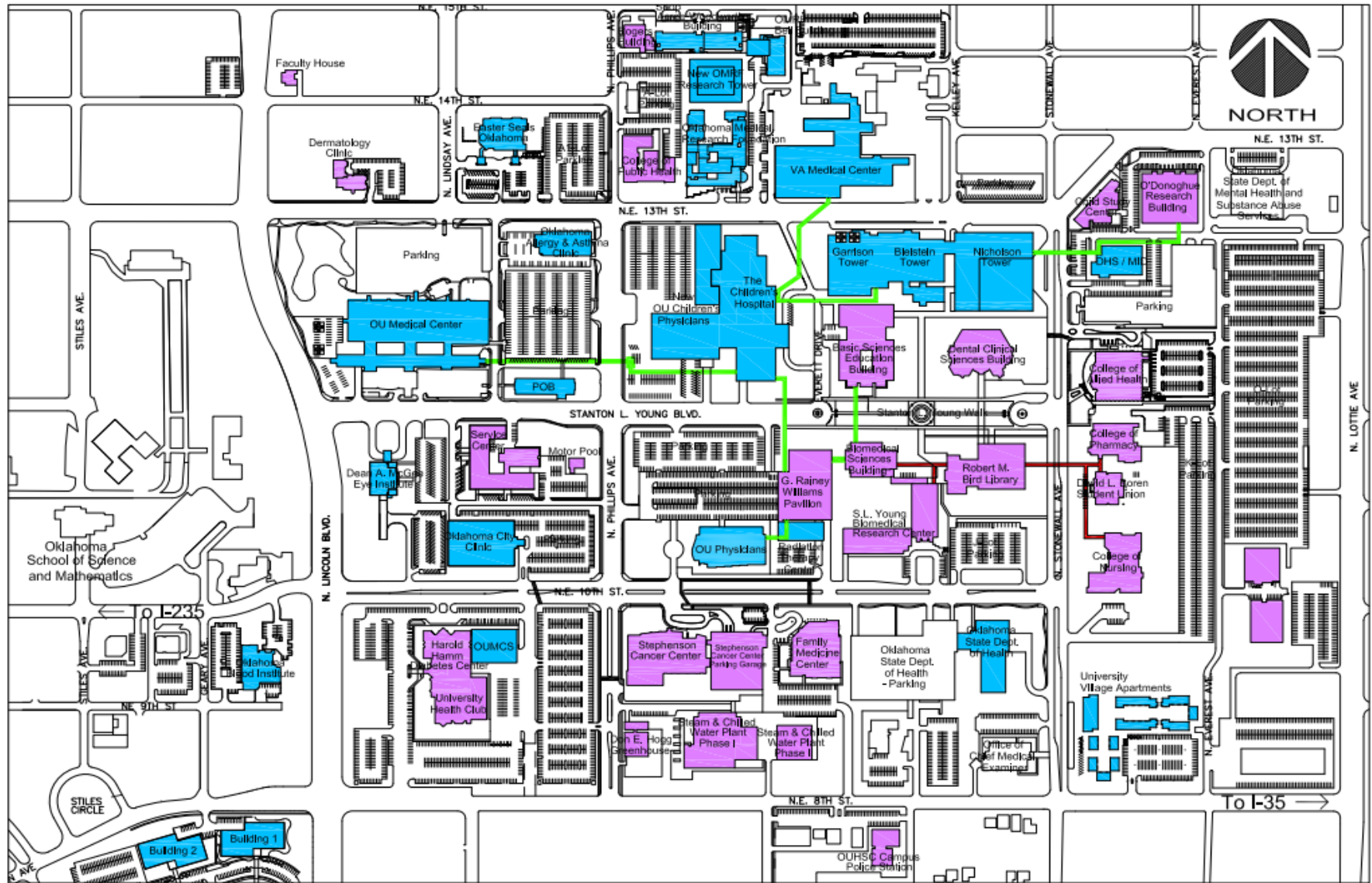

- Pedestrian Overhead Walkway
- Pedestrian Underground Tunnel
- OUHSC Buildings
- Other OHC Buildings
- Parking

October 2012

Map provided by Facilities Management and Capital Planning, OUHSC