

San Joaquin Valley College - Visalia



**Exam Site Information for Candidates
Western Regional Examining Board (WREB)
2019 WREB Hygiene Examination**

**San Joaquin Valley College
Visalia
8344 West Mineral King, Visalia, CA 93291
(559) 651-1617**

Exam Site Information for Candidates
2019 WREB Dental Hygiene, Local Anesthesia & Restorative Examinations

Table of Contents

1. School Facility and Services

- Clinic Address, Building Access and Hours
- Parking
- Security and Emergency Services
- ATM Machine
- Food Services Onsite

2. Preparing for the Exam

- Patient Screening
- Radiographs
- Administration of Local Anesthetic – Practitioner Availability
- Dental Operatory Units
- Equipment, Instruments and Expendable Materials
- Sterilization Services

3. During the Exam

- Infection Control (Surface Asepsis)
- Medical Emergencies and Equipment

4. Travel and Accommodation Information

- Airport Information
- Ground Transportation
- Hotel Accommodation

5. Appendices

- Campus Map
- Clinic Floor Plan
- Expendable Dental Materials Lists

1. School Facility and Services

- **Location, Building Access and Hours:** *San Joaquin Valley College Dental Hygiene Clinic, 8344 West Mineral King Avenue, Visalia, CA 93291; Contact Brenda Serpa @ (559) 651-1617; building open 6:00am-6:00pm daily for duration of exam*
- **Parking:** Free parking in Dental Hygiene clinic parking lot; no permits required
- **Security and Emergency Services:** Dial 911
- **ATM Machine:** Not available on campus
- **Food Services Onsite:** Food services available nearby, but not on campus during exam.

2. Preparing for the Hygiene Exam

- **Patient Screening:** The SJVC Dental Hygiene clinic will not be available for patient screening outside of the candidates' WREB examination schedule.
- **Radiographs:** Digital x-ray equipment is available for radiographic images on the examination dates as needed. See fee schedule.
- **Administration of Local Anesthetic:**
Practitioner(s) from the school is(are) **NOT AVAILABLE** to administer local anesthesia to Candidate Patients. There are no exceptions to this policy.
- **Equipment, Instruments and Expendable Dental Materials:** Refer to the respective WREB Candidate Guide for a list of materials and armamentarium that the Candidate must provide.
 - A. **Handpiece and Propy Angle Hookups:** 4 – hole slow speed handpiece compatible hose/connection.
 - B. **Sonic/Ultrasonic Devices:** DENTSPLY 30K mounted magnetostrictive ultrasonic units; 30K inserts will fit these units. Inserts available for rent, if needed.
 - C. **Air/Water Syringe Tips:** Disposable tips will be available at exam.
 - D. **Blood Pressure Cuffs and Stethoscopes:** Candidates are responsible for bringing their own blood pressure cuffs and stethoscopes.
 - E. **Expendable Materials:** Expendable dental materials supplied by the school are noted in **Appendix A**. Add the expendable list to your document (items not listed are responsibility of Candidate).
- **Sterilization Services:** Sterilization for instruments will only be available for candidates who will be retesting on the Sunday afternoon session. Please note that there is no guarantee that the instruments will be ready for the final session if you are testing Sunday morning. Therefore, candidates must anticipate and plan their needs accordingly. Candidates must clearly print their full name and date on the autoclave bags, available at each unit. Candidates may retrieve their instruments when they are permitted back on

the floor during their Sunday afternoon exam time. **No** sterilization will be available for instruments at the end of the last test session

3. During the Clinical Exam

- **Dental Operatory Units:**

- ADEC dental chair and light
 - All units accommodate right- or left-handed candidates
- DENTSPLY 30K mounted magnetostrictive ultrasonic units
 - 30K inserts will fit these units
- quick connect water source – receives male hose connection
- 4-hole slow speed handpiece compatible hose/connection
- evacuation system – high volume evacuation and saliva ejector
- x-ray view box
- candidate stool
- distilled water

- **Infection Control (Surface Asepsis)** Note that proper PPEs should be worn at all appropriate times (gloves, eyewear, gown and mask). Candidates are expected to wear scrubs during the examination. Heavy gloves should be utilized during disinfection and break down of unit. All candidates are required to adhere to the following infection control steps:

- **Unit Set-Up**

- With Cavi-Wipes surface disinfectant, wipe down:
 - Unit control arm, trays and all hoses
 - Candidate/operator chair upholstery
 - Dental unit light handles and light switch
 - Dental unit counter top
 - Any personal items used (i.e., protective eye wear, bib clips)
- Purge water unit lines for 2 minutes at the beginning of the day
- Plastic bag or sleeve barriers will be on the set-up tray and will be placed on the following:
 - Full chair cover (bag)
 - Light handle (sleeves)
 - Air water syringes, suctions, Cavitron handle (sleeves)
- Place plastic tape (wrap – available at each unit) on the following:
 - Unit arms where contact is anticipated
 - Patient chair arms
 - Levers and switches
 - Unit control panel
 - Candidate chair where contact is anticipated (i.e., control levers)
- Unit counter tops should be considered “clean” for paperwork and additional candidate items

- **A. Hazardous Waste Disposal (exam-type specific):**

- **Hygiene:** Contaminated disposable items are to be placed in the chairside bags and then into the general trash receptacle at each sink.

- **B. Sharps Disposal:** ALL disposable SHARPS must be placed in the SHARPS Container located under each sink.

- **Emergency Medical Equipment:** Oxygen tank and Emergency Drug Kit will be located near the WREB Chief Examiners table in the clinic. In the event of a medical emergency, notify the Chief Examiner immediately. The Site Coordinator will then be informed so that the Emergency Medical Team may be contacted

4. Travel and Accommodation Information

- **Airport Information:** FAT – Fresno Yosemite International Airport
- **Ground Transportation:** List airport shuttle service, public transportation

- **Hotel Accommodations:**

Hotel	Address	Phone	Approximate Cost	Website
Wyndham (formerly Holiday Inn)	9000 W Airport Dr. Visalia, CA	559.651.5000	~ \$130/night	http://www.wyndham.com/hotels/california/visalia/wyndham-visalia/hotel-overview
Comfort Inn & Suites	9300 W Airport Dr. Visalia, CA	559.651.3700	~ \$100/night	https://www.choicehotels.com/california/visalia/comfort-inn-hotels/caa78
La Quinta Inn & Suites	5438 W Cypress Ave Visalia, CA 93277	559.739.8900	~ \$95/night	http://www.laquintavisaliasequoiagateway.com/

5. Maps

- **Campus Map:**



From the South: 99 North; Take Exit 96 to merge onto CA-198 East toward Visalia/Sequoia National Park; take exit 102 for Plaza Drive, turn left (North); turn right on Crowley Avenue; turn right onto N Kelsey Street; SJVC will be on your left. Parking lot may be entered from Hillsdale Ct. or N. Kelsey Street. Enter into the East side of building.

From the North: 99 South; Take Exit 97 to merge onto CA-198 East toward Visalia/Sequoia National Park; take exit 102 for Plaza Drive, turn left (North); turn right on Crowley Avenue; turn right onto N Kelsey Street; SJVC will be on your left. Parking lot may be entered from Hillsdale Ct. or N. Kelsey Street. Enter into the East side of building.

- Clinic Floor Plan:

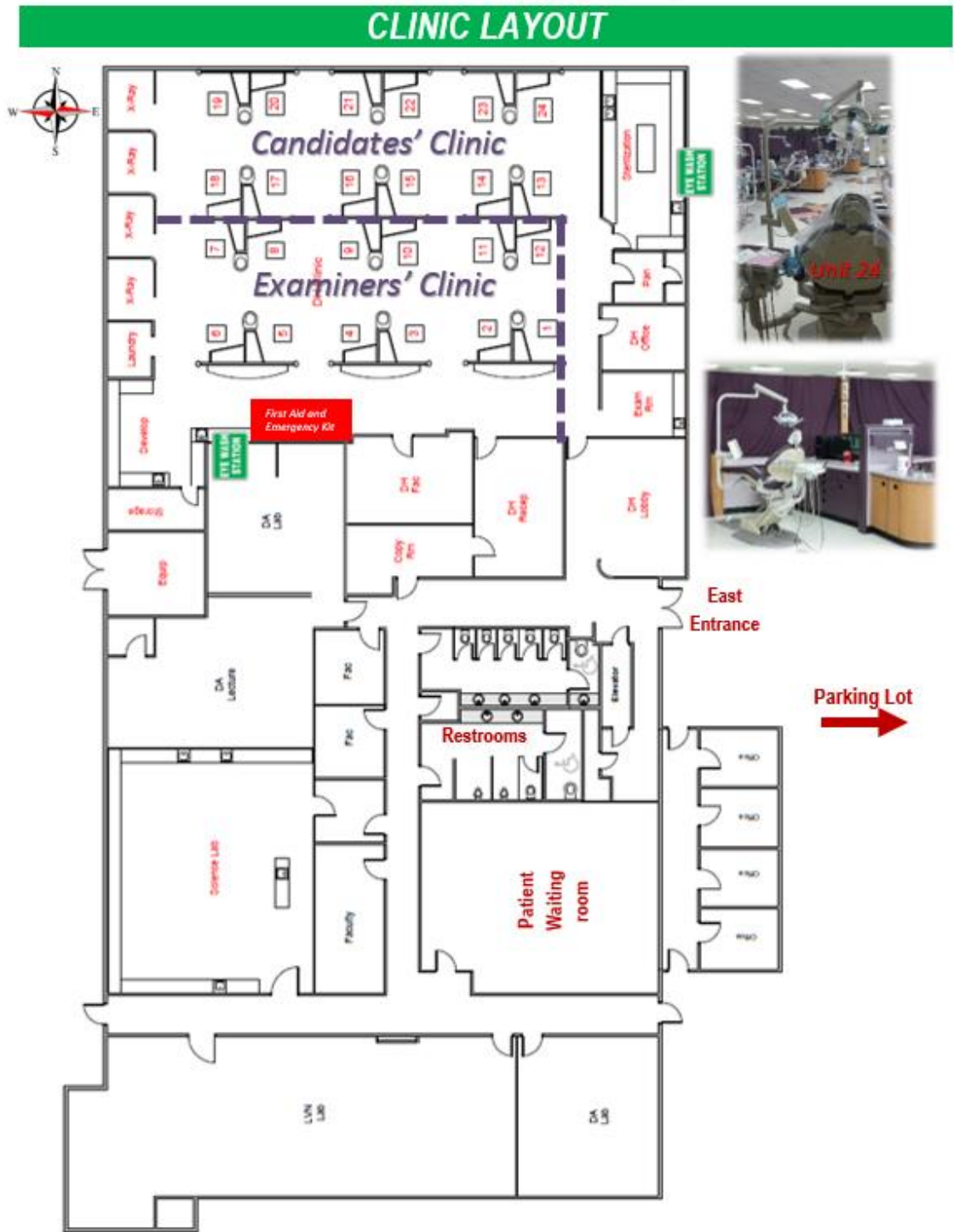

Expendable Dental Materials Appendices

APPENDIX A – Expendable Dental Hygiene Materials List Provided by Exam Site Host (School) To be provided in sufficient quantities for all Dental Hygiene Candidates		
2x2 gauze squares	Cotton-tip applicators	Paper towels
Air/water syringe tips	Drinking cups	Patient bib clips, disposable
Antimicrobial mouthwash	Face masks	Patient napkins/bibs
Anesthetic(s)	Facial tissue	Prophy paste
• Local anesthetic(s)	Gloves	Sanitizing materials
• Topical anesthetic(s)	• Gloves, nonlatex (S, M, L, XL)	Soap
Autoclave bags, small	• Overgloves	Standard saliva ejectors
Autoclave bags, medium	Headrest covers	Surface disinfectant
Autoclave tape	Instrument trays, disposable	Tray covers
Barrier covers/tape	Syringe Needles	Trash bags