

**Idaho State University**

**Idaho State**  
**UNIVERSITY**  
**Department of Dental Hygiene**

**Exam Site Information for Candidates**  
**Western Regional Examining Board (WREB)**  
**2019 WREB Hygiene Examination**

**Idaho State University**  
**Department of Dental Hygiene**  
**CLINIC ADDRESS 999 Martin Luther King Way**  
**(208) 282-3282**

**Exam Site Information for Candidates**  
**2019 WREB Dental Hygiene, Local Anesthesia & Restorative Examinations**

**Table of Contents**

**1. School Facility and Services**

- Clinic Address, Building Access and Hours
- Parking
- Security and Emergency Services
- ATM Machine
- Food Services Onsite

**2. Preparing for the Exam**

- Patient Screening
- Radiographs
- Administration of Local Anesthetic – Practitioner Availability
- Dental Operatory Units
- Equipment, Instruments and Expendable Materials
- Sterilization Services

**3. During the Exam**

- Infection Control (Surface Asepsis)
- Medical Emergencies and Equipment

**4. Travel and Accommodation Information**

- Airport Information
- Ground Transportation
- Hotel Accommodation

**5. Appendices**

- Campus Map
- Clinic Floor Plan
- Expendable Dental Materials Lists

## 1. School Facility and Services

- **Location, Building Access and Hours:** The ISU Dental Hygiene Clinic address is 999 Martin Luther King Jr. Way. The main clinic entrance is located off of Martin Luther King Jr. Way across from 9<sup>th</sup> Avenue (Building #37). The clinic is open each day from 7:30 am to 4:30 pm Monday-Friday and extending through the weekend for the hours of the exam. The clinic telephone number is (208) 282-3282. Colleen Stephenson is the school coordinator and contact for questions regarding the exam site, equipment, etc.
- **Parking:** A limited number of parking spots are available in the parking lot across the street (8<sup>th</sup> Ave.) from the school near the Administration Building at no fee when utilizing the dental hygiene clinic. An information booth located in the parking lot on 8<sup>th</sup> Ave. can provide parking passes for the above area during weekday hours. This booth is located at G5 on the enclosed map. Passes are not needed after 4:00 pm or on weekends or Fridays in the summer months. Parking is available at other areas of campus for a fee that varies based on location- contact the ISU parking office for more information at (208) 282-2625.

**Security and Emergency Services: Phones:** There are multiple phones in the clinic, located in the main hallway by the reception area, in each of the east and west wing dispensaries, in the faculty office on the east wing, and in the reception area.

**Fire Extinguishers:** A fire extinguisher is located next to the main entrance of the clinic. Pull the pin and aim the stream at the base of the fire. A fire alarm is located on the wall in the main hallway by the restrooms. In case of fire, exit the building as soon as possible.

**Eyewash Stations:** Eyewash stations are located in Unit #1 in the east wing and Unit #33 in the west wing. Both patients and clinicians should wear protective eyewear.

**Emergency Oxygen:**

Emergency equipment and portable oxygen tanks are located on each wing of the Dental Hygiene Clinic in the dispensaries. A turnkey is attached to turn on the oxygen unit.

**Emergency Kits:** Emergency kits are located in each of the east and west wing dispensaries.

**Defibrillator:** An AED is located in the main hallway near the restrooms.

**Exits:** There are four clearly marked emergency exits (see map).

***Emergency protocol and location of equipment will be shown and discussed during the clinic tour.***

Reference numbers for security, emergency, and medical needs:

|  |                |
|--|----------------|
| <b>Pocatello Ambulance, Fire, and Police</b> | 911            |
| <b>Portneuf Medical Center</b>               | (208) 239-1000 |

- **ATM Machine:** An ATM is located in the Rendezvous Building adjacent to the Dental Hygiene Clinic inside the doors located on the west entrance with an additional ATM located in the Pond Student Union Building.

- **Food Services Onsite:** Pond Student Union Building (PSUB) on campus has several food options available. Subway & TCBY, Taco Bell, McDonald's, 5<sup>th</sup> Street Bagelry, Pizza Hut, Goody's Deli, Elmer's Pancake & Steakhouse, and Jimmy John's are located on 5<sup>th</sup> Ave. across from campus.

## 2. Preparing for the Hygiene Exam

- **Patient Screening:** The Dental Hygiene Clinic will be open Monday, June 3 and Tuesday, June 4 from 8:00-11:30 am and 1:00-3:00 pm. Candidates may screen patients on those days during the specified times. Please contact Colleen Stephenson (208) 406-6645 if you have any questions or concerns.
- **Radiographs:** The Dental Hygiene Clinic will be open Monday, June 3 and Tuesday, June 4 from 8:00-11:30 and 1:00-3:00 for candidates to expose and print radiographs for their patients. Only digital radiography is available.
- **Administration of Local Anesthetic:**  
Practitioner(s) from the school are **NOT AVAILABLE** to administer local anesthesia to candidate patients. There are no exceptions to this policy.
- **Equipment, Instruments and Expendable Dental Materials:** Refer to the respective WREB Candidate Guide for a list of materials and armamentarium that the Candidate must provide.
  - A. Handpiece and Propfy Angle Hookups:** All units are equipped for use of high speed and slow speed handpieces. Candidates must provide their own handpieces. No handpieces will be available for use or rent. **Handpiece hook-ups are 4-hole pattern.** Time will be allotted for all candidates to operate chairs, hook up handpieces, ultrasonic units, etc. during each clinic tour. Candidates are encouraged to ask questions and/or address concerns regarding the WREB examination or the facility at that time.
  - B. Sonic/Ultrasonic Devices:** A limited number of magnetostrictive ultrasonic units are available for rent for the examination. Cost is \$100 for the unit plus a \$100 deposit (Cash ONLY). The deposit is refundable provided the equipment is returned in the same condition as it was rented. A limited number of ultrasonic inserts are also available to rent for an additional \$100. Due to the limited number of units available for rent, candidates are encouraged to bring their own sonic/ultrasonic devices and corresponding inserts. Each operatory has a quick disconnect water hookup and electrical outlet. There are no hookups for air polishing devices. If you have another device, please contact the ISU Dental Hygiene Department at (208) 282-3282 to determine if it is compatible with these hookups.
  - C. Air/Water Syringe Tips:** Candidates are expected to provide their own instruments. Disposable trays, bib clips, saliva ejectors, and air/water syringe tips will be provided to candidates as needed.

**D. Blood Pressure Cuffs and Stethoscopes:** A limited number of blood pressure cuffs and stethoscopes are available for Candidate use.

**E. Expendable Materials:** Expendable dental materials supplied by the school are noted in **Appendix A**. Add the expendable list to your document (items not listed are the responsibility of the Candidate).

- **Sterilization Services:** Candidates should arrive with all items previously sterilized. After each clinical exam, items for sterilization should be taken to the “non-sterile” bin located in the reception area near the fireplace. Candidates should ensure all instruments are properly bagged and labeled prior to sterilization. Sterilized instruments may be picked up at the “sterile” bin, also located in the reception area, by 3:00 p.m. each weekday and 4:00 p.m. on the Saturday and Sunday of the examinations. All items submitted to be sterilized must be picked up within 5 days of the close of the examination. **Idaho State University is not responsible for lost, stolen, or damaged instruments.**

### 3. Preparing for the Local Anesthesia Exam

- **Equipment, Instruments and Expendable Dental Materials:** Refer to the respective WREB Candidate Guide for a list of materials and armamentarium that the Candidate must provide.

**A. Air/Water Syringe Tips:** Candidates are expected to provide their own instruments. Disposable trays, bib clips, saliva ejectors, and air/water syringe tips will be provided to candidates as needed.

**B. Expendable Materials:** Expendable dental materials supplied by the school are noted in **Appendix B**. Items not listed are the responsibility of the Candidate.

- **Sterilization Services:** Candidates should arrive with all items previously sterilized. After each clinical exam, items for sterilization should be taken to the “non-sterile” bin located in the reception area near the fireplace. Candidates should ensure that all instruments are properly bagged and labeled with their Candidate ID # prior to sterilization. Sterilized instruments may be picked up at the “sterile” bin, also located in the reception area, by 3:00 p.m. each weekday of the examination. All items submitted to be sterilized must be picked up within 5 days of the close of the examination. **Idaho State University is not responsible for lost, stolen, or damaged instruments.**

### 4. Preparing for the Restorative Exam

- **Equipment, Instruments and Expendable Dental Materials:** Refer to the respective WREB Candidate Guide for a list of materials and armamentarium that the Candidate must provide.

**A. Handpiece and Prophy Angle Hookups:** All units are equipped for use of high speed and slow speed handpieces. Candidates must provide their own

handpieces. No handpieces will be available for use or rent. **Handpiece hook-ups are 4-hole pattern.** Time will be allotted for all candidates to operate chairs, hook up handpieces, ultrasonic units, etc. during each clinic tour. Candidates are encouraged to ask questions and/or address concerns regarding the WREB examination or the facility at that time.

**B. Air/Water Syringe Tips:** Candidates are expected to provide their own instruments. Disposable trays, bib clips, saliva ejectors, and air/water syringe tips will be provided to candidates as needed.

**C. Curing Lights:** Curing lights and disposable shields are provided by the school for each operatory. Candidates may use the curing lights provided or are welcome to bring their own.

**D. Expendable Materials:** Expendable dental materials supplied by the school are noted in **Appendix C**. Items not listed are responsibility of the Candidate.

## 5. During the Clinical Exam

- **Dental Operatory Units:** The clinic is equipped with Adec chairs and delivery system in each operatory.

**Infection Control (Surface Asepsis):** Candidates are responsible for providing their own labcoat or disposable gown and protective eyewear for themselves and their patient(s). Masks, exam gloves, and plastic overgloves are provided. Candidates must provide their own utility gloves for handling and packaging contaminated instruments.

- **Unit Set-up**

*A demonstration will be given during each clinic tour.*

- 1) Obtain protective barrier materials from the central supply area.
- 2) Put on overgloves and surface disinfect all areas which may be touched during patient treatment. Bottles of disinfectant are provided in each unit. Disinfect bracket table and tray, tri-syringe handle, saliva ejector, high speed suction, dental chair and chair controls, mobile cabinet, top and drawer pulls, sink, sink handles and counter top by applying disinfectant to the surfaces and wiping with 4x4 gauze square(s). Apply the disinfectant to the gauze and use to wipe light switch and light handles.
- 3) Cover each of the following with protective barriers: bracket table and tray (plastic bag), light switch and handles (barrier tape), tri-syringe handle (plastic bag), saliva ejector adapter (plastic bag), high speed suction adapters (plastic bags), dental chair, headrest and control (plastic bag).
- 4) Run water through tri-syringe for 30 seconds.

The candidate must remove examination gloves and wash hands before:

- Obtaining any additional equipment
- Going to the supply cart

**After Patient Treatment**

- 1) After patient treatment, non-biohazardous waste is placed in the white waste receptacle at the end of the clinic wing.
- 2) Put on gloves and apply disinfectant to all surfaces with 4x4 gauze square(s). Use enough disinfectant to allow surfaces to remain moist for 10 minutes.
- 3) Flush water and evacuation lines for 30 seconds.

**A. Hazardous Waste Disposal (exam-type specific):**

- o **Hygiene:** Blood-saturated items are placed in the red biohazard waste receptacle located at the end of the clinic wing.
- o **Local Anesthesia:** Blood-saturated items are placed in the red biohazard waste receptacle located at the end of the clinic wing.
- o **Restorative:** Amalgam scrap from squeeze cloths and plastic bags should be disposed of in glass jars located adjacent to each triturator.

**B. Sharps Disposal:** Sharps containers are conveniently located on the countertops throughout the examination area. Used anesthetic cartridges/carpules and needles should be disposed of in the sharps container.

- **Emergency Medical Equipment:** Emergency equipment and portable oxygen tanks are located on each wing of the Dental Hygiene Clinic in the dispensaries. An AED is located in the front hallway near the restrooms. There are four clearly marked emergency exits (see map). First Aid kits are located in each dispensary and ice packs are available on the supply carts. **Emergency protocol and location of equipment will be shown and discussed during the clinic tour.**

Reference numbers for medical needs are as follows:

|  |                |
|--|----------------|
| <b>Pocatello Ambulance, Fire, and Police</b> | 911            |
| <b>Portneuf Medical Center</b>               | (208) 239-1000 |
| <b>Campus Security</b>                       | (208) 282-2515 |

**6. Travel and Accommodation Information**

- **Airport Information:** The Pocatello Airport (PIH) is the closest airport that serves the area. There are two other airports within a 160-mile radius (SLC, IDA).
- **Ground Transportation:**
  - a. Checker Cab (208) 200-8814
  - b. Yellow Cab (208) 237-8294
  - c. Sam’s Taxi Cab Services (208) 904-0420
  - d. A limited number of Uber and Lyft drivers operate in the area
  - e. The Salt Lake Express is a shuttle service from SLC to Pocatello and Idaho Falls.
- **Hotel Accommodations:**

|   |   |   |
|---|---|---|
| <b>Clarion Inn</b><br>1399 Bench Road<br>(208) 237-1400 | <b>TownPlace Suites</b><br>2376 Via Caporatti Drive<br>(208) 478-7000 | <b>Comfort Inn</b><br>1333 Bench Road<br>(208) 237-8155 |
|---|---|---|

|   |  |  |
|---|--|--|
| <p><i>(Mention ISU for special room rate)</i></p> <p><b>Hampton Inn And Suites</b><br/>151 Vista Drive<br/>(208) 233-8200</p> | <p><b>Best Western Cottontree Inn</b><br/>1415 Bench Rd.<br/>(800) 528-1234</p> <p><b>Red Lion Hotel</b><br/>1555 Pocatello Creek Rd.<br/>(208) 233-2200</p> | <p><b>Rodeway Inn</b><br/>835 S. 5<sup>th</sup> Ave.<br/>(208) 233-0451<br/><i>(Across from campus)</i></p> <p><b>Holiday Inn Express</b><br/>200 Via Venitio<br/>(877) 859-5095</p> |
|---|--|--|

**7. Maps**

- **Campus Map:** For a printable map of Idaho State University, please use the following link: <http://www.isu.edu/media/top-level/maps/printableISUmap.pdf>
- **Clinic Floor Plan:** See attached



## Expendable Dental Materials Appendices

| <b>APPENDIX A – Expendable Dental Hygiene Materials List<br/>Provided by Exam Site Host (School)<br/>To be provided in sufficient quantities for all Dental Hygiene Candidates</b> |                                  |                               |
|--|----------------------------------|-------------------------------|
| 2x2 gauze squares  | Cotton-tip applicators           | Paper towels                  |
| Air/water syringe tips   | Drinking cups                    | Patient bib clips, disposable |
| Antimicrobial mouthwash  | Face masks                       | Patient napkins/bibs          |
| Anesthetic(s)  | Facial tissue                    | Prophy paste                  |
| • Local anesthetic(s)  | Gloves                           | Sanitizing materials          |
| • Topical anesthetic(s)  | • Gloves, nonlatex (S, M, L, XL) | Soap                          |
| Autoclave bags, small  | • Overgloves                     | Standard saliva ejectors      |
| Autoclave bags, medium   | Headrest covers                  | Surface disinfectant          |
| Autoclave tape   | Instrument trays, disposable     | Tray covers                   |
| Barrier covers/tape  | Syringe Needles                  | Trash bags                    |

| <b>APPENDIX B – Expendable Local Anesthesia Materials List<br/>Provided by Exam Site Host (School)<br/>To be provided in sufficient quantities for all Local Anesthesia Candidates</b> |                                  |                               |
|--|----------------------------------|-------------------------------|
| 2x2 gauze squares  | Cotton-tip applicators           | Paper towels                  |
| Air/water syringe tips   | Drinking cups                    | Patient bib clips, disposable |
| Antimicrobial mouthwash  | Face masks                       | Patient napkins/bibs          |
| Anesthetic(s)  | Facial tissue                    | Sanitizing materials          |
| • Local anesthetic(s)  | Gloves                           | Soap                          |
| • Topical anesthetic(s)  | • Gloves, nonlatex (S, M, L, XL) | Standard saliva ejectors      |
| Autoclave bags, small  | • Overgloves                     | Surface disinfectant          |
| Autoclave bags, medium   | Headrest covers                  | Tray covers                   |
| Autoclave tape   | Instrument trays, disposable     | Trash bags                    |
| Barrier covers/tape  | Syringe Needles                  |                               |

| <b>APPENDIX C – Expendable Restorative Materials List<br/>Provided by Exam Site Host (School)<br/>To be provided in sufficient quantities for all Restorative Candidates</b> |                                  |                               |
|--|----------------------------------|-------------------------------|
| 2x2 gauze squares  | Face masks                       | Rod posts (mounting Typodont) |
| Air syringe tips   | Gloves                           | Soap                          |
| Amalgamator/Triturator   | • Gloves, nonlatex (S, M, L, XL) | Surface disinfectant          |
| Amalgam scrap container(s)   | Instrument trays, disposable     | Tray covers                   |
| Barrier covers/tape  | Paper towels                     | Trash bags                    |
| Cotton-tip applicators   | Sanitizing materials             |                               |

# ISU Dental Hygiene Clinic

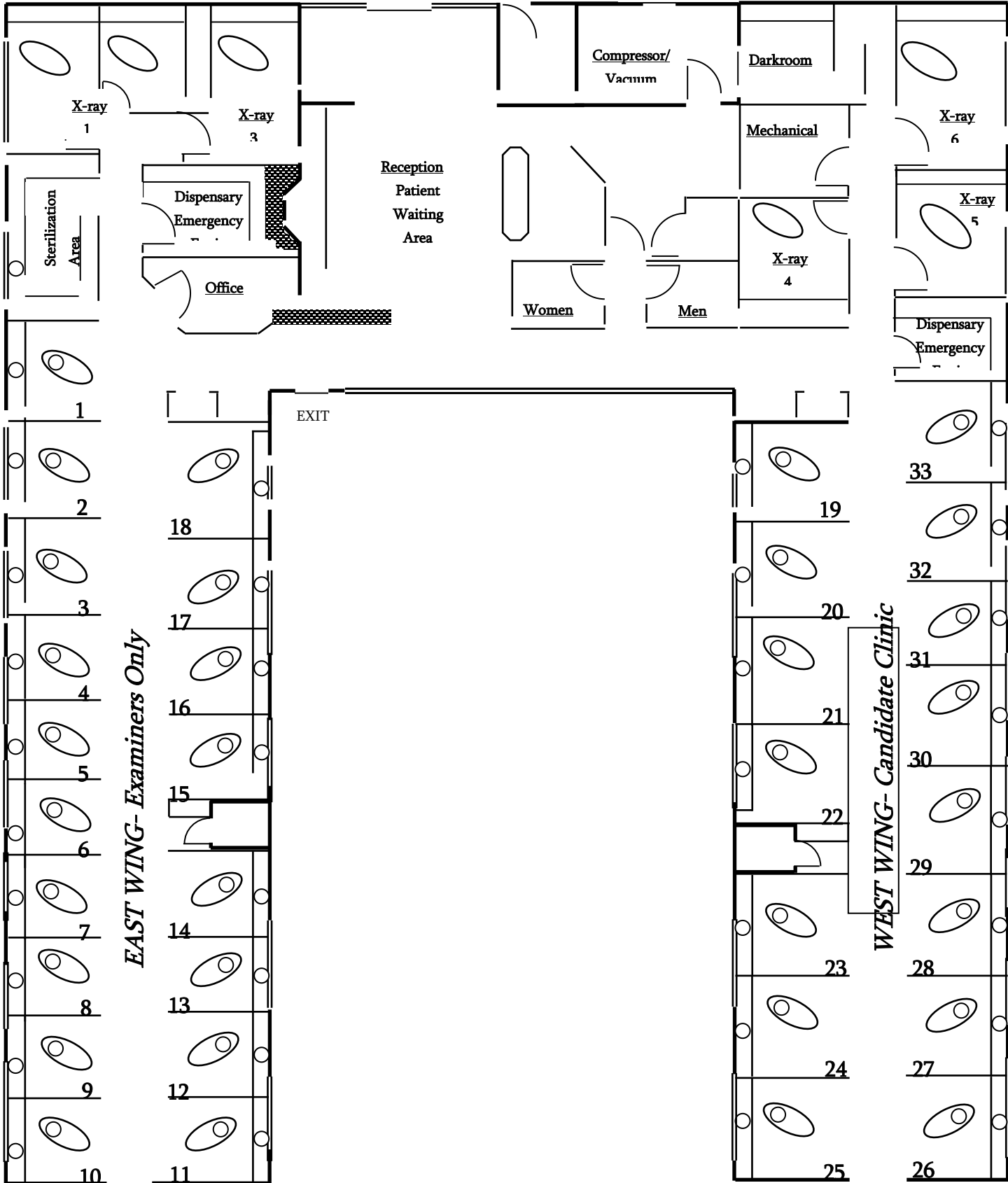

# ISU Dental Hygiene Sciences Building

